

# W1131-1 Pro Clima Skillion Eave - Vented Soffit

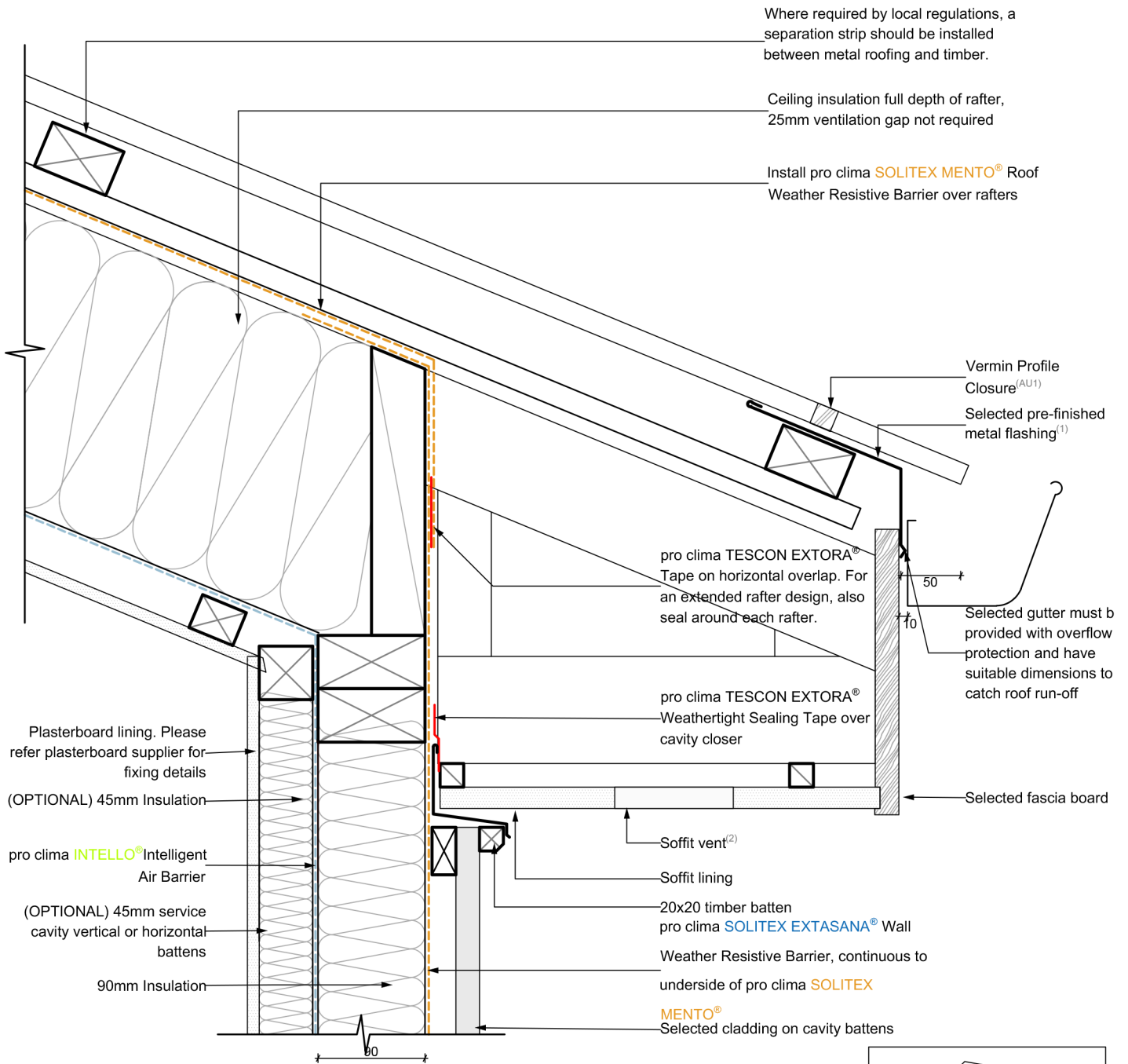

**NOTES:**

- 1: Additional ventilation can be achieved to increase the purge rate of heat in summer by utilising a perforated flashing at the eave.
- 2: For normal ventilation eaves soffit vents with an aggregated free opening area equal to 200cm<sup>2</sup> per linear metre of eave shall be distributed evenly around eaves and used in combination with 20mm high counter battens.
- For strong ventilation eave soffit vents with an aggregated free opening area equal to 400cm<sup>2</sup> per linear metre of eave shall be distributed evenly around eaves and used in combination with 45mm high counter battens.

**AUSTRALIA ONLY:**

- 1: Vents/Cavity closers must meet AS 3959 requirements for bushfire protection up to BAL 40. This can be achieved by fitting an ember guard made of non-combustible material or a mesh or perforated sheet with ≤ 2 mm holes and made of corrosion-resistant steel or bronze.

**NOTE: Minimum 10° Pitch without rigid sheathing board**



Title: Skillion Eave - Vented Soffit

ID: W1131-1 Issued: 01/07/2021 Revision: E