

Rusticated Weatherboard - Direct Fixed on Flexible Underlay

Drawing	Sheet Name	Date
Typical Details		
RKR-D-00	Index V1	20.11.2014
RKR-SETOUT	Weatherboard Setout	20.11.2014
RKMOULD	RK Corner Profiles	20.11.2014
RKNAIL	RK Nails	20.11.2014
RKFLG	Flashing Details	20.11.2014
Window Details		
RKR-D-01	Aluminium Head Detail	20.11.2014
RKR-D-02	Aluminium Jamb Detail	20.11.2014
RKR-D-03	Aluminium Sill Detail	20.11.2014
Internal Corner Details		
RKR-D-11	Internal Corner RK41 Detail - Option 1	20.11.2014
RKR-D-12	Internal Corner RK98 Detail - Option 2	20.11.2014
External Corner Details		
RKR-D-21	External Corner RK42 Detail - Option 1	20.11.2014
RKR-D-22	External Corner Detail - Option 2	20.11.2014
RKR-D-23	External Corner RK97 Detail - Option 3	20.11.2014
RKR-D-24	External Corner RK93 Detail - Option 4	20.11.2014
Vertical Details		
RKR-D-41	Bottom Plate Detail	20.11.2014
RKR-D-42	Top Plate to Soffit Detail	20.11.2014
RKR-D-43	Barge Detail	20.11.2014
RKR-D-44	Soffit Detail	20.11.2014
RKR-D-45	Scarf Joint Detail	20.11.2014
RKR-D-46	Nail Fixing Detail	20.11.2014
RKR-D-47	Nail Fixing Detail	20.11.2014



rusticated



CODEMARK™
CMA-CM40131



**Rosenfeld
Kidson**

www.rosenfeldkidson.co.nz

Auckland Branch:
513 Mt Wellington Highway
Mt Wellington, Auckland 1060
T. +64 9 573 0503
F. +64 9 573 0504

Christchurch Branch:
15 Edmonton Road, Hornby
Christchurch 8042
T. +64 3 349 3316
F. +64 3 349 3317

Postal address: PO Box 621, Shortland Street, Auckland 1140

Title **Index V1**
Drawing **RKR-D-00**
Scale @ A4 Date 20.11.2014

RKA702 Weatherboards

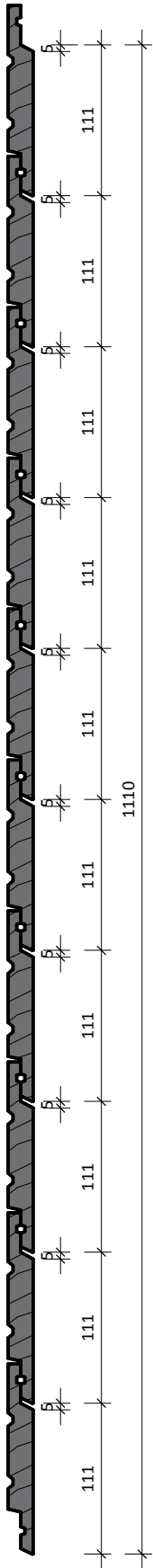

RKA704 Weatherboards

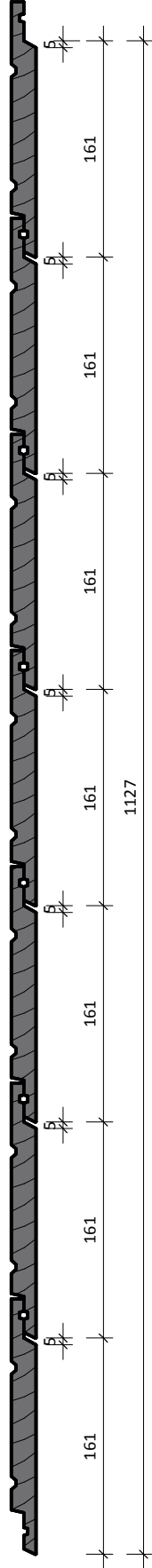

Random Width Weatherboards

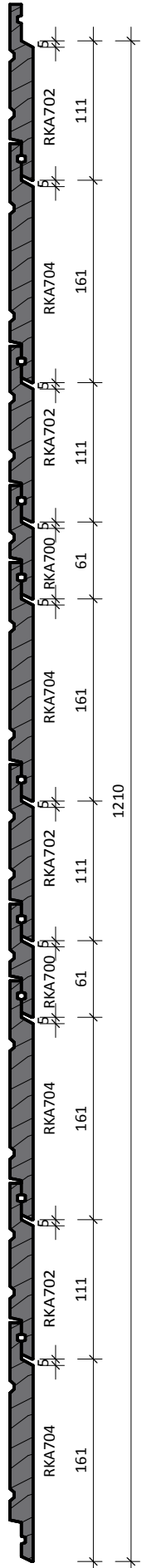

Random Depth & Width Weatherboards

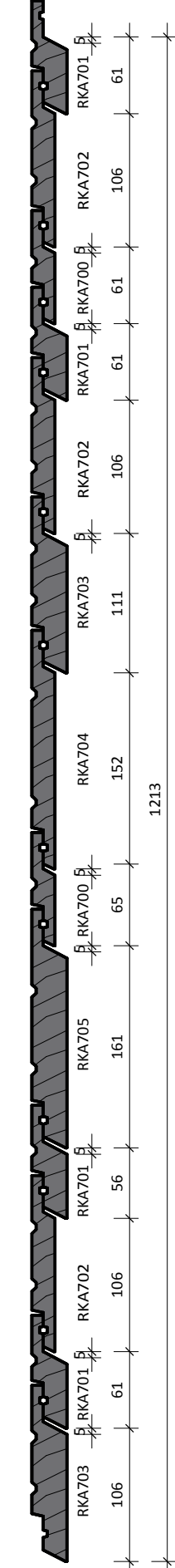

www.rosenfeldkidson.co.nz

Auckland Branch:
 513 Mt Wellington Highway
 Mt Wellington, Auckland 1060
 T. +64 9 573 0503
 F. +64 9 573 0504

Christchurch Branch:
 15 Edmonton Road, Hornby
 Christchurch 8042
 T. +64 3 349 3316
 F. +64 3 349 3317

Postal address: PO Box 621, Shortland Street, Auckland 1140

Title **Weatherboard Setout**

Drawing **RKR-SETOUT**

Scale 1 : 5 @ A4 Date 20.11.2014



rusticated



CODEMARKTM
 CMA-CM40131

1. Scope as per Clauses 1.0 and 9.4 E2/AS1
2. Profiles as per NZS 3617 Branz Bulletin 411
3. Fixings as per Table 24 E2/AS1
4. Compatibility of materials as per Tables 20-22 E2/AS1
5. Flashing as per Clause 4.0 E2/AS1
6. Rigid and flexible underlay as per Table 23 and Clauses 9.1.5 to 9.1.7 E2/AS1 or proprietary approved alternative
7. All weatherboards to be factory oiled to all faces and weathergrooves prior to installation
8. The weatherboard system relies on the joinery meeting the requirements of NZS 4211 for the relevant building windzone or wind pressure.



rusticated



CODEMARK™
CMA-CM40131

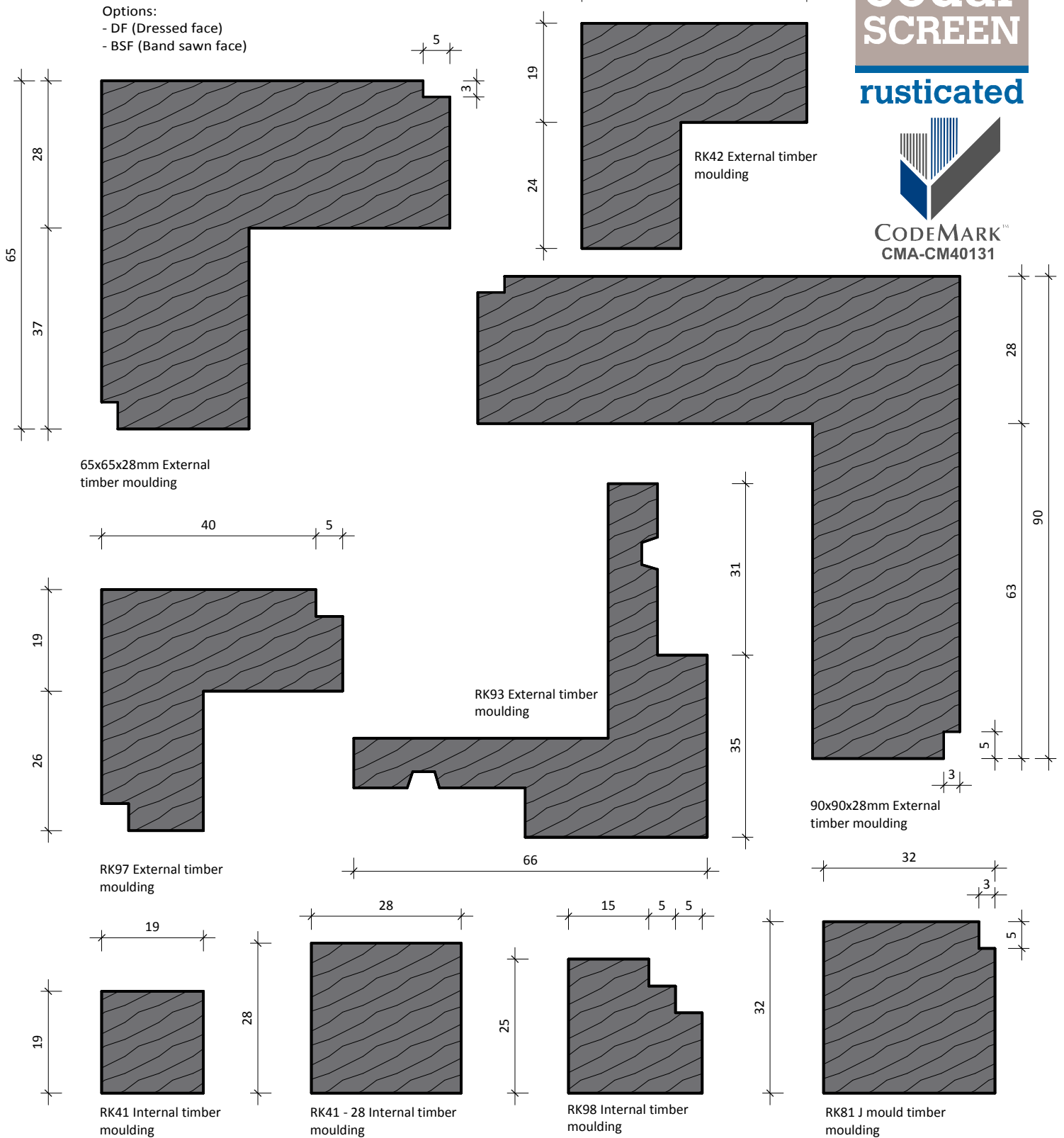

www.rosenfeldkidson.co.nz

Auckland Branch:
513 Mt Wellington Highway
Mt Wellington, Auckland 1060
T. +64 9 573 0503
F. +64 9 573 0504

Christchurch Branch:
15 Edmonton Road, Hornby
Christchurch 8042
T. +64 3 349 3316
F. +64 3 349 3317

Postal address: PO Box 621, Shortland Street, Auckland 1140

Title **RK Corner Profiles**

Drawing **RKMOULD**

Scale 1 : 1 @ A4 Date 20.11.2014

1. Scope as per Clauses 1.0 and 9.4 E2/AS1
2. Profiles as per NZS 3617 Branz Bulletin 411
3. Fixings as per Table 24 E2/AS1
4. Compatibility of materials as per Tables 20-22 E2/AS1
5. Flashing as per Clause 4.0 E2/AS1
6. Rigid and flexible underlay as per Table 23 and Clauses 9.1.5 to 9.1.7 E2/AS1 or proprietary approved alternative
7. All weatherboards to be factory oiled to all faces and weathergrooves prior to installation
8. The weatherboard system relies on the joinery meeting the requirements of NZS 4211 for the relevant building windzone or wind pressure.

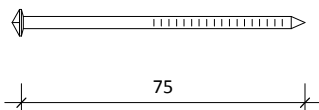

Flexible underlay 75 x 3.15mm

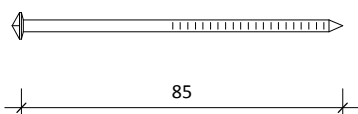

Rigid underlay 85 x 3.15mm

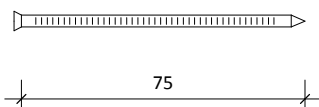

Cavity and direct fixed 75 x 3.30mm Stainless steel nail Jolthead nail for paint finish weatherboards.

RK Plug Nail Range

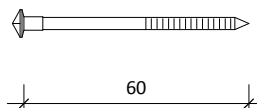

Cedarscreen Plug Nail 60 x 3.15mm

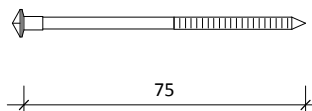

Cedarscreen Plug Nail 75 x 3.15mm

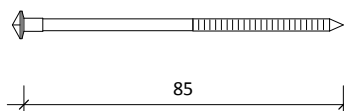

Cedarscreen Plug Nail 85 x 3.15mm

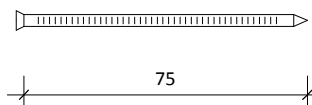

Cavity fixed 75 x 3.30mm Stainless steel nail Jolthead nail for paint finish weatherboards.

Options:

- Silicon bronze annular groove
- Stainless steel 316 grade annular groove



**Rosenfeld
Kidson**

www.rosenfeldkidson.co.nz

Auckland Branch:
513 Mt Wellington Highway
Mt Wellington, Auckland 1060
T. +64 9 573 0503
F. +64 9 573 0504

Christchurch Branch:
15 Edmonton Road, Hornby
Christchurch 8042
T. +64 3 349 3316
F. +64 3 349 3317

Postal address: PO Box 621, Shortland Street, Auckland 1140

Title **RK Nails**

Drawing

RKNAIL

Scale 1 : 2 @ A4

Date 20.11.2014

1. Scope as per Clauses 1.0 and 9.4 E2/AS1
2. Profiles as per NZS 3617 Branz Bulletin 411
3. Fixings as per Table 24 E2/AS1
4. Compatibility of materials as per Tables 20-22 E2/AS1
5. Flashing as per Clause 4.0 E2/AS1
6. Rigid and flexible underlay as per Table 23 and Clauses 9.1.5 to 9.1.7 E2/AS1 or proprietary approved alternative
7. All weatherboards to be factory oiled to all faces and weathergrooves prior to installation
8. The weatherboard system relies on the joinery meeting the requirements of NZS 4211 for the relevant building windzone or wind pressure.



rusticated



CODEMARK™
CMA-CM40131

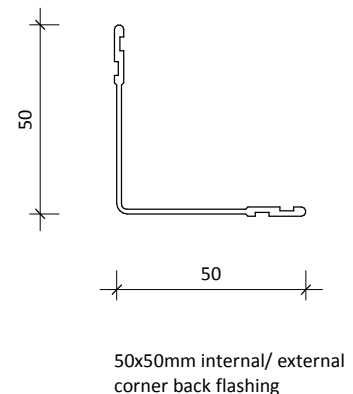
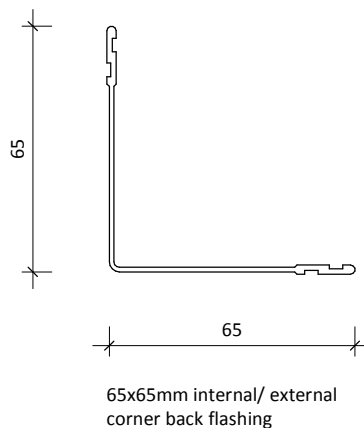
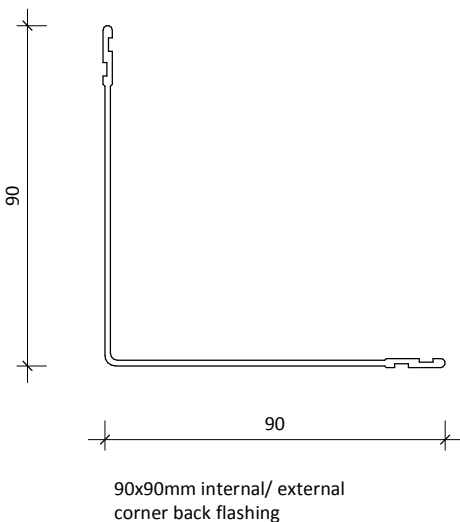
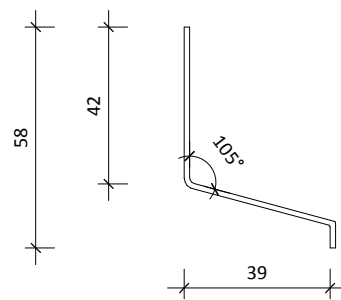
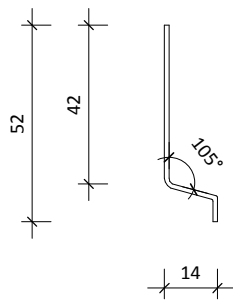
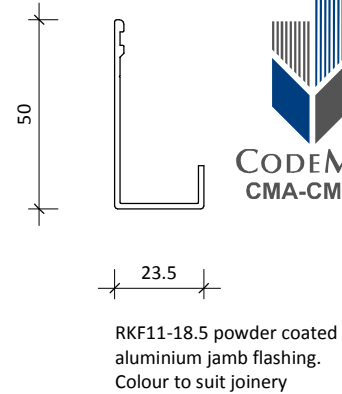
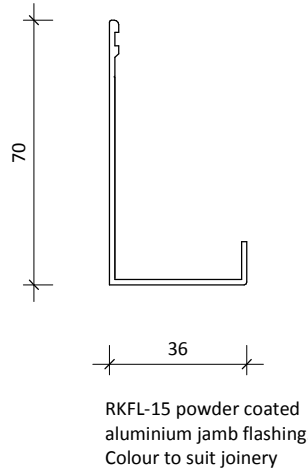
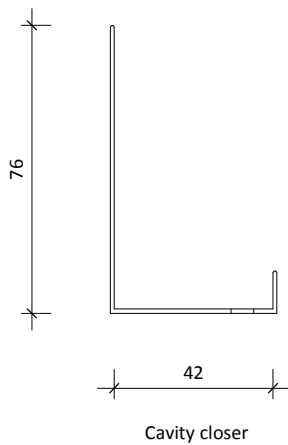
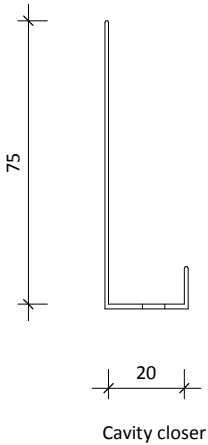

**Rosenfeld
Kidson**

www.rosenfeldkidson.co.nz

Auckland Branch:
513 Mt Wellington Highway
Mt Wellington, Auckland 1060
T. +64 9 573 0503
F. +64 9 573 0504

Christchurch Branch:
15 Edmonton Road, Hornby
Christchurch 8042
T. +64 3 349 3316
F. +64 3 349 3317

Postal address: PO Box 621, Shortland Street, Auckland 1140

Title **Flashing Details**

Drawing **RKFLG**

Scale 1 : 2 @ A4 Date 20.11.2014

1. Scope as per Clauses 1.0 and 9.4 E2/AS1
2. Profiles as per NZS 3617 Branz Bulletin 411
3. Fixings as per Table 24 E2/AS1
4. Compatibility of materials as per Tables 20-22 E2/AS1
5. Flashing as per Clause 4.0 E2/AS1
6. Rigid and flexible underlay as per Table 23 and Clauses 9.1.5 to 9.1.7 E2/AS1 or proprietary approved alternative
7. All weatherboards to be factory oiled to all faces and weathergrooves prior to installation
8. The weatherboard system relies on the joinery meeting the requirements of NZS 4211 for the relevant building windzone or wind pressure.



rusticated



CODEMARKTM
CMA-CM40131

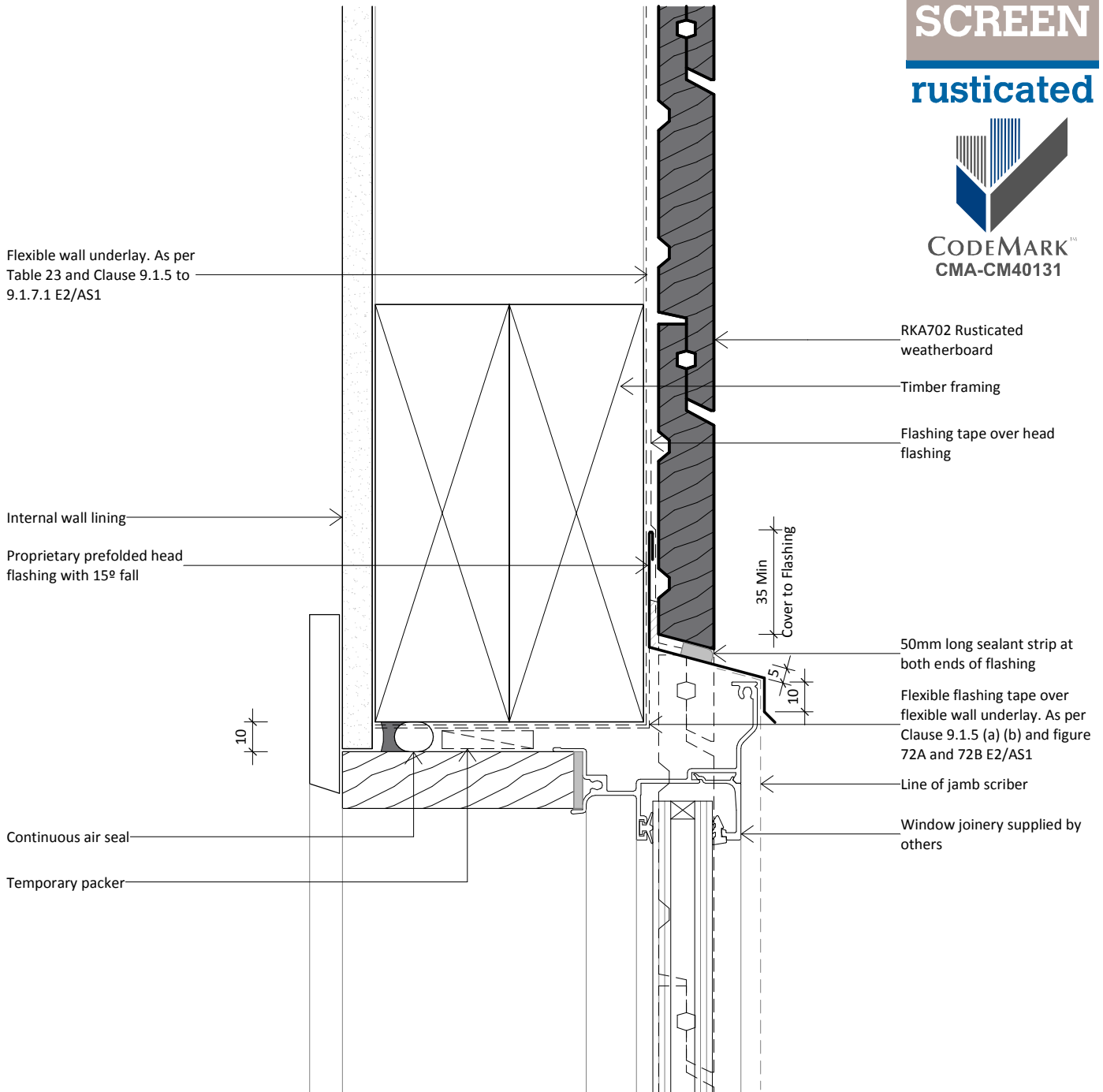

www.rosenfeldkidson.co.nz

Auckland Branch:
513 Mt Wellington Highway
Mt Wellington, Auckland 1060
T. +64 9 573 0503
F. +64 9 573 0504

Christchurch Branch:
15 Edmonton Road, Hornby
Christchurch 8042
T. +64 3 349 3316
F. +64 3 349 3317

Postal address: PO Box 621, Shortland Street, Auckland 1140

Title **Aluminium Head Detail**

Drawing
RKR-D-01

Scale 1 : 2 @ A4 Date 20.11.2014

1. Scope as per Clauses 1.0 and 9.4 E2/AS1
2. Profiles as per NZS 3617 Branz Bulletin 411
3. Fixings as per Table 24 E2/AS1
4. Compatibility of materials as per Tables 20-22 E2/AS1
5. Flashing as per Clause 4.0 E2/AS1
6. Rigid and flexible underlay as per Table 23 and Clauses 9.1.5 to 9.1.7 E2/AS1 or proprietary approved alternative
7. All weatherboards to be factory oiled to all faces and weathergrooves prior to installation
8. The weatherboard system relies on the joinery meeting the requirements of NZS 4211 for the relevant building windzone or wind pressure.



rusticated



CODEMARK™
CMA-CM40131

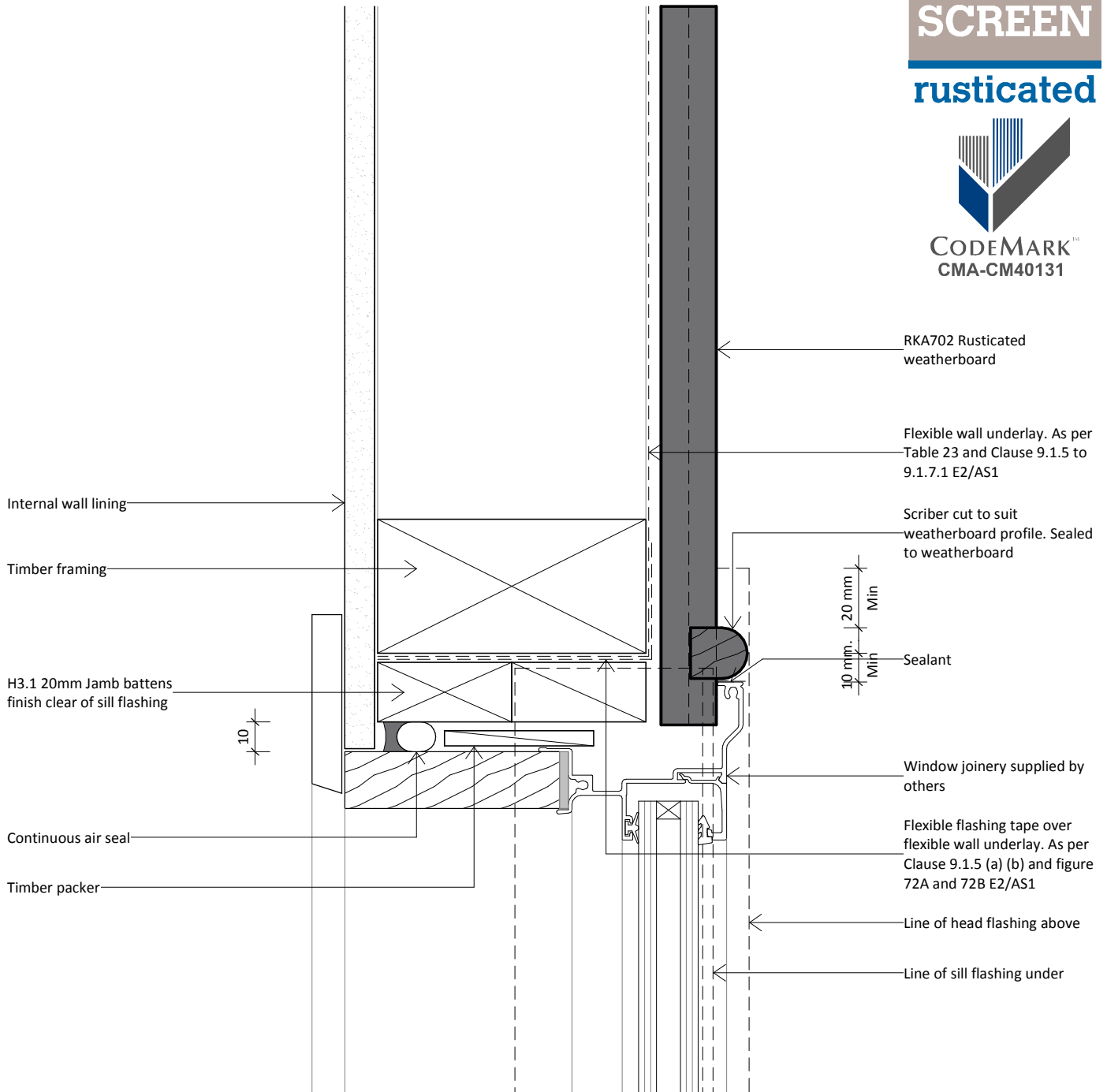

**Rosenfeld
Kidson**

www.rosenfeldkidson.co.nz

Auckland Branch:
513 Mt Wellington Highway
Mt Wellington, Auckland 1060
T. +64 9 573 0503
F. +64 9 573 0504

Christchurch Branch:
15 Edmonton Road, Hornby
Christchurch 8042
T. +64 3 349 3316
F. +64 3 349 3317

Postal address: PO Box 621, Shortland Street, Auckland 1140

Title **Aluminium Jamb Detail**

Drawing

RKR-D-02

Scale 1 : 2 @ A4

Date 20.11.2014

1. Scope as per Clauses 1.0 and 9.4 E2/AS1
2. Profiles as per NZS 3617 Branz Bulletin 411
3. Fixings as per Table 24 E2/AS1
4. Compatibility of materials as per Tables 20-22 E2/AS1
5. Flashing as per Clause 4.0 E2/AS1
6. Rigid and flexible underlay as per Table 23 and Clauses 9.1.5 to 9.1.7 E2/AS1 or proprietary approved alternative
7. All weatherboards to be factory oiled to all faces and weathergrooves prior to installation
8. The weatherboard system relies on the joinery meeting the requirements of NZS 4211 for the relevant building windzone or wind pressure.



rusticated



CODEMARK™
CMA-CM40131

Flexible flashing tape over flexible wall underlay. As per Clause 9.1.5 (a) (b) and figure 72A and 72B E2/AS1

Timber packer

Continuous air seal

10

Timber framing

Internal wall lining

Window joinery supplied by others

Frame block

5 Gap without seal
10mm Min
35 mm Min
Flashing Cover

Sill flashing to extend behind joinery frame 8mm min. Refer figure 72A NZBC E2/AS1

RKA702 Rusticated weatherboard

Flexible wall underlay. As per Table 23 and Clause 9.1.5 to 9.1.7.1 E2/AS1

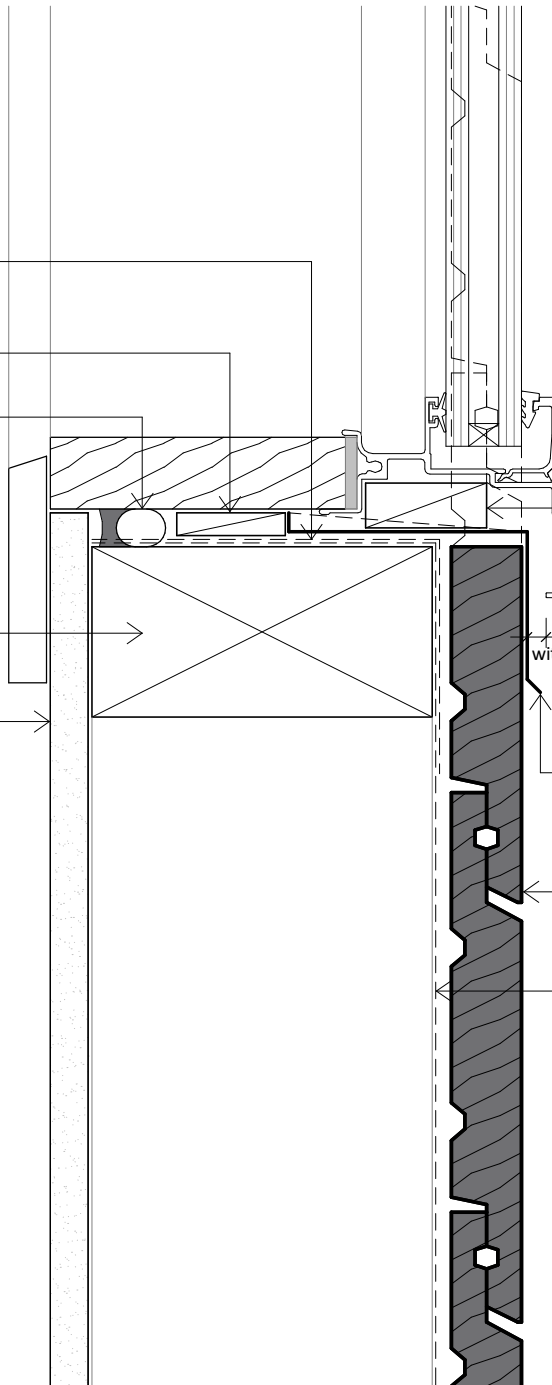

**Rosenfeld
Kidson**

www.rosenfeldkidson.co.nz

Auckland Branch:
513 Mt Wellington Highway
Mt Wellington, Auckland 1060
T. +64 9 573 0503
F. +64 9 573 0504

Christchurch Branch:
15 Edmonton Road, Hornby
Christchurch 8042
T. +64 3 349 3316
F. +64 3 349 3317

Postal address: PO Box 621, Shortland Street, Auckland 1140

Title **Aluminium Sill Detail**

Drawing
RKR-D-03

Scale 1 : 2 @ A4 Date 20.11.2014

1. Scope as per Clauses 1.0 and 9.4 E2/AS1
2. Profiles as per NZS 3617 Branz Bulletin 411
3. Fixings as per Table 24 E2/AS1
4. Compatibility of materials as per Tables 20-22 E2/AS1
5. Flashing as per Clause 4.0 E2/AS1
6. Rigid and flexible underlay as per Table 23 and Clauses 9.1.5 to 9.1.7 E2/AS1 or proprietary approved alternative
7. All weatherboards to be factory oiled to all faces and weathergrooves prior to installation
8. The weatherboard system relies on the joinery meeting the requirements of NZS 4211 for the relevant building windzone or wind pressure.



rusticated



CODEMARK™
CMA-CM40131

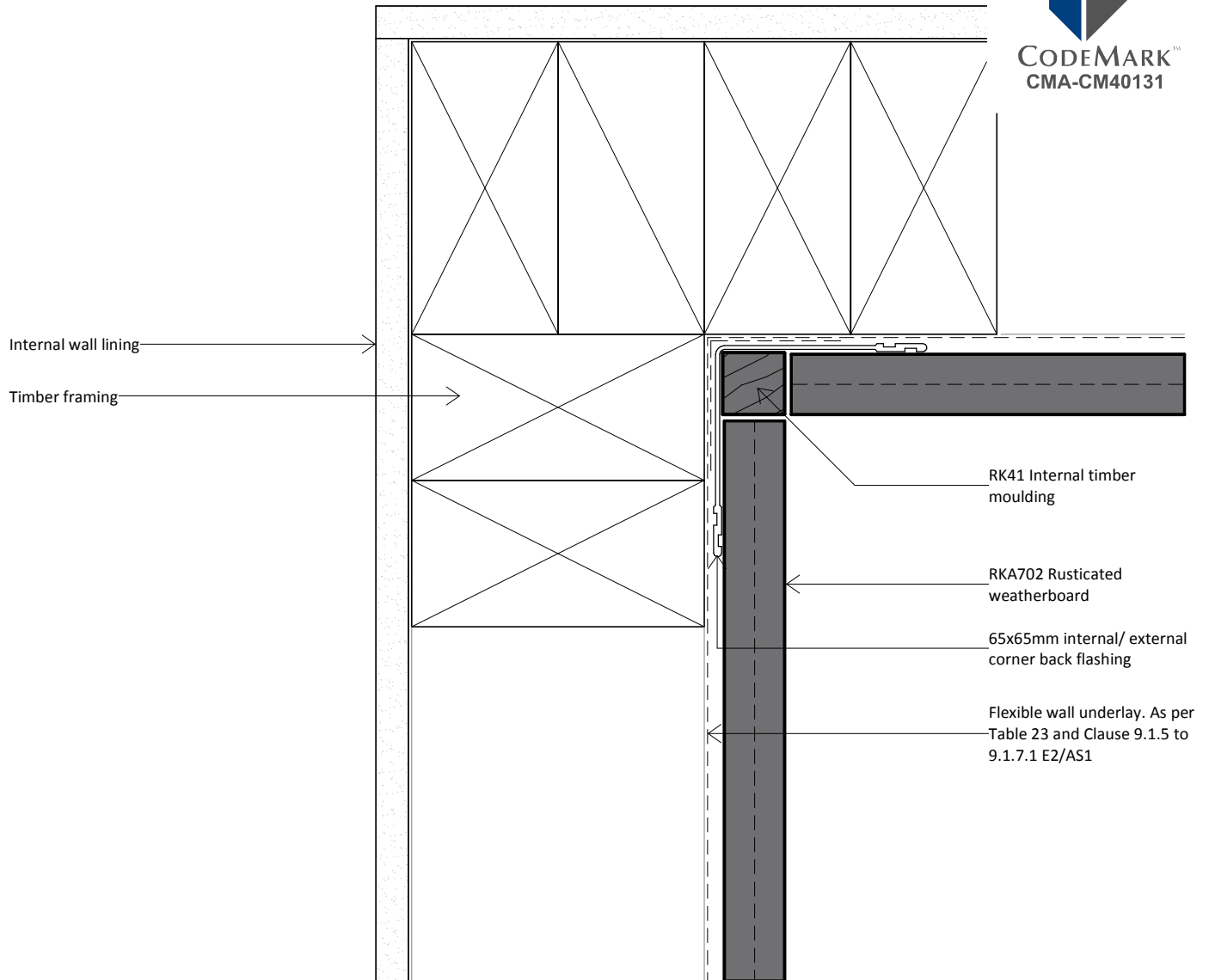

**Rosenfeld
Kidson**

www.rosenfeldkidson.co.nz

Auckland Branch:
513 Mt Wellington Highway
Mt Wellington, Auckland 1060
T. +64 9 573 0503
F. +64 9 573 0504

Christchurch Branch:
15 Edmonton Road, Hornby
Christchurch 8042
T. +64 3 349 3316
F. +64 3 349 3317

Postal address: PO Box 621, Shortland Street, Auckland 1140

Title **Internal Corner RK41
Detail - Option 1**

Drawing
RKR-D-11

Scale 1 : 2 @ A4 Date 20.11.2014

1. Scope as per Clauses 1.0 and 9.4 E2/AS1
2. Profiles as per NZS 3617 Branz Bulletin 411
3. Fixings as per Table 24 E2/AS1
4. Compatibility of materials as per Tables 20-22 E2/AS1
5. Flashing as per Clause 4.0 E2/AS1
6. Rigid and flexible underlay as per Table 23 and Clauses 9.1.5 to 9.1.7 E2/AS1 or proprietary approved alternative
7. All weatherboards to be factory oiled to all faces and weathergrooves prior to installation
8. The weatherboard system relies on the joinery meeting the requirements of NZS 4211 for the relevant building windzone or wind pressure.



rusticated



CODEMARK™
CMA-CM40131

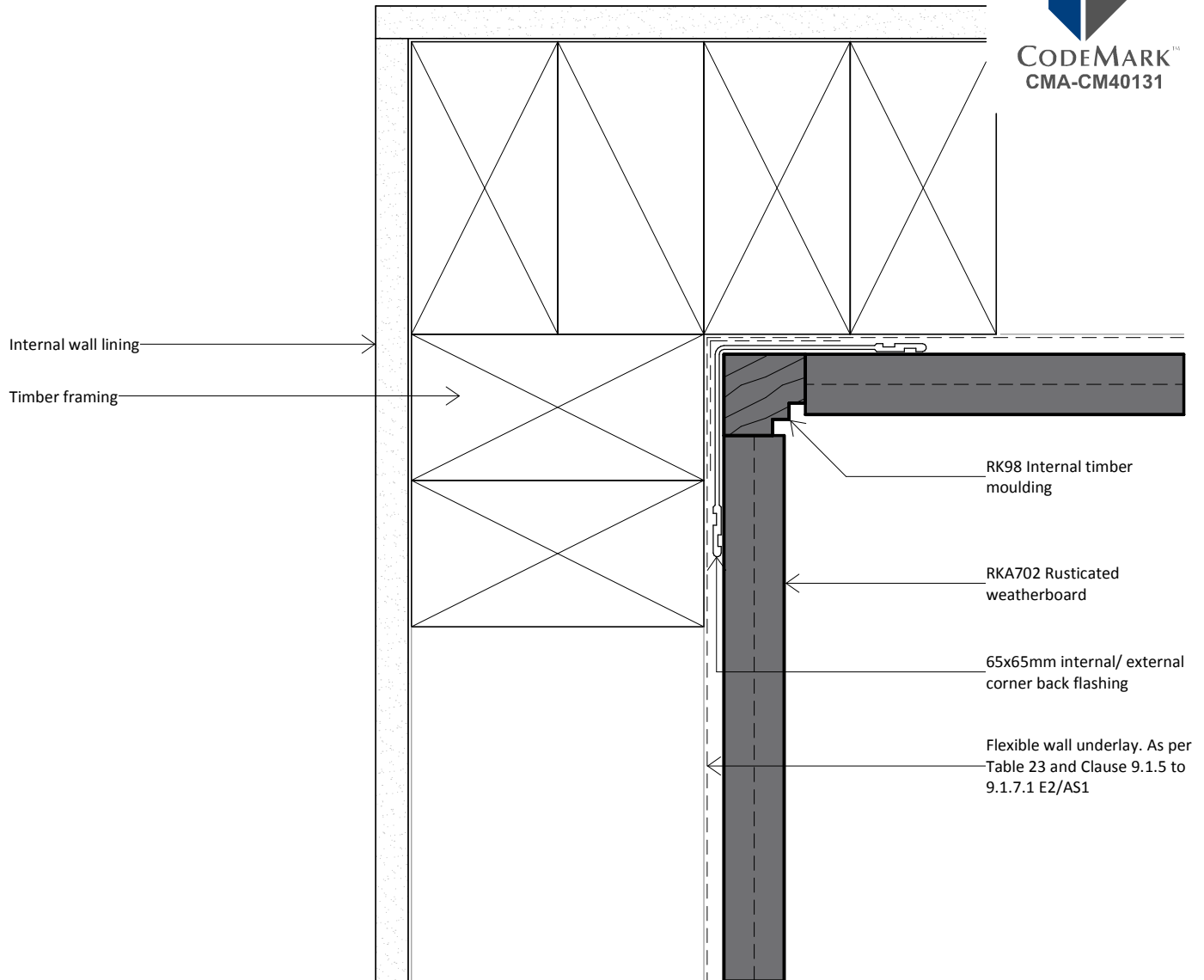

www.rosenfeldkidson.co.nz

Auckland Branch:
513 Mt Wellington Highway
Mt Wellington, Auckland 1060
T. +64 9 573 0503
F. +64 9 573 0504

Christchurch Branch:
15 Edmonton Road, Hornby
Christchurch 8042
T. +64 3 349 3316
F. +64 3 349 3317

Postal address: PO Box 621, Shortland Street, Auckland 1140

Title **Internal Corner RK98
Detail - Option 2**

Drawing **RKR-D-12**

Scale 1 : 2 @ A4 Date 20.11.2014

1. Scope as per Clauses 1.0 and 9.4 E2/AS1
2. Profiles as per NZS 3617 Branz Bulletin 411
3. Fixings as per Table 24 E2/AS1
4. Compatibility of materials as per Tables 20-22 E2/AS1
5. Flashing as per Clause 4.0 E2/AS1
6. Rigid and flexible underlay as per Table 23 and Clauses 9.1.5 to 9.1.7 E2/AS1 or proprietary approved alternative
7. All weatherboards to be factory oiled to all faces and weathergrooves prior to installation
8. The weatherboard system relies on the joinery meeting the requirements of NZS 4211 for the relevant building windzone or wind pressure.



rusticated



CODEMARK™
CMA-CM40131

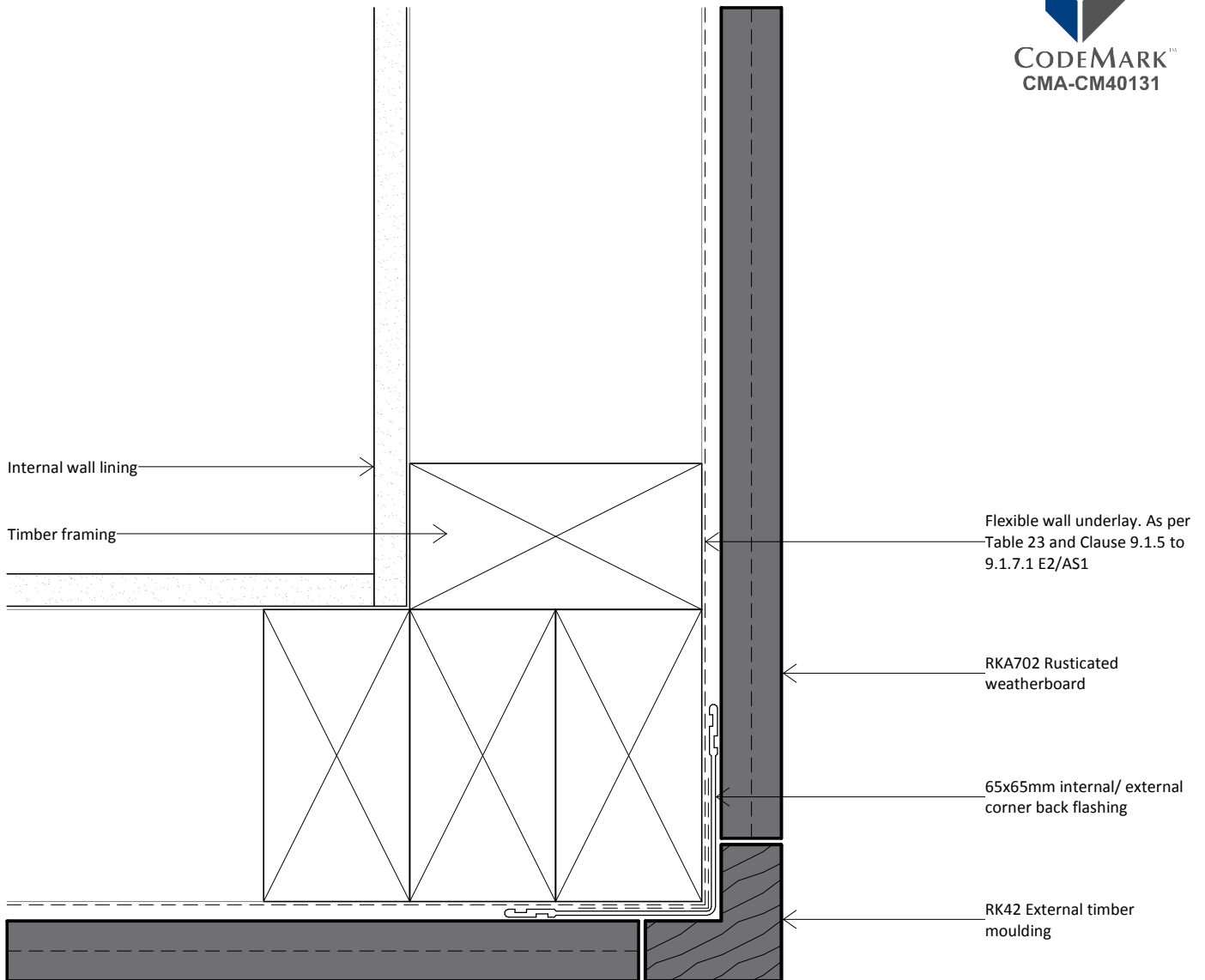

**Rosenfeld
Kidson**

www.rosenfeldkidson.co.nz

Auckland Branch:
513 Mt Wellington Highway
Mt Wellington, Auckland 1060
T. +64 9 573 0503
F. +64 9 573 0504

Christchurch Branch:
15 Edmonton Road, Hornby
Christchurch 8042
T. +64 3 349 3316
F. +64 3 349 3317

Postal address: PO Box 621, Shortland Street, Auckland 1140

Title **External Corner RKA42
Detail - Option 1**

Drawing
RKR-D-21

Scale 1 : 2 @ A4 Date 20.11.2014

1. Scope as per Clauses 1.0 and 9.4 E2/AS1
2. Profiles as per NZS 3617 Branz Bulletin 411
3. Fixings as per Table 24 E2/AS1
4. Compatibility of materials as per Tables 20-22 E2/AS1
5. Flashing as per Clause 4.0 E2/AS1
6. Rigid and flexible underlay as per Table 23 and Clauses 9.1.5 to 9.1.7 E2/AS1 or proprietary approved alternative
7. All weatherboards to be factory oiled to all faces and weathergrooves prior to installation
8. The weatherboard system relies on the joinery meeting the requirements of NZS 4211 for the relevant building windzone or wind pressure.



rusticated



CODEMARK™
CMA-CM40131

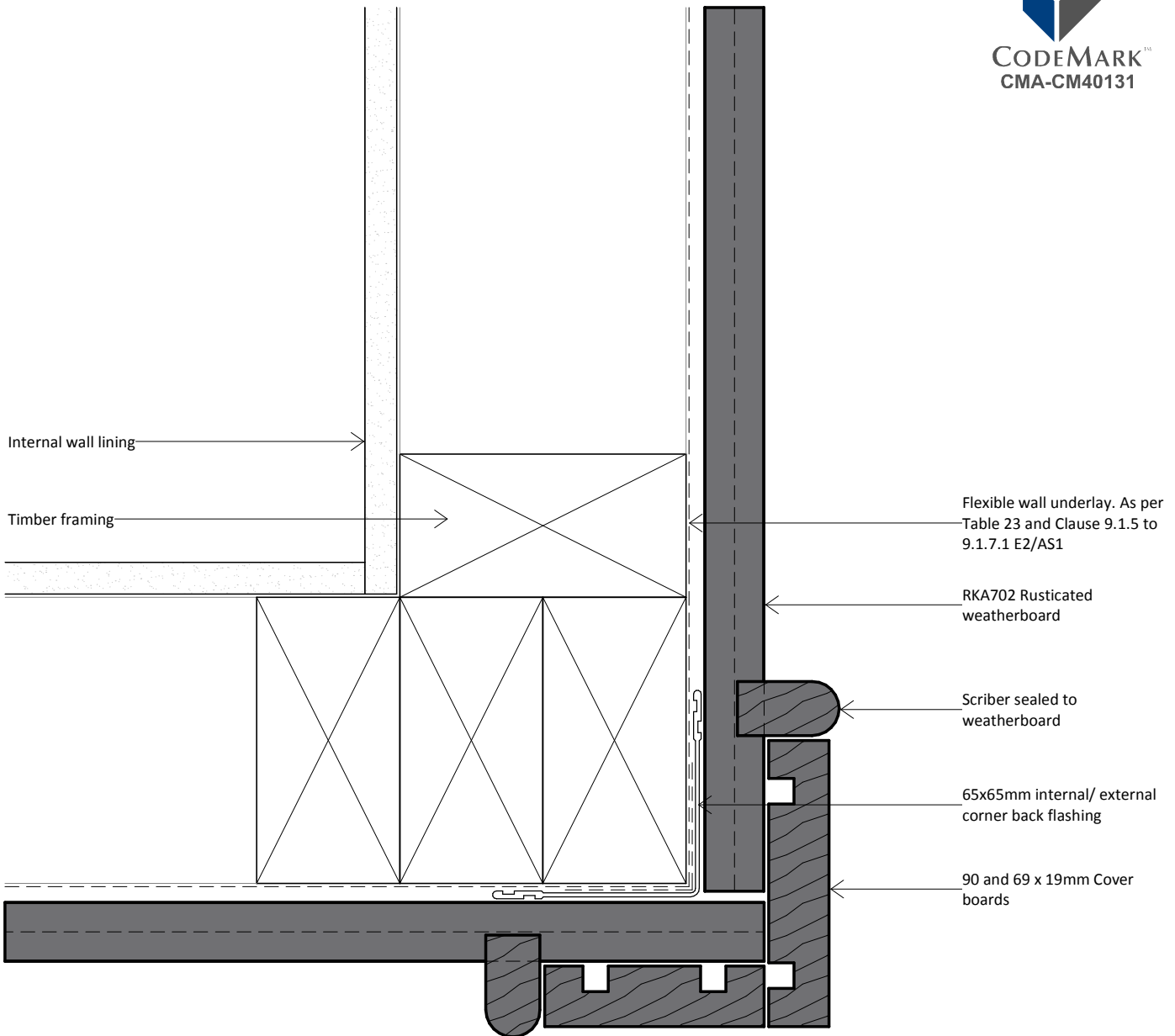

**Rosenfeld
Kidson**

www.rosenfeldkidson.co.nz

Auckland Branch:
513 Mt Wellington Highway
Mt Wellington, Auckland 1060
T. +64 9 573 0503
F. +64 9 573 0504

Christchurch Branch:
15 Edmonton Road, Hornby
Christchurch 8042
T. +64 3 349 3316
F. +64 3 349 3317

Postal address: PO Box 621, Shortland Street, Auckland 1140

Title **External Corner Detail -
Option 2**

Drawing
RKR-D-22

Scale 1 : 2 @ A4 Date 20.11.2014

1. Scope as per Clauses 1.0 and 9.4 E2/AS1
2. Profiles as per NZS 3617 Branz Bulletin 411
3. Fixings as per Table 24 E2/AS1
4. Compatibility of materials as per Tables 20-22 E2/AS1
5. Flashing as per Clause 4.0 E2/AS1
6. Rigid and flexible underlay as per Table 23 and Clauses 9.1.5 to 9.1.7 E2/AS1 or proprietary approved alternative
7. All weatherboards to be factory oiled to all faces and weathergrooves prior to installation
8. The weatherboard system relies on the joinery meeting the requirements of NZS 4211 for the relevant building windzone or wind pressure.



rusticated



CODEMARK™
CMA-CM40131

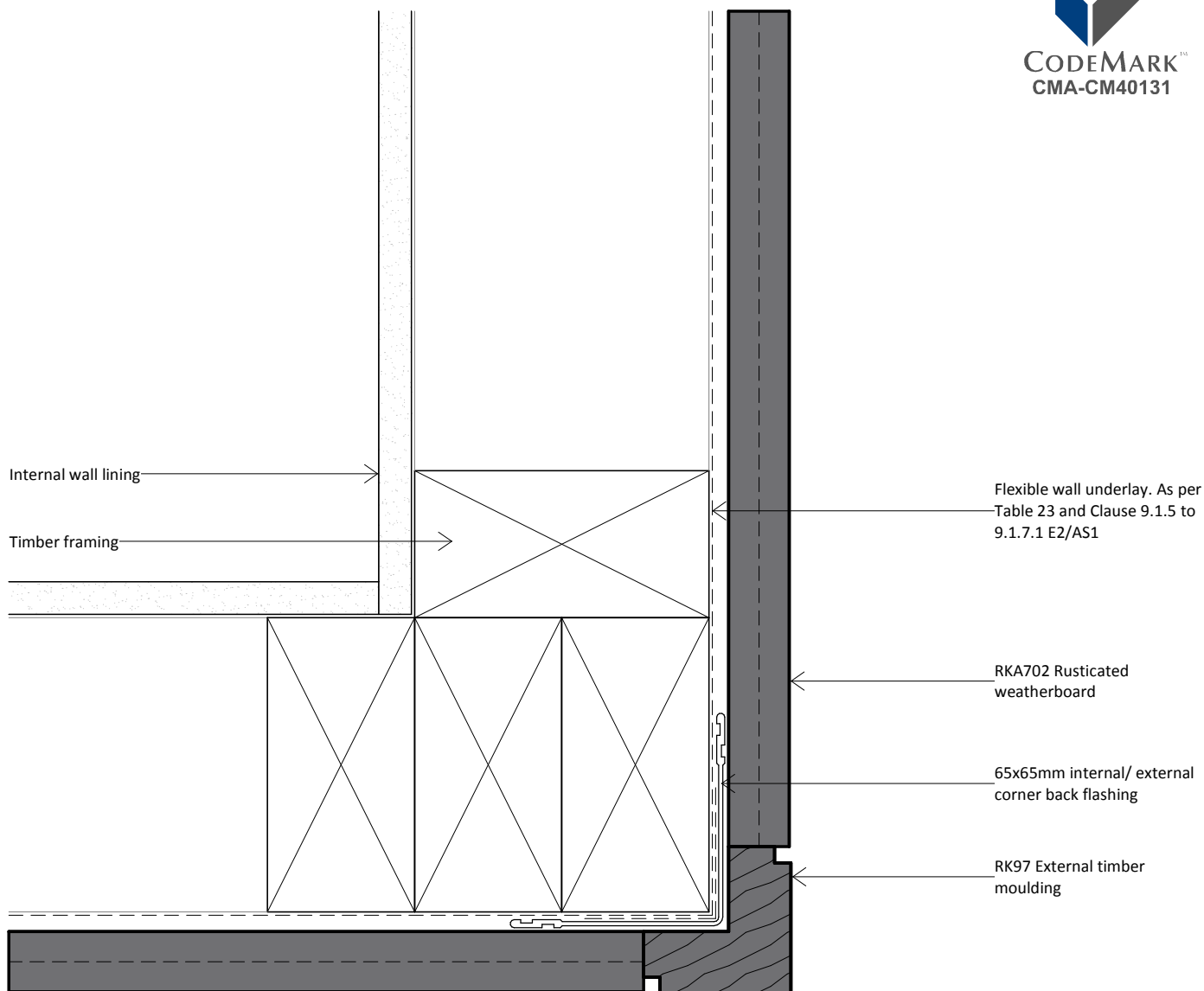

**Rosenfeld
Kidson**

www.rosenfeldkidson.co.nz

Auckland Branch:
513 Mt Wellington Highway
Mt Wellington, Auckland 1060
T. +64 9 573 0503
F. +64 9 573 0504

Christchurch Branch:
15 Edmonton Road, Hornby
Christchurch 8042
T. +64 3 349 3316
F. +64 3 349 3317

Postal address: PO Box 621, Shortland Street, Auckland 1140

Title **External Corner RK97
Detail - Option 3**

Drawing
RKR-D-23

Scale 1 : 2 @ A4 Date 20.11.2014

1. Scope as per Clauses 1.0 and 9.4 E2/AS1
2. Profiles as per NZS 3617 Branz Bulletin 411
3. Fixings as per Table 24 E2/AS1
4. Compatibility of materials as per Tables 20-22 E2/AS1
5. Flashing as per Clause 4.0 E2/AS1
6. Rigid and flexible underlay as per Table 23 and Clauses 9.1.5 to 9.1.7 E2/AS1 or proprietary approved alternative
7. All weatherboards to be factory oiled to all faces and weathergrooves prior to installation
8. The weatherboard system relies on the joinery meeting the requirements of NZS 4211 for the relevant building windzone or wind pressure.



rusticated



CODEMARK™
CMA-CM40131

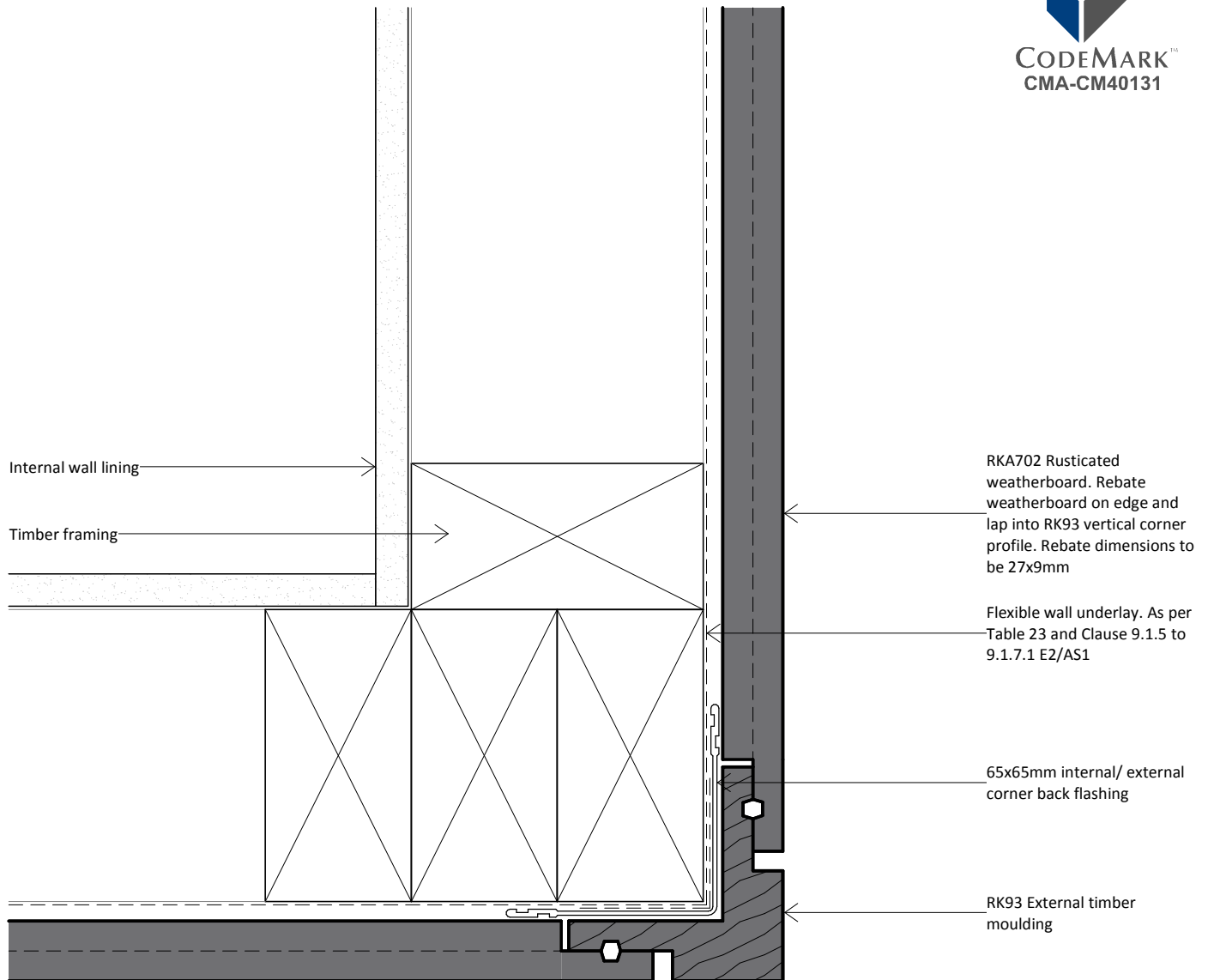

Internal wall lining

Timber framing

RKA702 Rusticated weatherboard. Rebate weatherboard on edge and lap into RK93 vertical corner profile. Rebate dimensions to be 27x9mm

Flexible wall underlay. As per Table 23 and Clause 9.1.5 to 9.1.7.1 E2/AS1

65x65mm internal/ external corner back flashing

RK93 External timber moulding



**Rosenfeld
Kidson**

www.rosenfeldkidson.co.nz

Auckland Branch:
513 Mt Wellington Highway
Mt Wellington, Auckland 1060
T. +64 9 573 0503
F. +64 9 573 0504

Christchurch Branch:
15 Edmonton Road, Hornby
Christchurch 8042
T. +64 3 349 3316
F. +64 3 349 3317

Postal address: PO Box 621, Shortland Street, Auckland 1140

Title **External Corner RK93
Detail - Option 4**

Drawing **RKR-D-24**

Scale 1 : 2 @ A4 Date 20.11.2014

1. Scope as per Clauses 1.0 and 9.4 E2/AS1
2. Profiles as per NZS 3617 Branz Bulletin 411
3. Fixings as per Table 24 E2/AS1
4. Compatibility of materials as per Tables 20-22 E2/AS1
5. Flashing as per Clause 4.0 E2/AS1
6. Rigid and flexible underlay as per Table 23 and Clauses 9.1.5 to 9.1.7 E2/AS1 or proprietary approved alternative
7. All weatherboards to be factory oiled to all faces and weathergrooves prior to installation
8. The weatherboard system relies on the joinery meeting the requirements of NZS 4211 for the relevant building windzone or wind pressure.



rusticated



CODEMARK™
CMA-CM40131

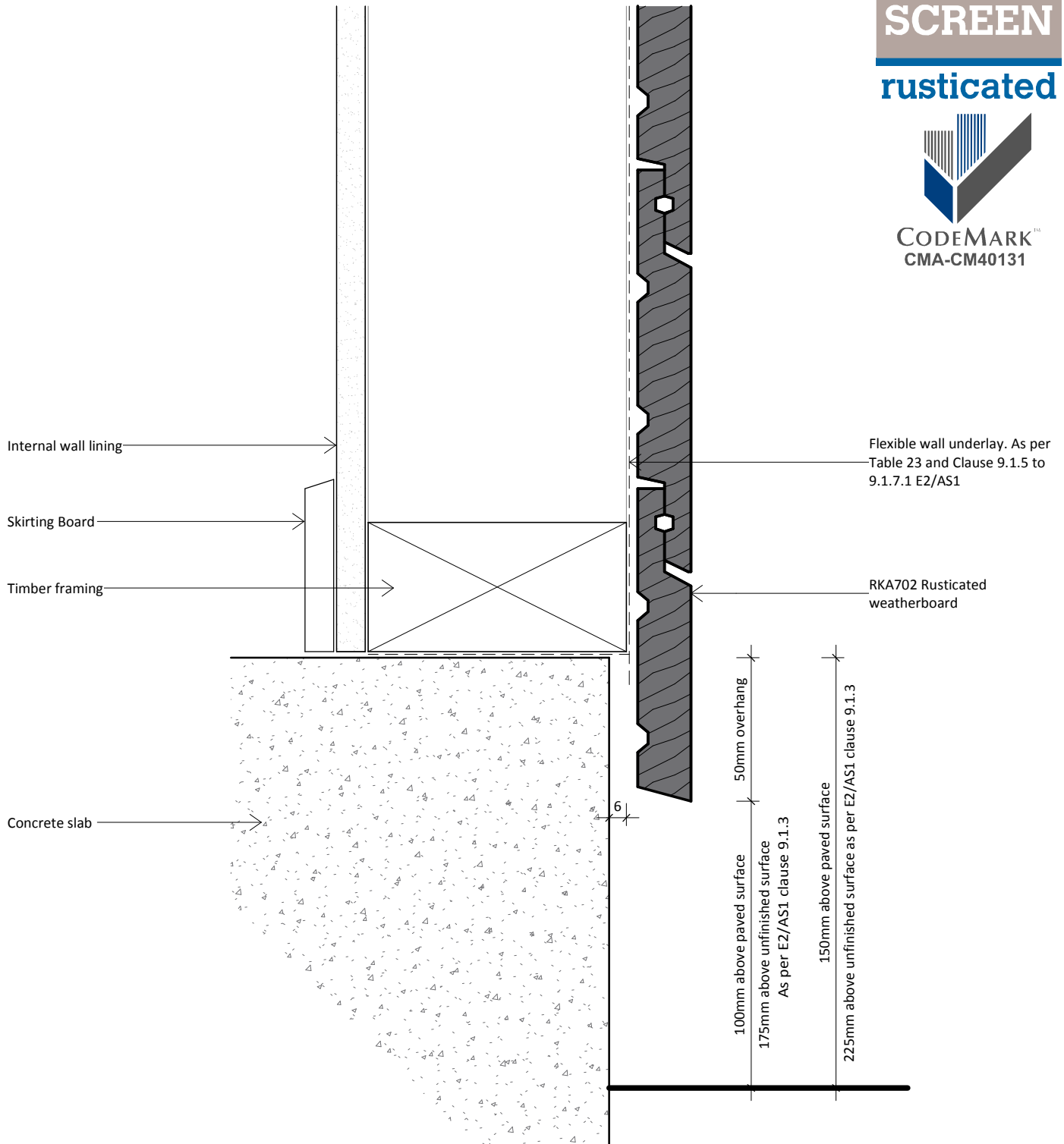

**Rosenfeld
Kidson**

www.rosenfeldkidson.co.nz

Auckland Branch:
513 Mt Wellington Highway
Mt Wellington, Auckland 1060
T. +64 9 573 0503
F. +64 9 573 0504

Christchurch Branch:
15 Edmonton Road, Hornby
Christchurch 8042
T. +64 3 349 3316
F. +64 3 349 3317

Postal address: PO Box 621, Shortland Street, Auckland 1140

Title **Bottom Plate Detail**

Drawing

RKR-D-41

Scale 1 : 2 @ A4

Date 20.11.2014

1. Scope as per Clauses 1.0 and 9.4 E2/AS1
2. Profiles as per NZS 3617 Branz Bulletin 411
3. Fixings as per Table 24 E2/AS1
4. Compatibility of materials as per Tables 20-22 E2/AS1
5. Flashing as per Clause 4.0 E2/AS1
6. Rigid and flexible underlay as per Table 23 and Clauses 9.1.5 to 9.1.7 E2/AS1 or proprietary approved alternative
7. All weatherboards to be factory oiled to all faces and weathergrooves prior to installation
8. The weatherboard system relies on the joinery meeting the requirements of NZS 4211 for the relevant building windzone or wind pressure.



rusticated



CODEMARK™
CMA-CM40131

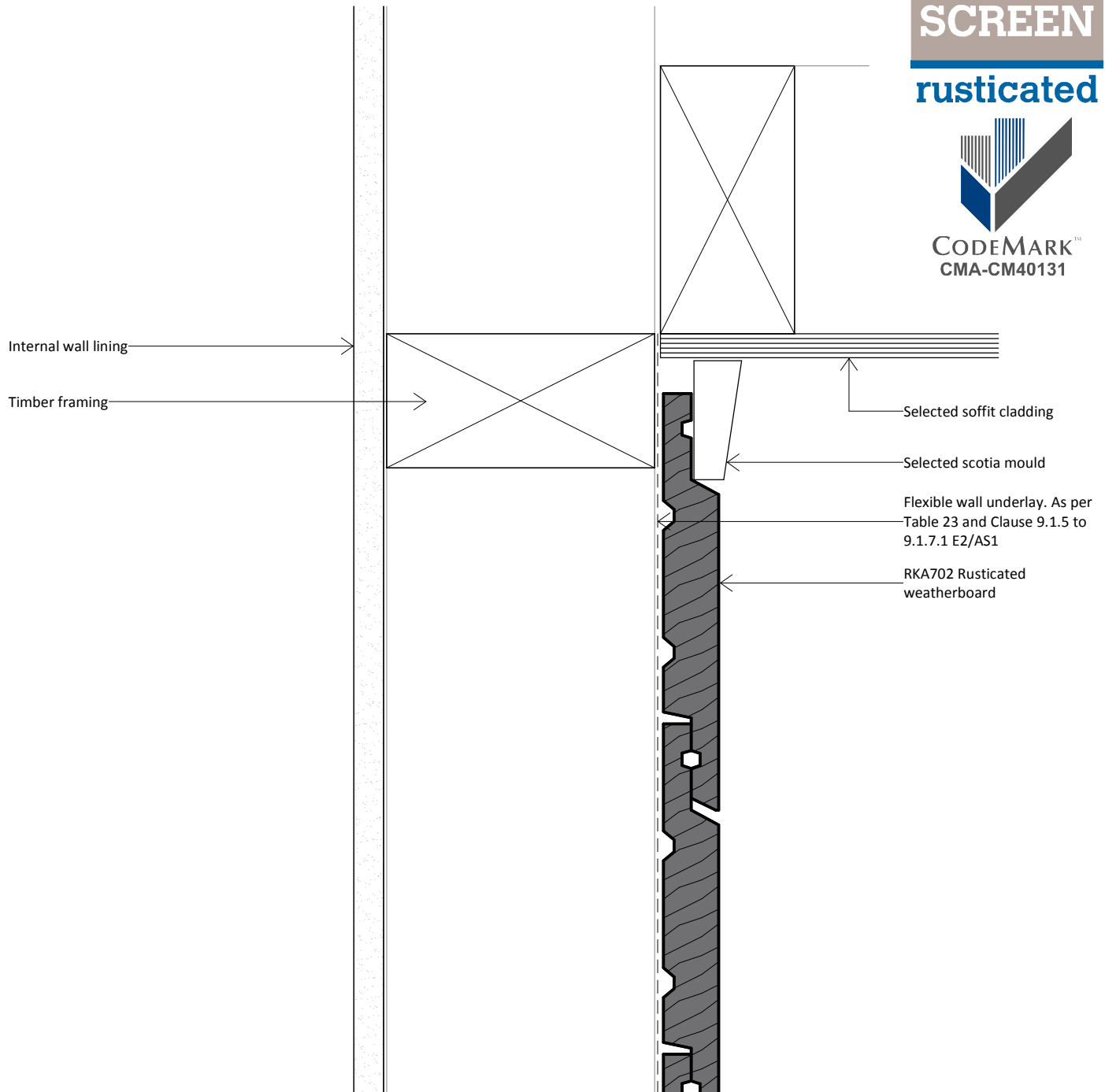

**Rosenfeld
Kidson**

www.rosenfeldkidson.co.nz

Auckland Branch:
513 Mt Wellington Highway
Mt Wellington, Auckland 1060
T. +64 9 573 0503
F. +64 9 573 0504

Christchurch Branch:
15 Edmonton Road, Hornby
Christchurch 8042
T. +64 3 349 3316
F. +64 3 349 3317

Postal address: PO Box 621, Shortland Street, Auckland 1140

Title **Top Plate to Soffit Detail**

Drawing

RKR-D-42

Scale 1 : 2 @ A4

Date 20.11.2014

1. Scope as per Clauses 1.0 and 9.4 E2/AS1
2. Profiles as per NZS 3617 Branz Bulletin 411
3. Fixings as per Table 24 E2/AS1
4. Compatibility of materials as per Tables 20-22 E2/AS1
5. Flashing as per Clause 4.0 E2/AS1
6. Rigid and flexible underlay as per Table 23 and Clauses 9.1.5 to 9.1.7 E2/AS1 or proprietary approved alternative
7. All weatherboards to be factory oiled to all faces and weathergrooves prior to installation
8. The weatherboard system relies on the joinery meeting the requirements of NZS 4211 for the relevant building windzone or wind pressure.



rusticated



CODEMARK
CMA-CM40131

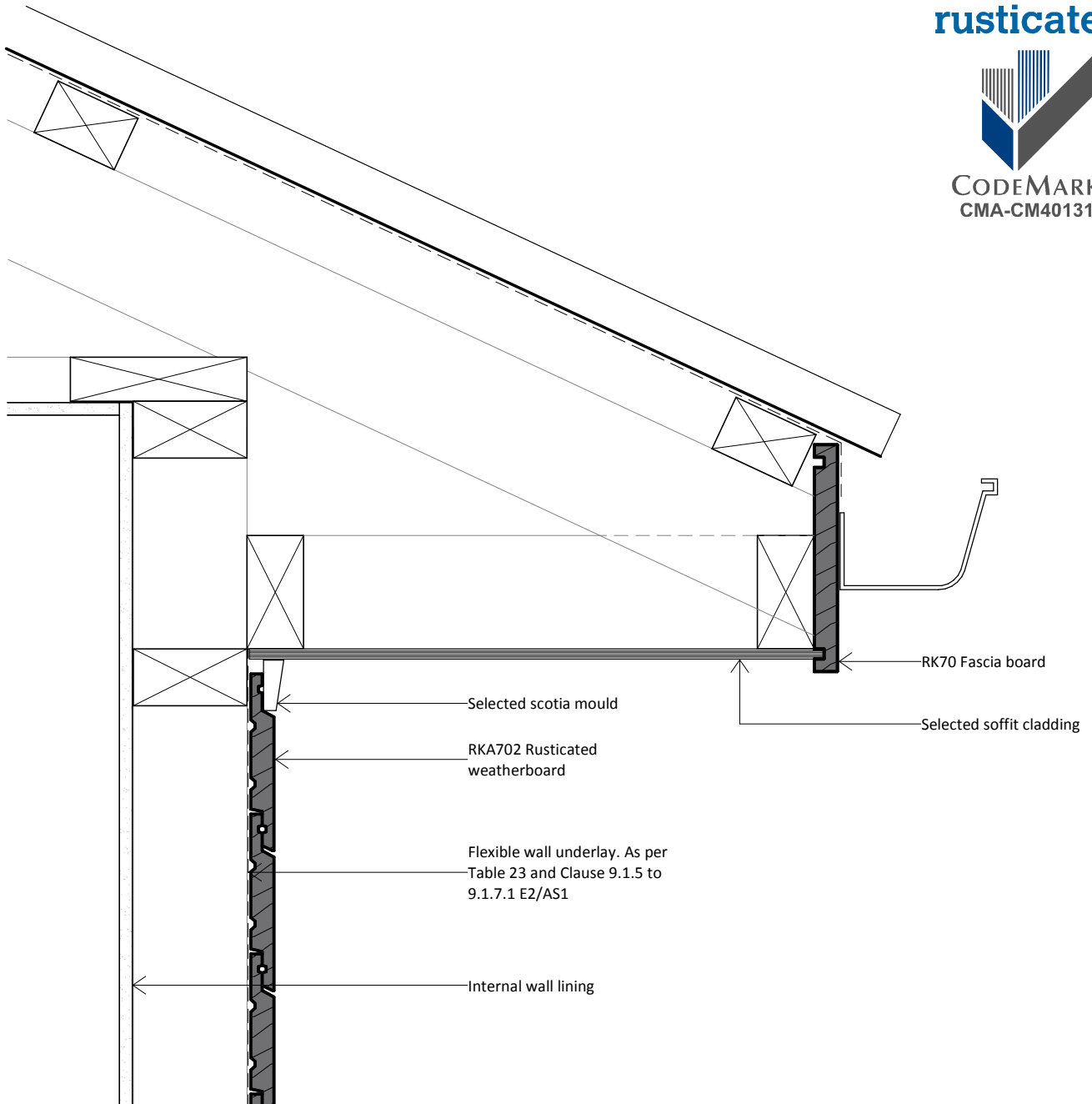

**Rosenfeld
Kidson**

www.rosenfeldkidson.co.nz

Auckland Branch:
513 Mt Wellington Highway
Mt Wellington, Auckland 1060
T. +64 9 573 0503
F. +64 9 573 0504

Christchurch Branch:
15 Edmonton Road, Hornby
Christchurch 8042
T. +64 3 349 3316
F. +64 3 349 3317

Postal address: PO Box 621, Shortland Street, Auckland 1140

Title **Barge Detail**

Drawing

RKR-D-43

Scale 1 : 5 @ A4

Date 20.11.2014

1. Scope as per Clauses 1.0 and 9.4 E2/AS1
2. Profiles as per NZS 3617 Branz Bulletin 411
3. Fixings as per Table 24 E2/AS1
4. Compatibility of materials as per Tables 20-22 E2/AS1
5. Flashing as per Clause 4.0 E2/AS1
6. Rigid and flexible underlay as per Table 23 and Clauses 9.1.5 to 9.1.7 E2/AS1 or proprietary approved alternative
7. All weatherboards to be factory oiled to all faces and weathergrooves prior to installation
8. The weatherboard system relies on the joinery meeting the requirements of NZS 4211 for the relevant building windzone or wind pressure.



rusticated



CODEMARK™
CMA-CM40131

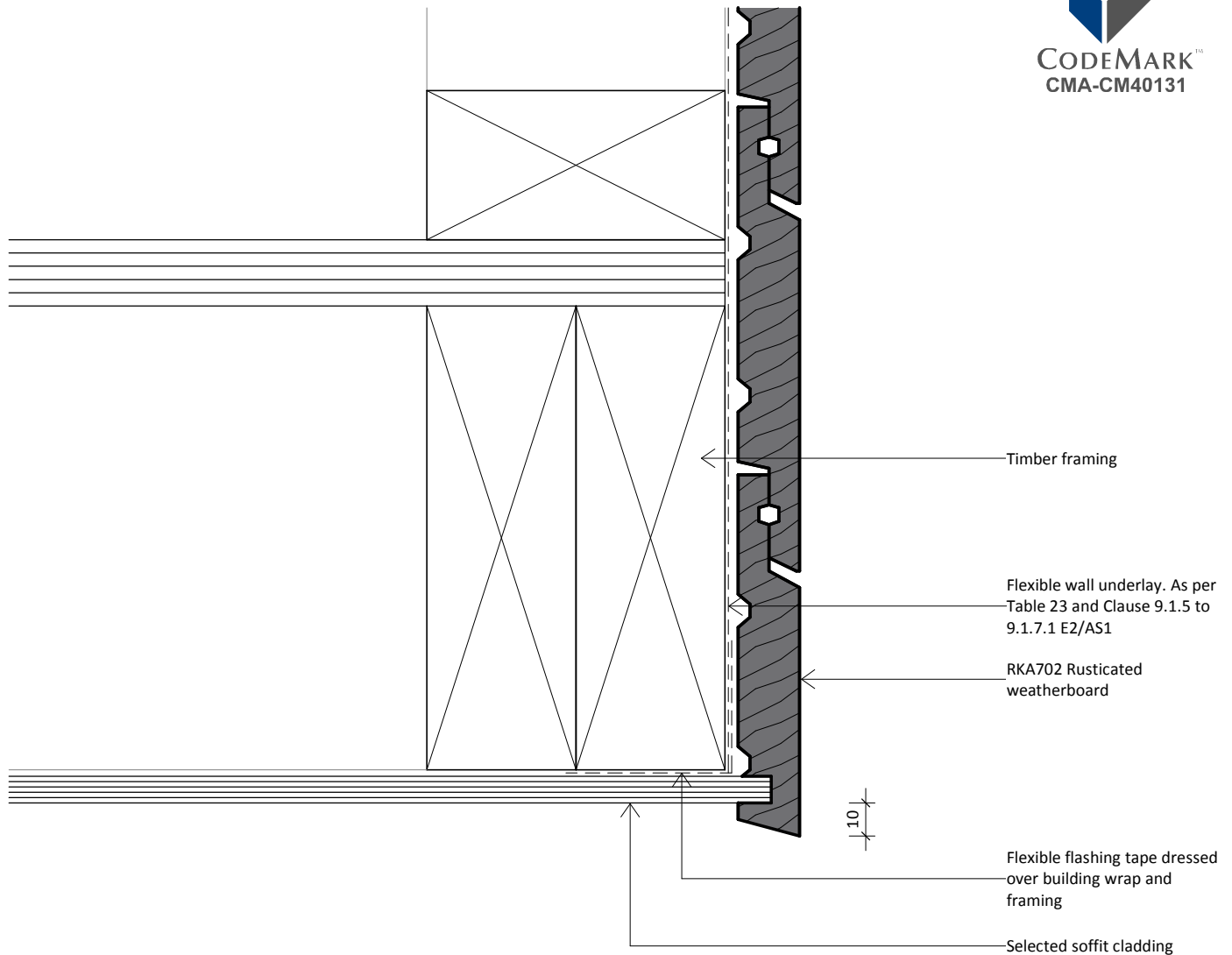

**Rosenfeld
Kidson**

www.rosenfeldkidson.co.nz

Auckland Branch:
513 Mt Wellington Highway
Mt Wellington, Auckland 1060
T. +64 9 573 0503
F. +64 9 573 0504

Christchurch Branch:
15 Edmonton Road, Hornby
Christchurch 8042
T. +64 3 349 3316
F. +64 3 349 3317

Postal address: PO Box 621, Shortland Street, Auckland 1140

Title **Soffit Detail**

Drawing

RKR-D-44

Scale 1 : 2 @ A4

Date 20.11.2014

1. Scope as per Clauses 1.0 and 9.4 E2/AS1
2. Profiles as per NZS 3617 Branz Bulletin 411
3. Fixings as per Table 24 E2/AS1
4. Compatibility of materials as per Tables 20-22 E2/AS1
5. Flashing as per Clause 4.0 E2/AS1
6. Rigid and flexible underlay as per Table 23 and Clauses 9.1.5 to 9.1.7 E2/AS1 or proprietary approved alternative
7. All weatherboards to be factory oiled to all faces and weathergrooves prior to installation
8. The weatherboard system relies on the joinery meeting the requirements of NZS 4211 for the relevant building windzone or wind pressure.



rusticated



CODEMARK™
CMA-CM40131

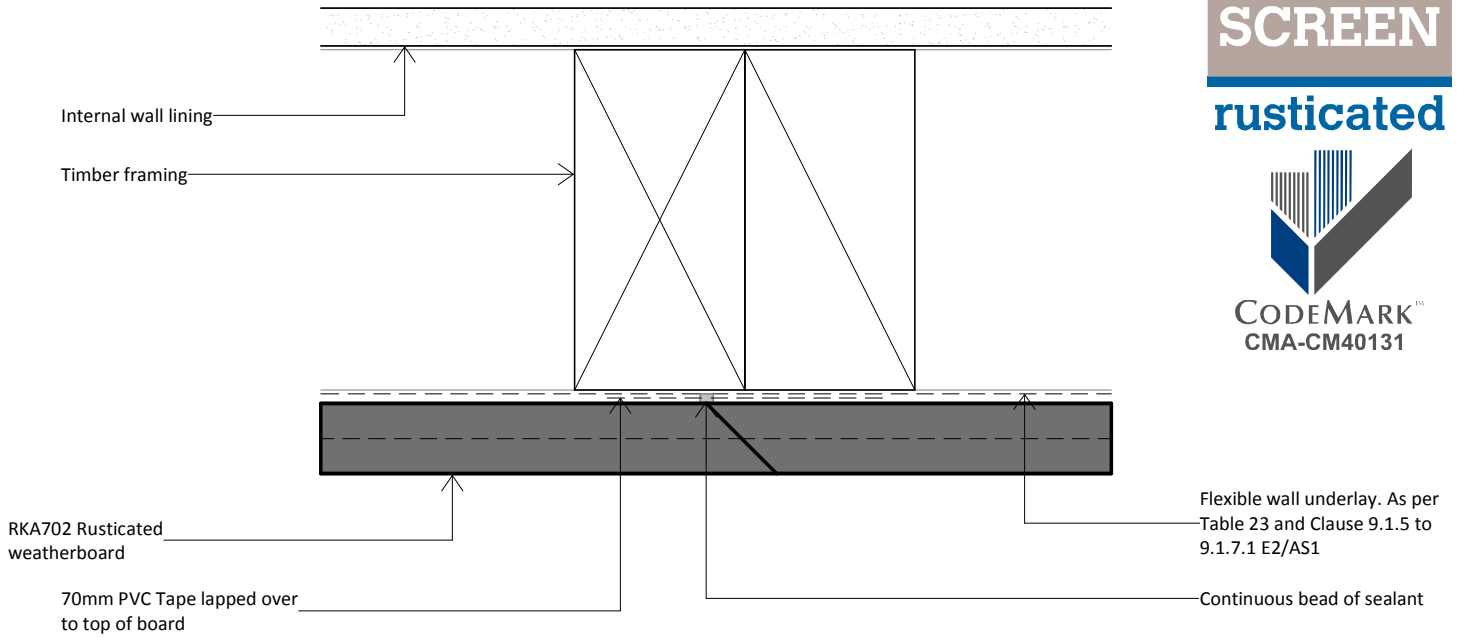

Horizontal Plan

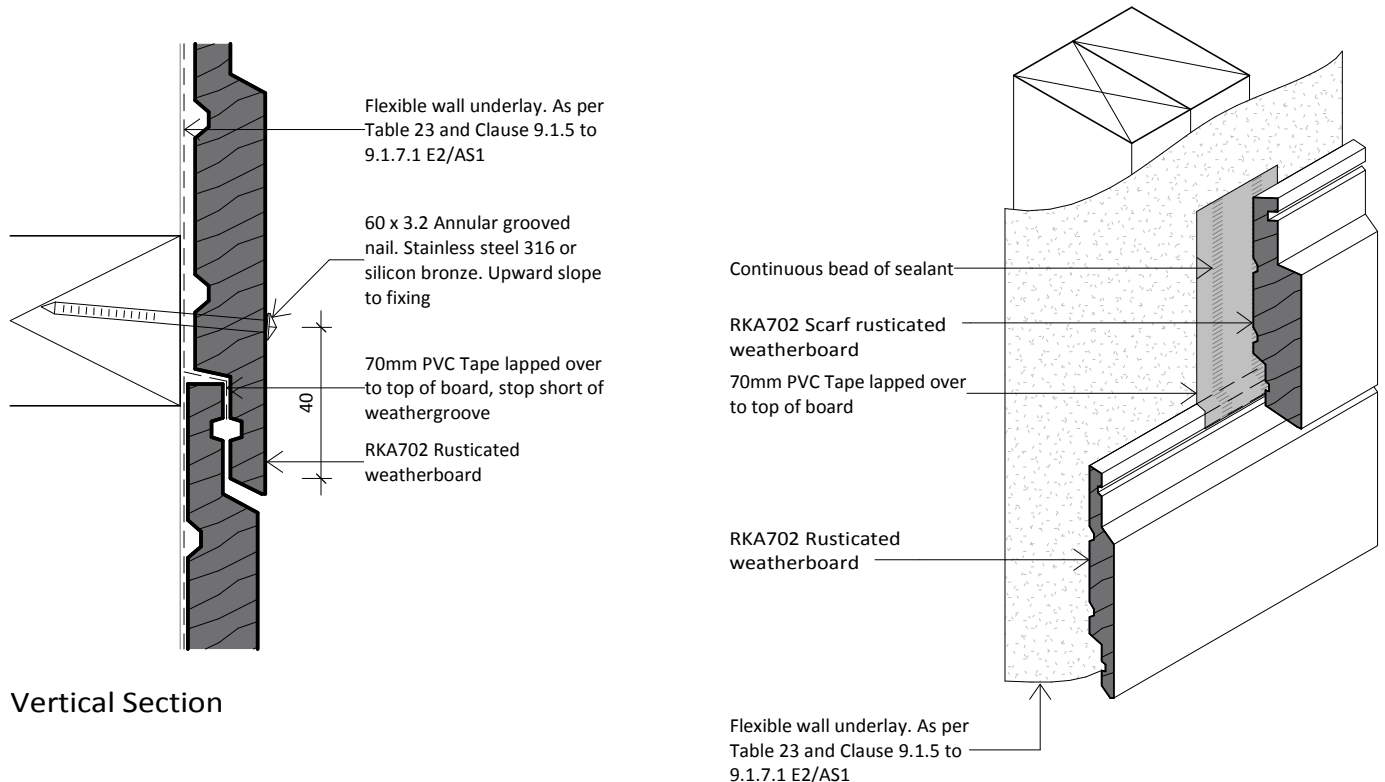

Vertical Section



**Rosenfeld
Kidson**

www.rosenfeldkidson.co.nz

Auckland Branch:
513 Mt Wellington Highway
Mt Wellington, Auckland 1060
T. +64 9 573 0503
F. +64 9 573 0504

Christchurch Branch:
15 Edmonton Road, Hornby
Christchurch 8042
T. +64 3 349 3316
F. +64 3 349 3317

Postal address: PO Box 621, Shortland Street, Auckland 1140

Title **Scarf Joint Detail**

Drawing

RKR-D-45

Scale 1 : 2 @ A4

Date 20.11.2014

1. Scope as per Clauses 1.0 and 9.4 E2/AS1
2. Profiles as per NZS 3617 Branz Bulletin 411
3. Fixings as per Table 24 E2/AS1
4. Compatibility of materials as per Tables 20-22 E2/AS1
5. Flashing as per Clause 4.0 E2/AS1
6. Rigid and flexible underlay as per Table 23 and Clauses 9.1.5 to 9.1.7 E2/AS1 or proprietary approved alternative
7. All weatherboards to be factory oiled to all faces and weathergrooves prior to installation
8. The weatherboard system relies on the joinery meeting the requirements of NZS 4211 for the relevant building windzone or wind pressure.



rusticated



CODEMARK™
CMA-CM40131

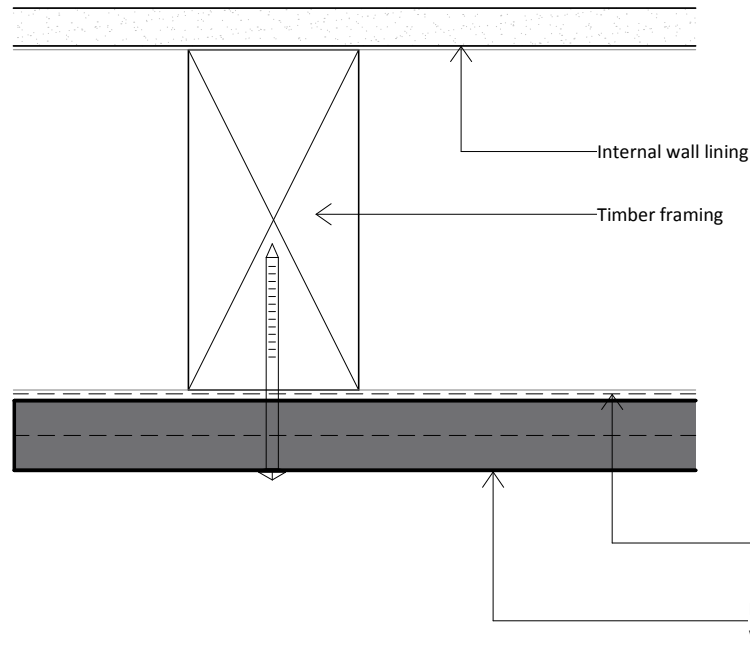

Horizontal fixing

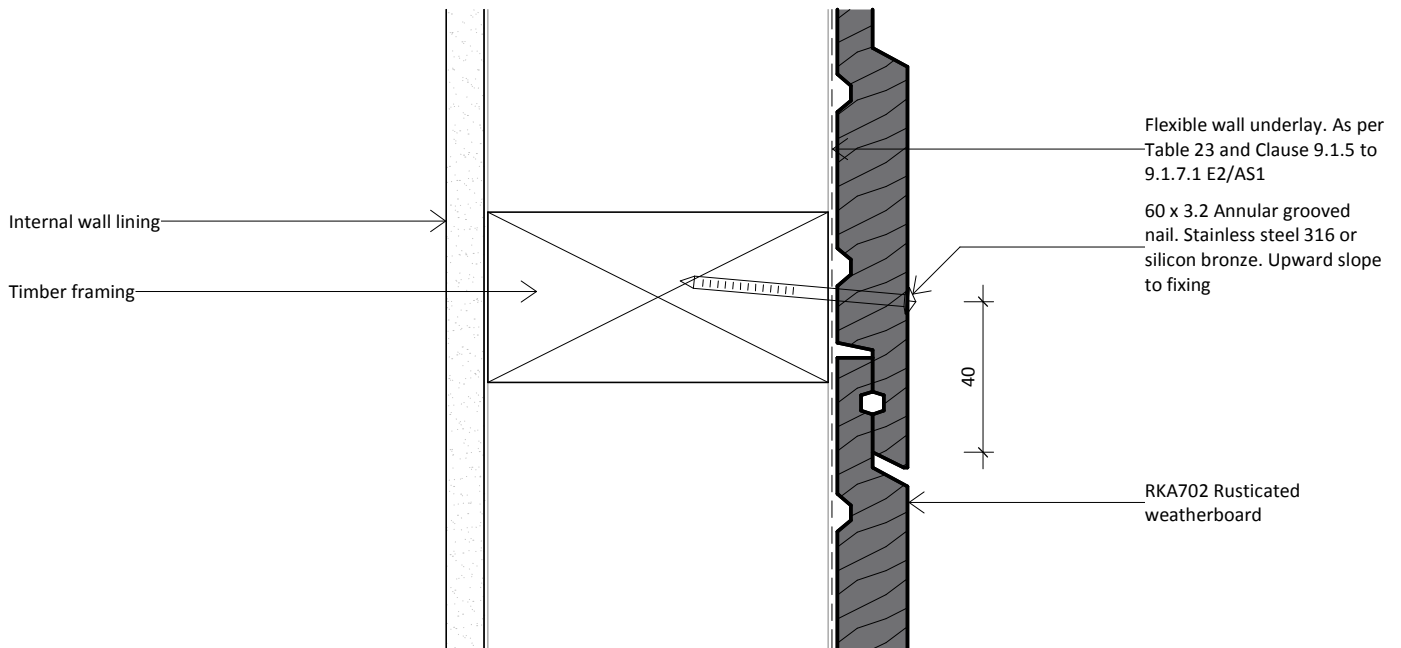

Vertical fixing



**Rosenfeld
Kidson**

www.rosenfeldkidson.co.nz

Auckland Branch:
513 Mt Wellington Highway
Mt Wellington, Auckland 1060
T. +64 9 573 0503
F. +64 9 573 0504

Christchurch Branch:
15 Edmonton Road, Hornby
Christchurch 8042
T. +64 3 349 3316
F. +64 3 349 3317

Postal address: PO Box 621, Shortland Street, Auckland 1140

Title **Nail Fixing Detail**

Drawing

RKR-D-46

Scale 1 : 2 @ A4

Date 20.11.2014

1. Scope as per Clauses 1.0 and 9.4 E2/AS1
2. Profiles as per NZS 3617 Branz Bulletin 411
3. Fixings as per Table 24 E2/AS1
4. Compatibility of materials as per Tables 20-22 E2/AS1
5. Flashing as per Clause 4.0 E2/AS1
6. Rigid and flexible underlay as per Table 23 and Clauses 9.1.5 to 9.1.7 E2/AS1 or proprietary approved alternative
7. All weatherboards to be factory oiled to all faces and weathergrooves prior to installation
8. The weatherboard system relies on the joinery meeting the requirements of NZS 4211 for the relevant building windzone or wind pressure.



rusticated



CODEMARK
CMA-CM40131

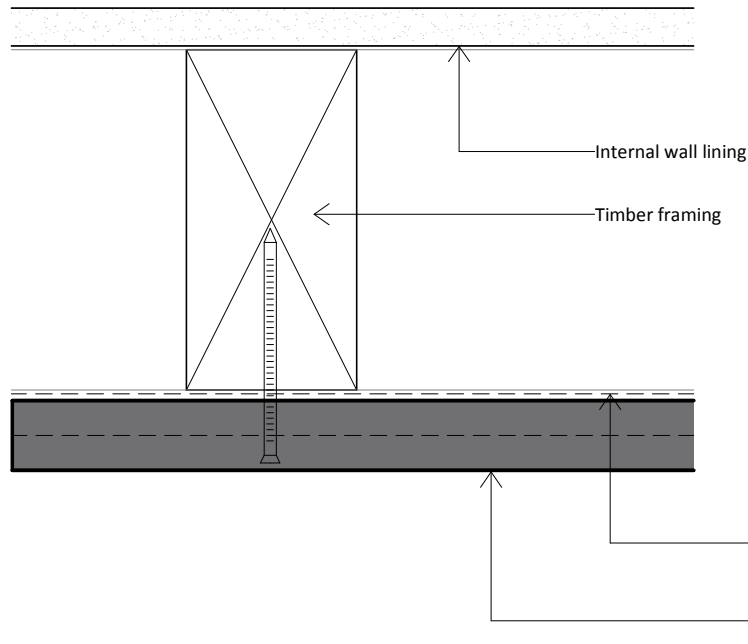

Horizontal fixing

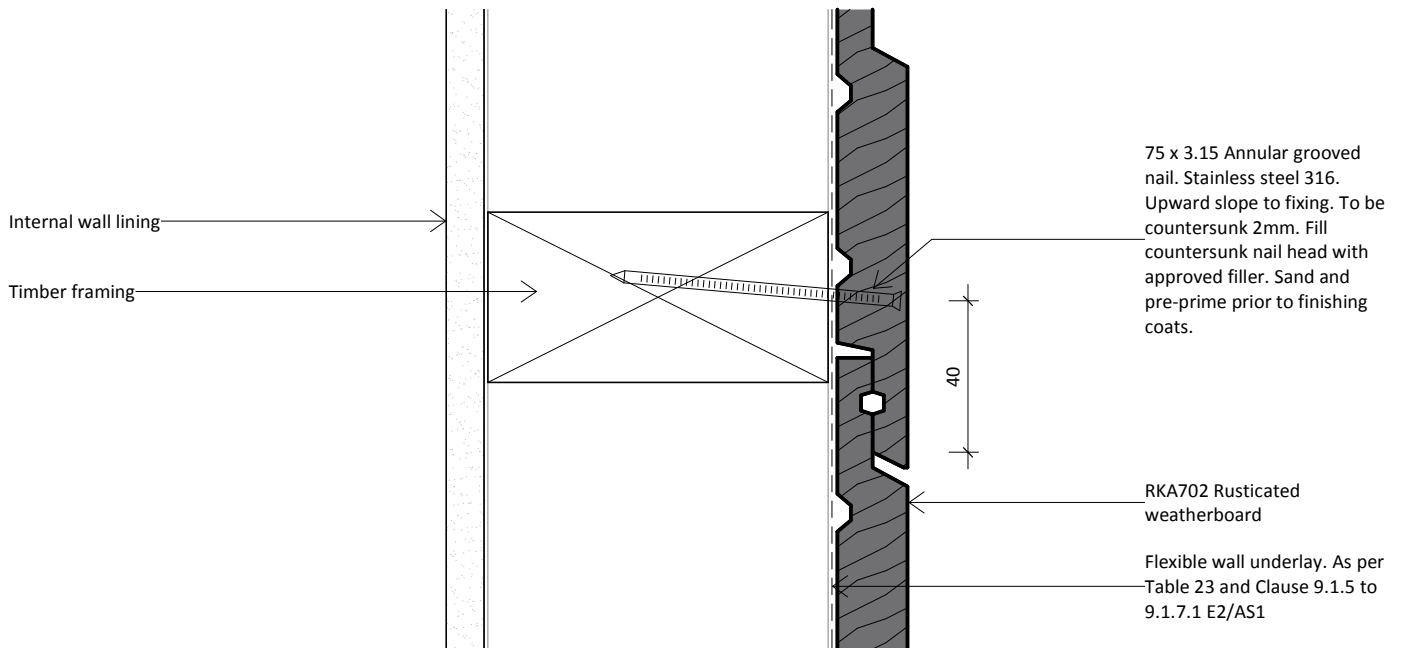

Vertical fixing



**Rosenfeld
Kidson**

www.rosenfeldkidson.co.nz

Auckland Branch:
513 Mt Wellington Highway
Mt Wellington, Auckland 1060
T. +64 9 573 0503
F. +64 9 573 0504

Christchurch Branch:
15 Edmonton Road, Hornby
Christchurch 8042
T. +64 3 349 3316
F. +64 3 349 3317

Postal address: PO Box 621, Shortland Street, Auckland 1140

Title **Nail Fixing Detail**

Drawing

RKR-D-47

Scale 1 : 2 @ A4

Date 20.11.2014