

6 Connect the water supply

All fittings are supplied apart from the isolation valve.

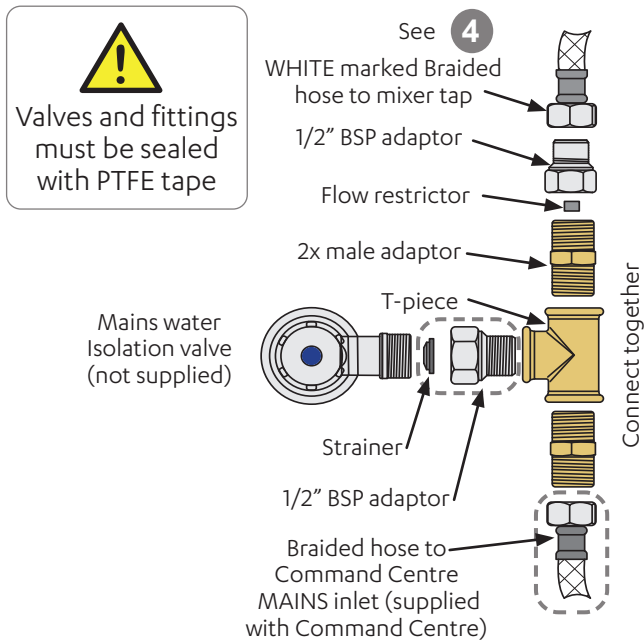

7 Command Centre connections

Mains In	Mains potable water supply.
USB	Connected to the Tap.
Boiling out	Red silicone tube from tap. Cut to length.
Chilled out	(BC) Blue silicone tube from tap, (BCS) Blue JG pipe from tap. Cut to length.
Vent	Clear silicone tube from tap. Cut to length.
Sparkling out	White JG pipe from tap. Cut to length.
Mixer in	Blue marked braided hose from mixer tap.
Mixer out	Red marked braided hose from mixer tap.

8 Cleaning and general maintenance

Wipe surfaces with a damp cloth and then wipe dry with a clean, dry cloth. Do not use disinfectant sprays without wiping dry afterwards.

Installation instructions

Zenith HydroTap



Classic / Classic Plus All-in-One Vented Mixer BC, BCS



Zenith Heaters Limited
 IRD/GST No. 95 640 729
 18 Kawakawa Place,
 Westgate, Auckland 0814
 New Zealand
 Ph +(64 9) 838 8612
 Free Call 0800 558 055
zenithwater.co.nz

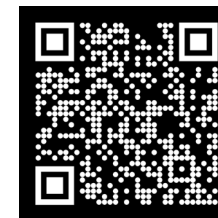

Visit our website to download the manuals

Using these instructions

Please refer to all safety and installation requirements detailed in the Quick start guide provided with the HydroTap Command Centre, and HydroTap Command Centre installation instructions found online, prior to installation of, or any change to, the complete system.



WARNING



Read the instructions

Before commencing the installation, download & read the HydroTap Command Centre installation instructions

Tools needed for tap installation

In addition to normal tools, the following (or equivalent equipment) will be required.

- 50mm diameter sheet metal hole punch for sinks.
- 50mm diameter hole saw for worktops.
- Tube spanner for fixing the tap assembly (supplied).



Be aware of the risks of hazards which could cause harm when using tools. Assess the risks before starting the installation.

Water supply pressure requirements

	Min - Max pressure, kPA (bar)
HydroTap	170 (1.7) - 700 (7.0)
Sparkling HydroTap	250 (2.5) - 700 (7.0)
Booster	200 (2.0) - 700 (7.0)

1 Positioning

Position the tap such that it dispenses into the sink bowl with clearance for a cup or tea pot.



Ensure that taps are positioned to minimise the risks of scalding when dispensing boiling water.

Position Command Centre and Tap as close together as possible. See below.

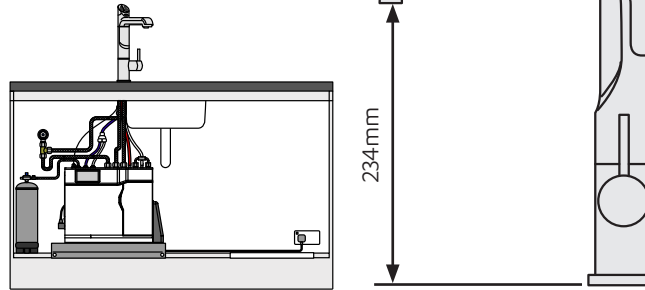

2 Cut the hole



- Cut a Ø50mm hole in the worktop / sink.

3 Familiarise yourself with the tap connections

Check the hose, USB, and pipe positions on the base clamp.

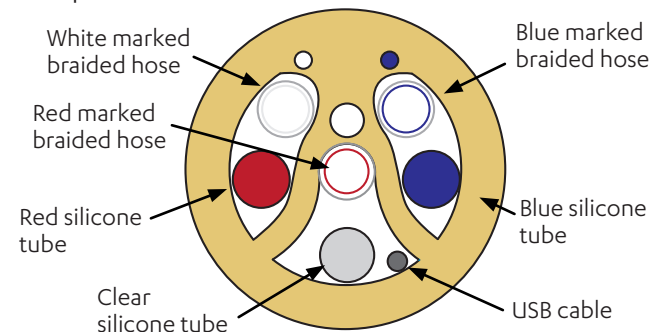

4 Familiarise yourself with the tap connections

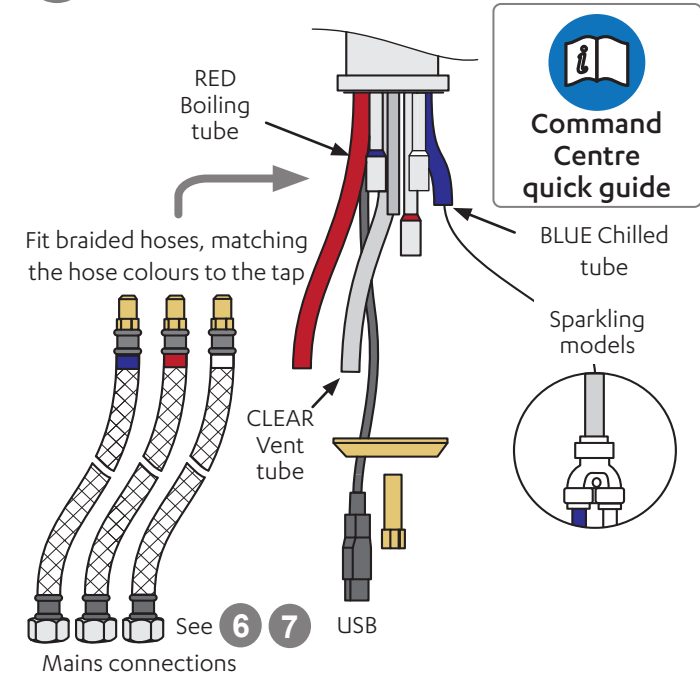

5 Mount and secure the tap

Use a tube spanner to secure the tap in place.

