

# Ulti Spiral Plus

## HIGH PERFORMANCE INSULATED SPIRAL DOOR

A high quality, fast, NZ-made insulated spiral door, maximising security, while maintaining the efficiencies of a short cycle time. Great for external applications, this low maintenance door ensures long term reliability.

### Speed Where it Matters

With opening and closing speeds of up to 2m/sec, this is one of the fastest insulated spiral doors available, reducing cycle times, and maximising energy savings, and productivity at your facility. The rapid-acting door ensures the security and integrity of your facility at all times - intruder proof, but fast.

### Energy Saving

The Ulti Spiral Plus has excellent thermal insulation, and acoustic properties, by using insulated dual-wall slats. This allows you to maximise your energy savings at even the biggest access points of your facility.



### Ideal for use in

- Foodgrade Warehousing
- Manufacturing Facilities
- Secure Institutions
- Government or Embassy
- Airports
- Car parking
- Apartment Parking
- Logistics

### Low Maintenance

The unique counterweighted drive system on the Ulti Spiral Plus, has no springs, and less moving parts, with a patented wheel-less, spiral track system. This means fewer maintenance headaches and more reliability, with an exceptional life span, giving you complete peace of mind, and maintenance savings. The slats of the Ulti Spiral Plus are guided in a spiral CNC routed groove, for fast opening speeds, low maintenance, and precise door travel. The no-contact spiral technology means there is no wear on the door sections, ensuring a great long-lasting appearance, and eliminating the transfer of dirt and grime from one panel to another.

### Safety Where it Matters

A Tower Beam Safety Sensor integrated into the Ulti Spiral Plus frame, monitors the closing zone of up to 2m high and reverses the door if any of the light beams are interrupted, meaning the door cannot close on any personnel, vehicle or object that might be in the door's path of travel.

### Customisable One Door System

By combining many features and benefits together into one door, the Ulti Spiral Plus removes the need to have both a slow secure roller shutter door and a high-speed fabric door in one doorway. You can also configure the door however you want by swapping out the solid core panels, with a ventilated option, or polycarbonate vision windows.



## STANDARD COMPLIANCE

|                       |  |                       |            |
|-----------------------|--|-----------------------|------------|
| Wind Loading          | Class 4 (up to 5000mm H x 5000mm W)<br>Class 3 (more than 25m <sup>2</sup> ) |                       |            |
| Water Permeability    | Class 3  | Wind Permeability     | Class 3    |
| Thermal Transmittance | 1.5 Wm <sup>2</sup> /K   | Safe Openings         | Yes        |
| Acoustic Rating       | 22dB   | Pressure Differential | Up to 70Pa |

## TECHNICAL SPECIFICATIONS

|                       |                     |
|-----------------------|---------------------|
| Application           | Internal/External   |
| Standard Size         | 4000mm H x 4000mm W |
| Minimum Size          | 1500mm H x 1500mm W |
| Maximum Size          | 6000mm H x 6000mm W |
| Opening Speed         | Up to 2m/s          |
| Closing Speed         | 0.5 m/s             |
| Operating Temperature | -5°C to +40°C       |

## STRUCTURE

|                |                  |
|----------------|------------------|
| Frame Material | Galvanised Steel |
| Frame Colour   | Galvanised       |

## SLAT

|             |  |
|-------------|--|
| Material    | 200mm H x 50mm D Dual Wall Aluminium Insulated Slats |
| Slat Colour | Anodised   |

## SPACE REQUIREMENTS minimum clearances

|          |                                     |
|----------|-------------------------------------|
| Headroom | 900mm < 4000mm H or 1300mm < 6000mm |
| Sideroom | 400mm (motor and non-motor side)    |

## DIMENSIONS

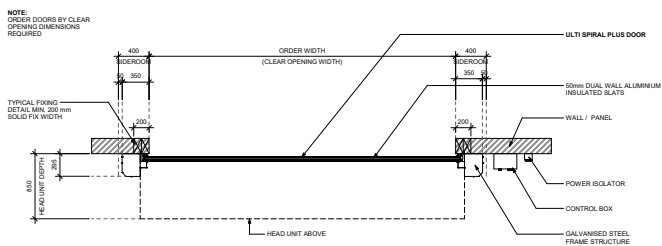

FLOOR PLAN VIEW

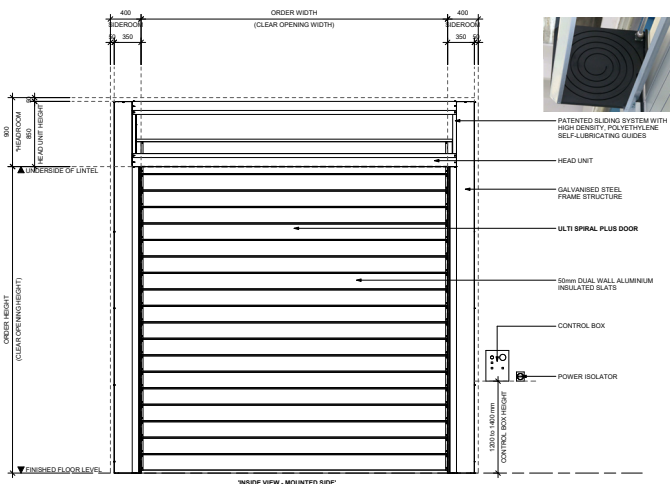

FRONT ELEVATION VIEW

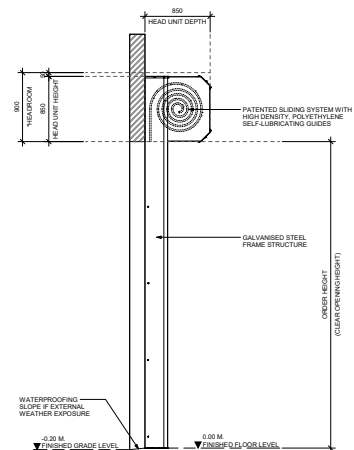

SIDE ELEVATION VIEW

## MOTORISATION

|                |   |
|----------------|---|
| Motor          | IP54 rated 2.2kW Heavy Duty 3phase Motor Drive and electromagnetic brake – RH mounted |
| Motor Position | RH Side   |
| Control Panel  | IP54 rated Metal Control box with inverter frequency controller – RH mounted          |
| Power Supply   | 400V; 3phase+N+E; 15Amp Rated adjacent to control box installed to right hand side    |

## ACTIVATIONS

|        |   |
|--------|---|
| Manual | Large Heavy-duty Mushroom Head push button, Push button and Emergency stop button fitted to control box |
|--------|---|

## STANDARD SAFETY INCLUSIONS

|   |                   |
|---|-------------------|
| 2000mm high Tower Beam Safety Sensors IP67 when door height >2500mm<br>LED Countdown Timer in Control box |                   |
| Emergency Egress  | Manual Hand Crank |

## WARRANTY

|                             |
|-----------------------------|
| 24 Months or 100,000 Cycles |
|-----------------------------|

## STANDARD INCLUSIONS

|   |
|---|
| Variable speed control<br>Patented Spiral Header Unit<br>Patented sliding system with high density polyethylene, self-lubricating guides<br>Perimeter seal system<br>Encoder control<br>50mm Spacer Frame for doors >5500mm W<br>Performance rated to 1,000,000 cycles with Ulti Planned Maintenance every 3 months |
|---|

## OPTIONAL FEATURES

|                  |  |
|------------------|--|
| Activations      | All Ulti Activation options can be applied                   |
| Safety           | Virtual Vision, Extended LED Countdown Timer                 |
| Slat Colours     | RAL3000, RAL6018, RAL5002, RAL9010                           |
| Vision Panels    | 1, 2, or 3 rows, custom rows available                       |
| Ventilated Panel | 1, 2, or 3 rows, custom rows available                       |
| Mounting Options | LH Control Box, LH Power Supply, Custom Control Box Position |