



MASONS
Designed Smart, Built Tough.

Enviro[®]

AAC Panel

MANUAL

MASONS ENVIRO FLOORING 75mm Panel

DISCLOSURE NOTE:

The information provided is for guide only and must be used along side professional architectural/structural design. Professional architectural/structural design takes preference with any conflicting areas of the building design. All documents or data downloaded from www.mpb.co.nz or emailed from MASONS Plastabrick Limited is the intellectual property of MASONS Plastabrick Limited. MASONS Plastabrick Limited takes no responsibility for any of the documents or data being used for any other purpose than for professional architectural/structural design.



DISCLAIMER

The information provided is for guide only and must be used along side professional architectural/structural design. Professional architectural/structural design takes preference with any conflicting areas of the building design. All documents or data downloaded from www.mpb.co.nz or emailed from MASONS Plastabrick Ltd is the intellectual property of MASONS Plastabrick Ltd. MASONS Plastabrick Ltd takes no responsibility for any of the documents or data being used for any other purpose than for professional architectural/structural design.

NOTES:

- * For 1.5kPa floor live loads, floor joists may be selected from the 2 kPa live load floor joist tables. For 2 kPa floor live loads, floor joists may be selected from 3kPa live load floor joist tables. Alternatively floor joists may be specifically designed for additional loads from ENVIRO Floor Panel (self weight 0.3kPa).
- * Fixing 75mm Tongue & Groove ENVIRO Floor Panel.
Alternative 14gx100 screws may be substituted for 14gx100 Bugle Head Type 17 screws
- * Provide fixings at 150mm centres to perimeter of floor and around openings.
- * Floor adhesive to be BOSTIK 'Safe Stud' or Sika 'Nailbond Premium'. Application, primers where required and preparation to be strictly in accordance with manufactures specification and requirements.

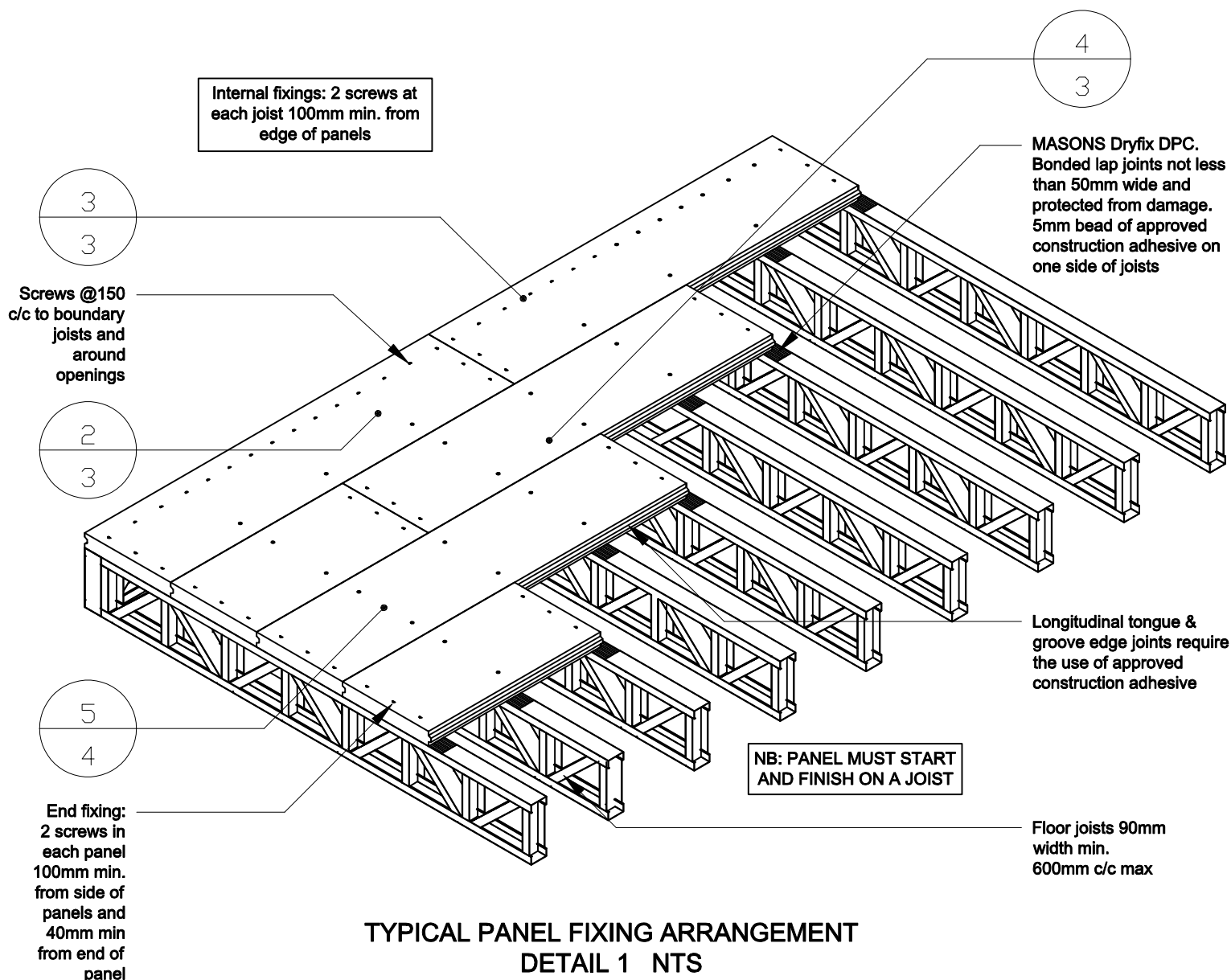

75mm Enviro Panel Floor Details (Steel/Galvanised Iron Framing)

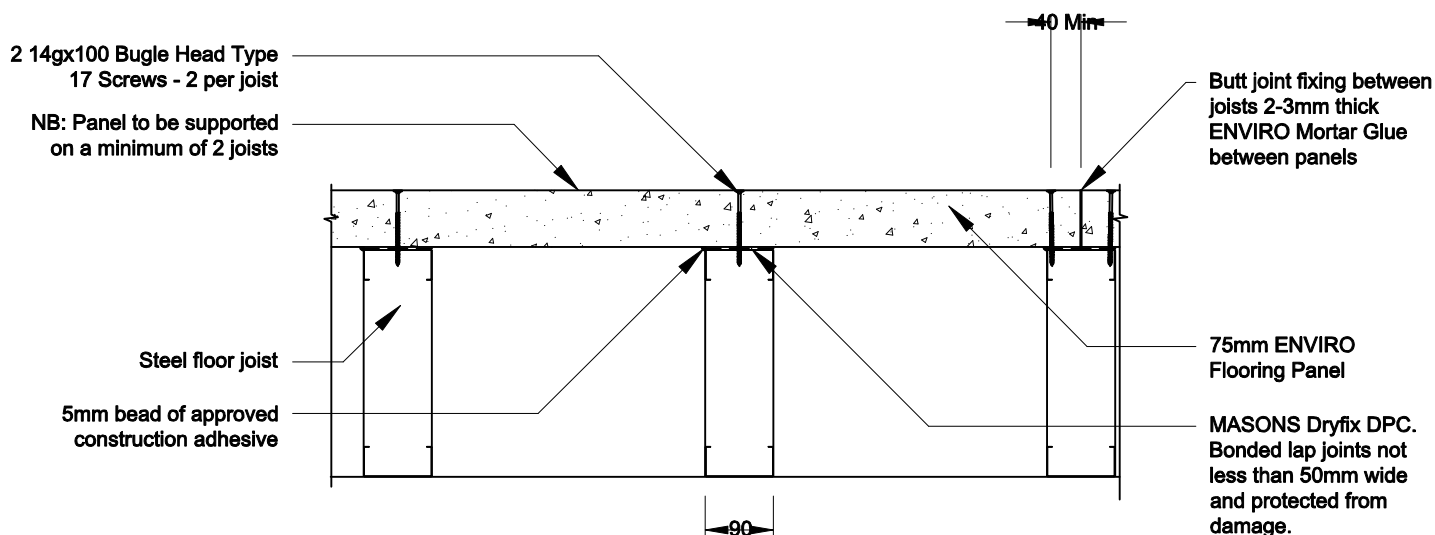
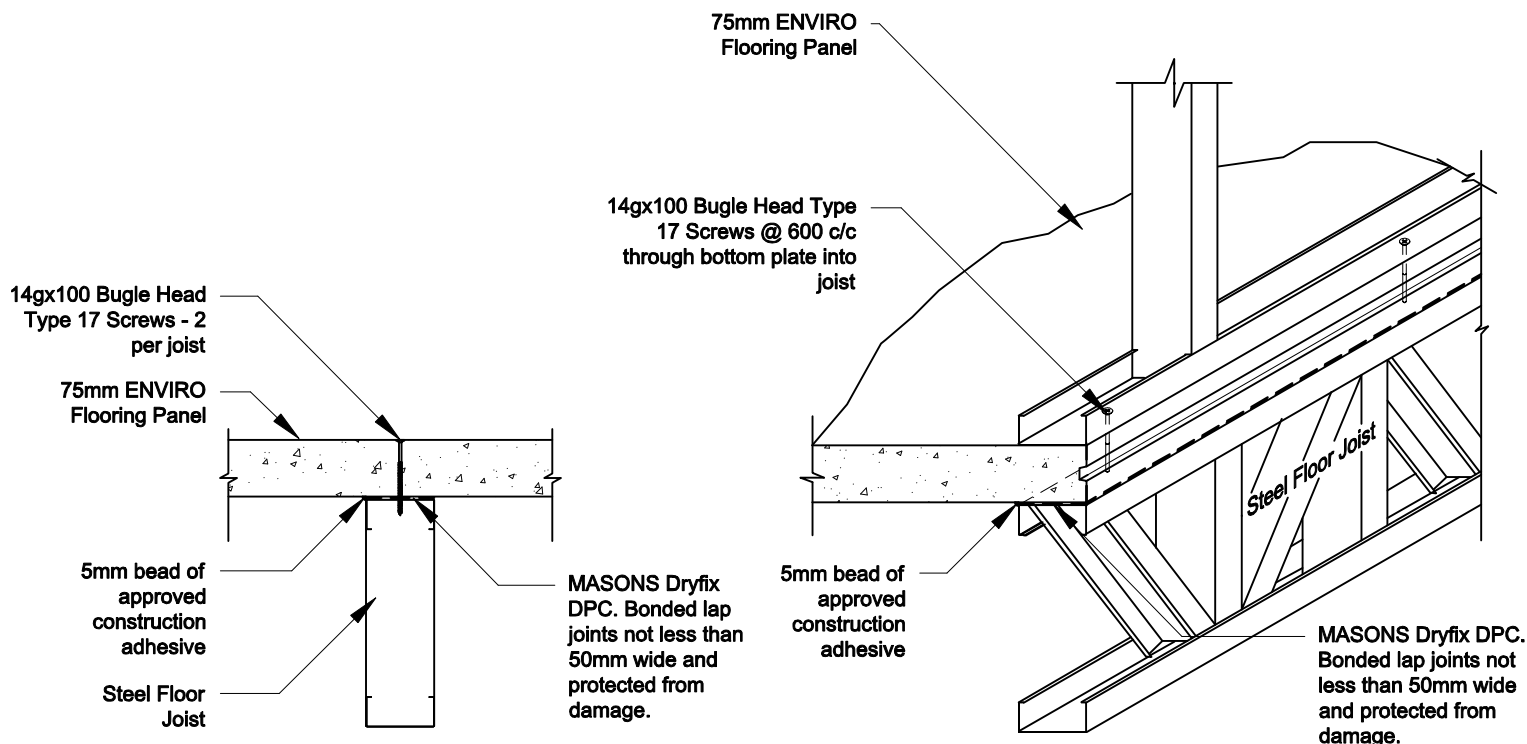

75mm Enviro Panel Floor Details (Steel/Galvanised Iron Framing)



MASONS
Designed Smart, Built Tough.

ThermalCrete®

Waterproof Panel

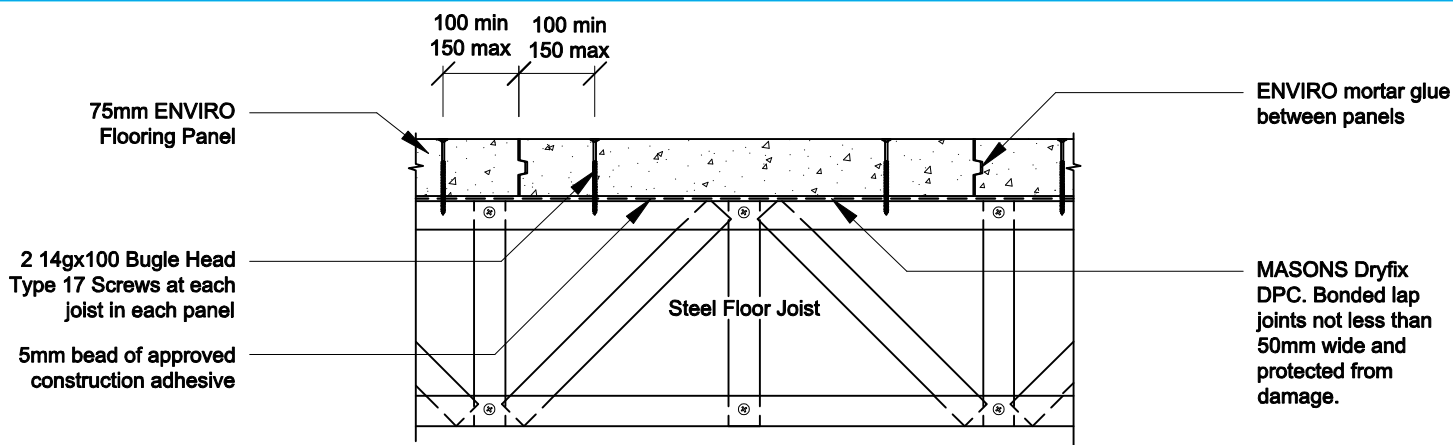

**TYPICAL PANEL INSTALLATION
DETAIL 5 Scale 1:10**

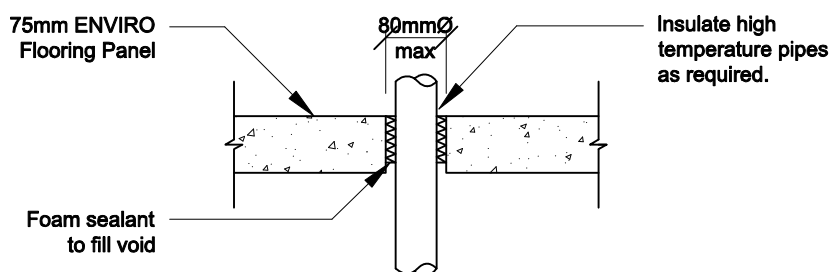

**TYPICAL PENETRATION
DETAIL 6 Scale 1:10**

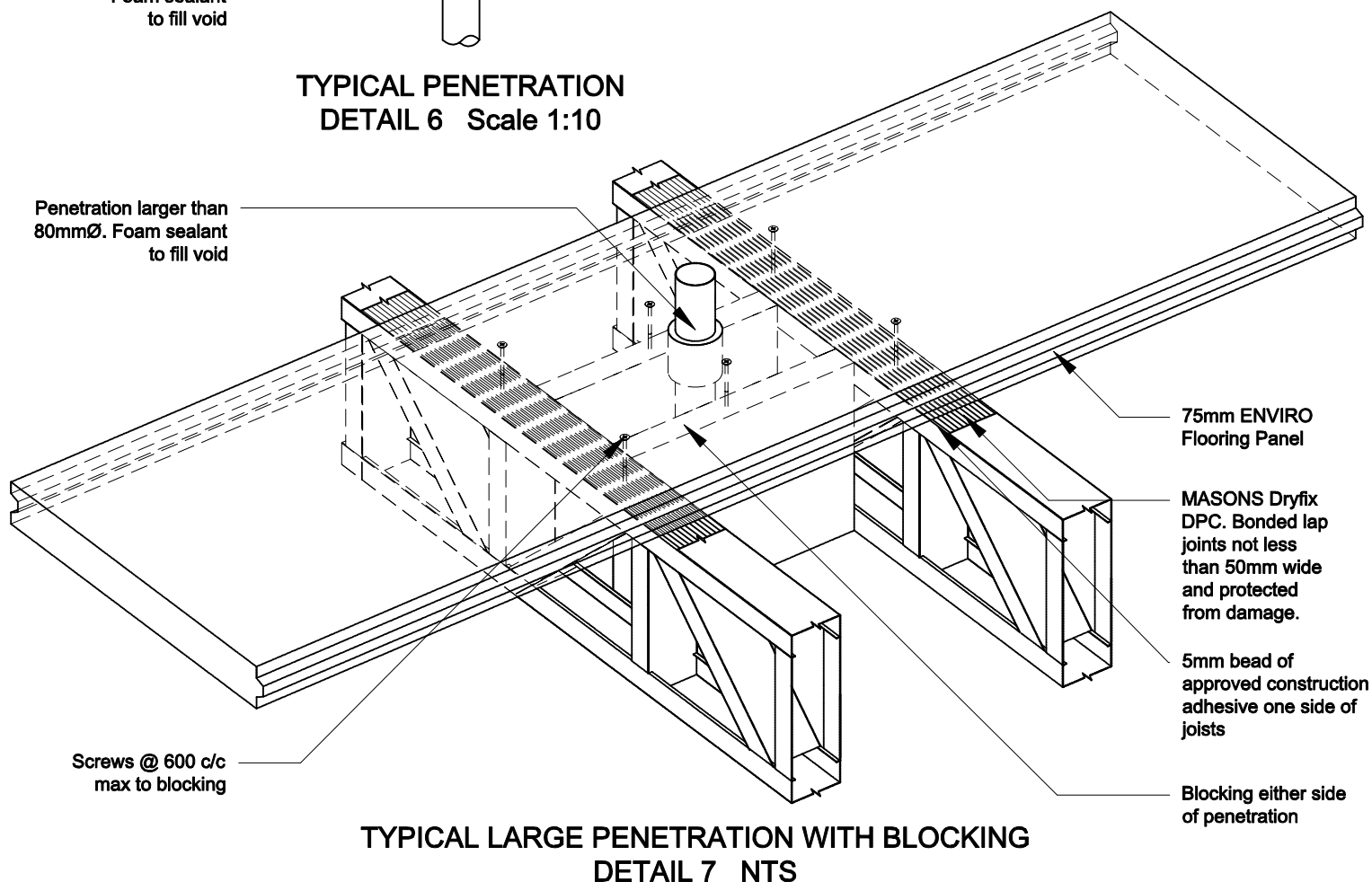

75mm Enviro Panel Floor Details (Steel/Galvanised Iron Framing)

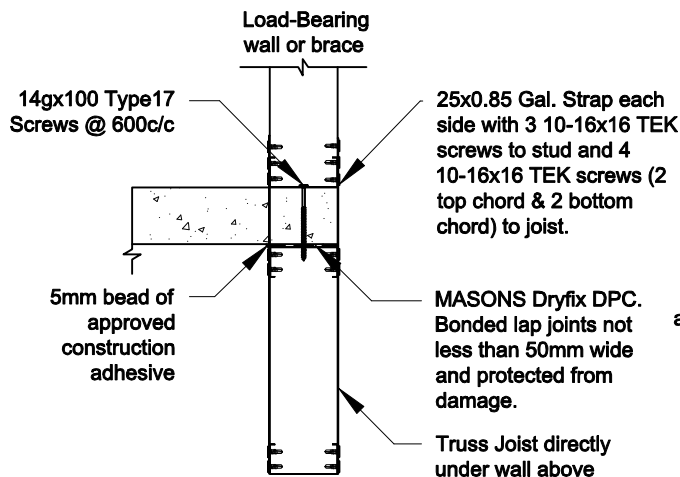

**EXTERNAL WALL ABOVE JOIST
12kN CONNECTOR
DETAIL 8 Scale 1:10**

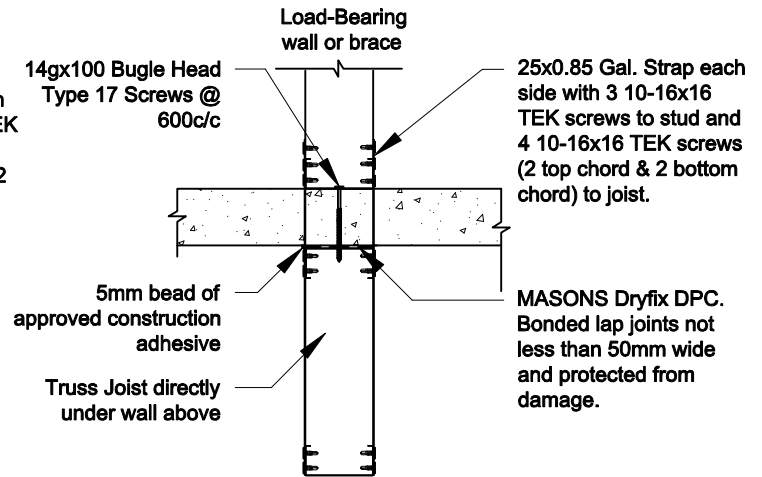

**INTERNAL WALL ABOVE JOIST
12kN CONNECTOR
DETAIL 9 Scale 1:10**

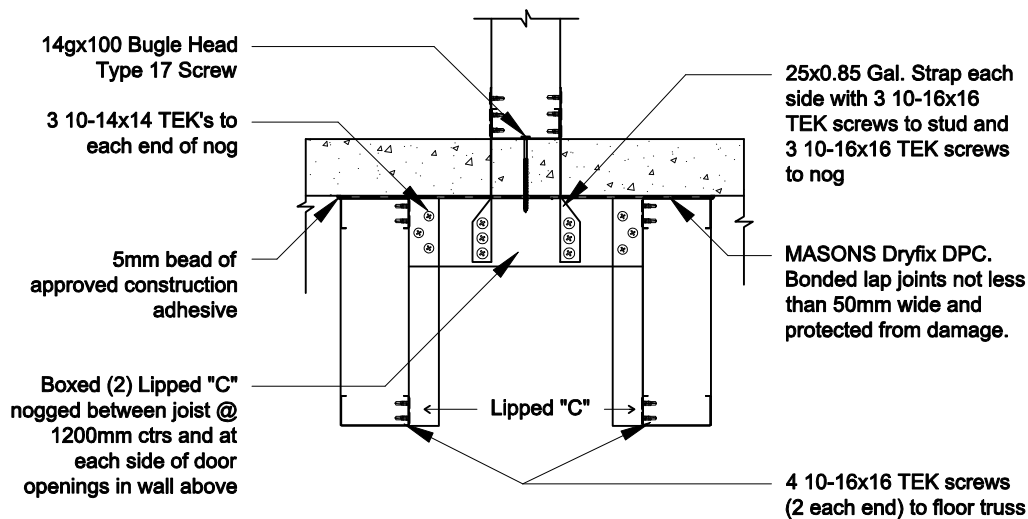

**INT/EXTERNAL WALL 12kN CONNECTOR OVER NOG
DETAIL 10 Scale 1:10**

75mm Enviro Panel Floor Details (Steel/Galvanised Iron Framing)

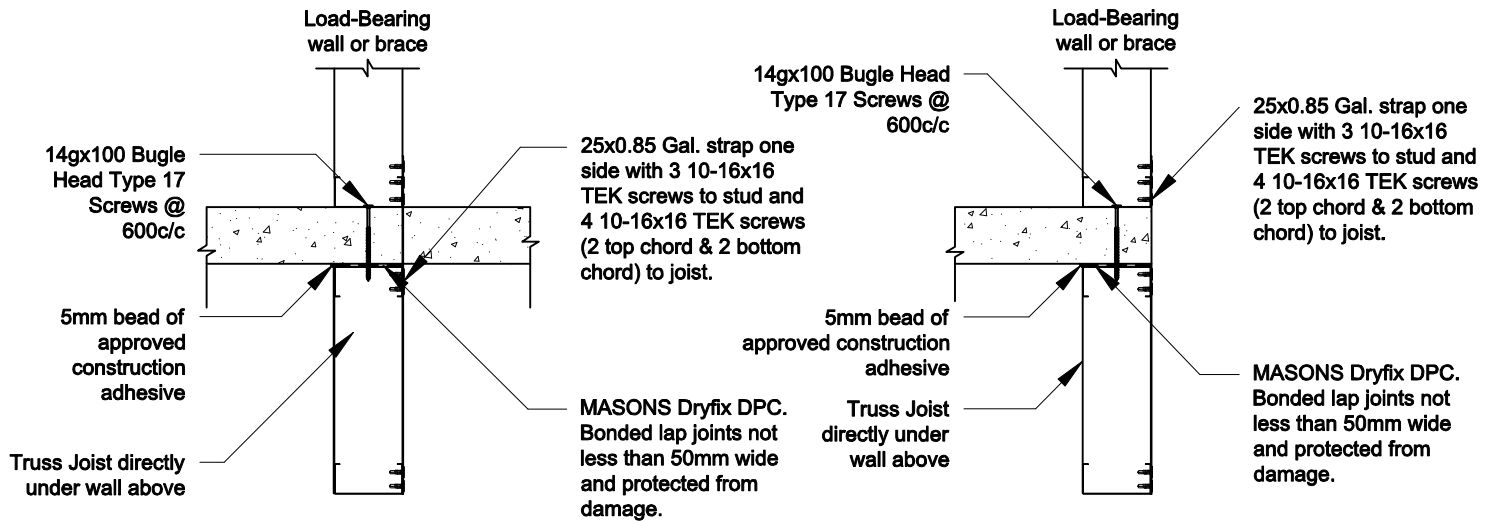

**INTERNAL WALL ABOVE JOIST
6kN CONNECTOR
DETAIL 11 Scale 1:10**

**EXTERNAL WALL ABOVE JOIST
6kN CONNECTOR
DETAIL 12 Scale 1:10**

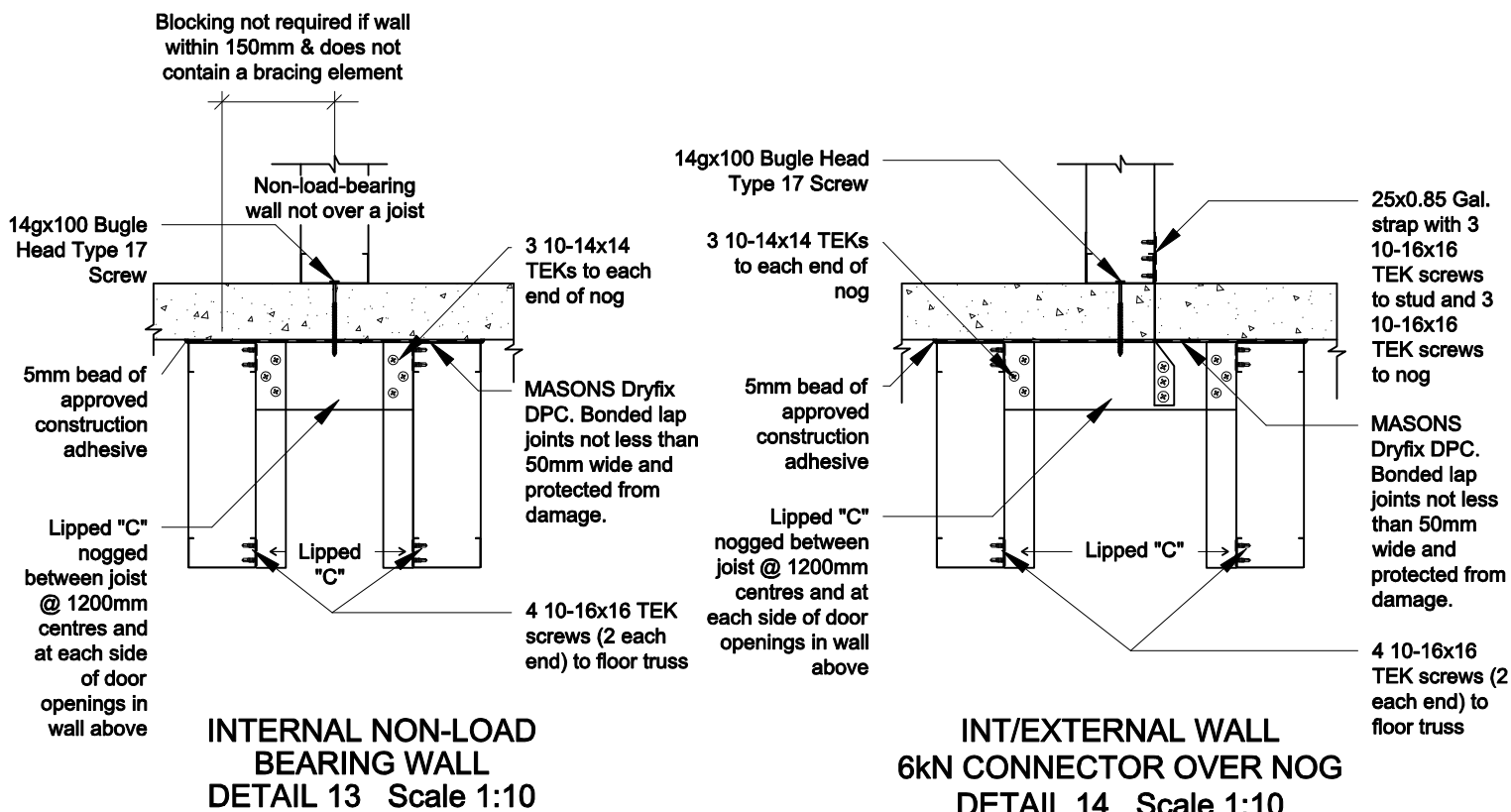

**INTERNAL NON-LOAD
BEARING WALL
DETAIL 13 Scale 1:10**

**INT/EXTERNAL WALL
6kN CONNECTOR OVER NOG
DETAIL 14 Scale 1:10**

75mm Enviro Panel Floor Details (Steel/Galvanised Iron Framing)