

'Safe Test' - Test Latch Model IBD-TL

- **Safe and Simple Testing Method.**
- **Test and Reset in minutes.**
- **AS 1851 - 2012 (Section 13) requires that you annually test Fire Dampers.**
- **To ensure the Life and Property saving function for which they are designed, all fire dampers should be drop tested after installation.**
- **Note: All IBD-FS dampers are fitted with 'Safe Test' Test Latch Links, as tested and certified.**

Each Holyoake Series IBD-FS Fire and Leakage Rated Damper is mechanically tested before it is allowed to leave the factory. In the event of damage occurring during transit, on site, or during installation, rendering any fire damper ineffective, failure to function will reveal any warping, track obstruction, or spring failure that may have occurred. This will require rectification, cleaning and removal of the obstacle, prior to retesting and handover.

The Holyoake 'Safe Test' Test Latch Model IBD-TL, is a latching device with a specially made fusible link, which, when the latch is released, swings clear and allows the curtain to close as if the link had parted under the influence of flame.

After testing, the curtain can be re-stacked and the same link clipped back into the latch, where it is again ready to be released in the event of a fire.

To Operate IBD-FS Dampers

1. Remove the duct access door (refer to Section K accessories section of this manual).
2. Using this access, reach in and remove the locking pin from the nearest latch.
3. Check that the locking pin is still in place on the other latch, so that the fusible link is retained by it, when released.
4. Check that the track is clear of any obstruction and keep hands clear.
5. Lift the latch lever and the curtain will rapidly close.
6. Reload the curtain and swing the fusible link back into place in the latch.
7. Replace the locking pin in the latch.
8. Replace the duct access door.

To Operate IBD-FS Dampers below minimum heights shown.

1. Remove the duct access door (refer to Section K accessories section of this manual).
2. Remove locking pin from both sides.
3. Check that the track is clear of any obstruction and keep hands clear.
4. Support the blade pack, lift both latch levers and remove fusible link.
5. Release the blade pack and the curtain will rapidly close.
6. Reload the curtain and support the blade pack, whilst replacing the fusible link locating pins into both latches.
7. Replace both locking pins.
8. Replace the duct access door.

Minimum Duct Height for dampers fitted with Electro Thermal Resettable Links	
Duct Connection Style	Minimum Duct Height
A	210
B	150
C	150
CR	150
CO	150

For testing purposes, all dampers below these heights will require removal of link and blades dropped manually.

Note: Take suitable safety precautions for Hand and Eye protection.

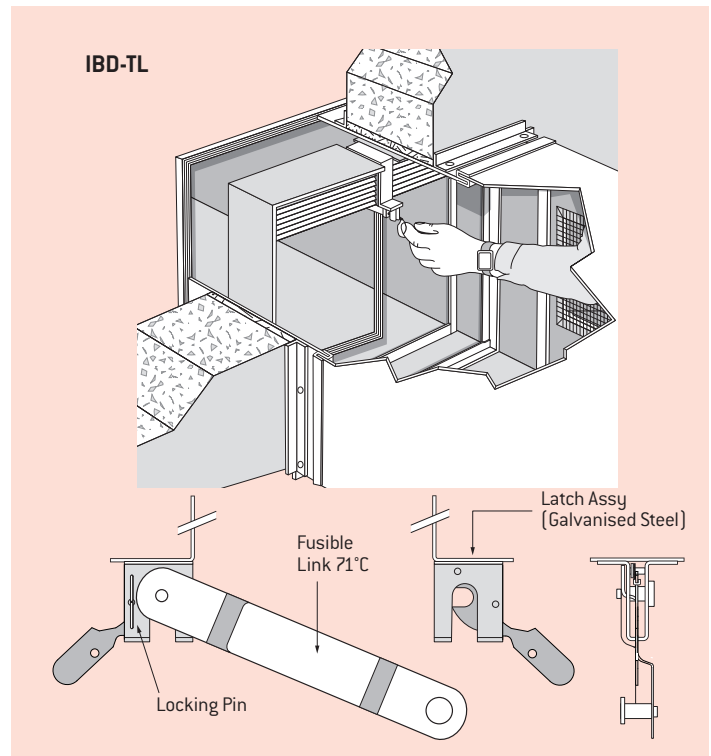

Electro Thermal Resettable Links Model: IBD-ETR

All Holyoake IBD-FS type fire and leakage rated dampers, are available with optional Electro Thermal Resettable Link mechanisms.

Contact your local Holyoake branch for details.

24 V AC or DC Supply Electro Thermal Resettable Release.
Max 30 Sec Release and 60 Sec Reset, with integral 71 Degrees C Thermal Resettable Release.

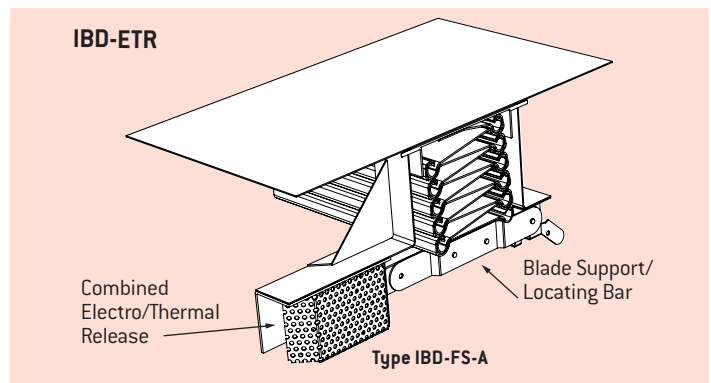

Maximum Damper size with IBD-ETR is 750 x 750 mm.

