



MASONS
Designed Smart, Built Tough.

40 Below™

Flashing Tape

Rigid Air Barrier “Seam Tape” Application Guide

Product Description

40 Below™ Flashing Tape is a self adhesive flashing tape that has been tested and deemed compatible to work as a joint protection between the **Rigid Air Barrier**. Allowing the **Rigid Air Barrier** to operate within its design Specification.

- For a risk score between 0-20 in accordance with NZBC Acceptable Solution E2/AS1
- Passed NZS3604 Building Wind Zones up to and including ‘**Very High**’.

Advantages

- Simple installation
- 1.2mm thick adhesive layer
- Reliable and dependable weather tightness



Masons recommend 75mm flashing tape for Rigid Air Barrier installations

Masons 40 Below™ flashing tape	Roll Sizes	Masons Code
40 Below™ flashing tape 75mm	H 75mm x L 25m	40Below75x25

This product can be obtained from New Zealand's leading Building Supply Merchants:
If you have any issues in sourcing this product please contact Masons on 0800 522 533

NB. Check for product compatibility with your Rigid Air Barrier supplier before installation.



MASONS
Designed Smart, Built Tough.

40 Below™ Flashing Tape is a self adhesive flashing tape that has been tested and deemed compatible to work as a joint protection between the Rigid Air Barrier.

Order your FREE sample today! Call 0800 522 533

or visit: www.mpb.co.nz



MASONS
Designed Smart, Built Tough.

40 Below™

Flashing Tape

Installation:

Masons 40 Below™ Flashing Tape must be installed in accordance with these instructions.

1. **Rigid Air Barrier** requires to be secured and fixed into position.
2. To ensure maximum adhesion of the tape, the substrate surface needs to be clean, dry and free from any dust or other contaminants.

Flush joint

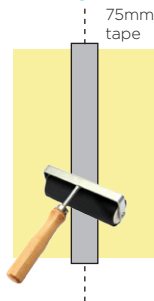

3. Position the 75mm 40 Below™ tape so that the seam between the **Rigid Air Barrier** is at the center of the tape line.
The 40 Below™ Tape needs to completely cover the joint.
4. After application cut tape to the required length
5. To ensure that the 40 Below™ Tape is properly bedded against the panels and at the edges, press the tape into position with a hard roller tool.

External Corner

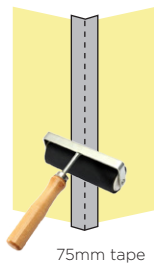

3. Cut the 75mm 40 Below™ Tape to length (add 50mm either side for movement).
4. Position half of the 40 Below™ Tape on one wall and 'roll' it around the corner and press it into position on the adjacent wall.
5. After application cut tape to the required length
6. Finish by pressing 40 Below™ Tape into position with a hard roller tool.

Internal Corner

fold 75mm tape

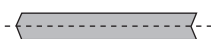

peel back half

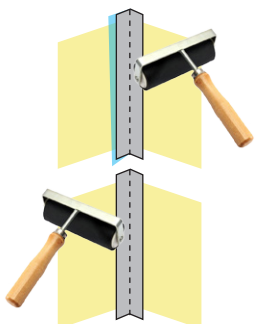

3. Cut the 75mm 40 Below™ Tape to length (add 50mm for movement).
4. Pre-fold the 40 Below™ Tape in half (length ways)
5. Peel back half of the protection strip to the crease line.
6. Position the 40 Below™ Tape on one wall, press it securely and tight in towards the corner. Treat with a hard roller.
7. Peel the protection strip now completely off and press firmly outwards from the corner.
7. Finish by pressing 40 Below™ Tape into position with a hard roller tool.

40 Below™ Flashing Tape must not be stretched when joining 2 sections of tape, overlap by 100mm or more.