

NOVA 2000 LED BULKHEAD
LHT1188 - Black
LHT1189 - White

NOVA 2800 LED BULKHEAD
LHT1190 - Black
LHT1191 - White

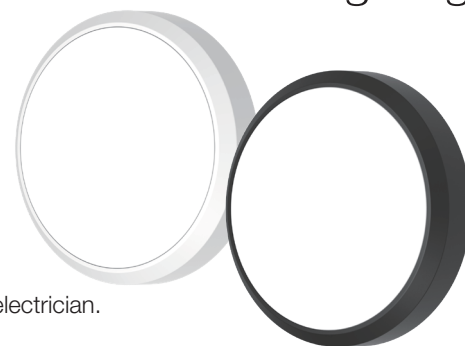

Thank you for purchasing the Simx Lighting Nova LED Bulkhead. It requires a 220V-240 AC power supply to operate and should be installed by a registered electrician. Please read this manual before installation and retain for future reference.

! IMPORTANT

This product is suitable for use only with a supply voltage of 220-240V AC, 50Hz.

All electrical work must be carried out in accordance with local and national electrical codes as applicable. We strongly recommend that this light fitting is installed by a registered electrician.

Always switch power off prior to installation. A means of mains power isolation must be installed in the circuit for the purpose of safe access for any internal cleaning, recalibration, or maintenance.

This light fitting is not intended for use by persons (including children) with reduced physical, sensory or mental capabilities, or lack of experience and knowledge, unless they have been given supervision or instruction concerning use of the appliance by a person responsible for their safety. Young children should be supervised to ensure that they do not play with the appliance.

Any changes or modifications made or attempted to this product, without the prior written approval of the manufacturer, will void any and all stated warranties.

TECHNICAL SPECIFICATIONS

	NOVA 2000	NOVA 2800
Power Source	220-240V AC 50Hz	
Wattage	12-20W (4 settings)	18-28W (4 settings)
Luminous Flux (Maximum)	Without Trim	2000 lm
	With White Trim	1750 lm
	With Black Trim	1600 lm
LED Colour Selectable	3000K, 4000K, 5700K	
CRI	≥80	
PFC	>0.9, flicking free	
IP Rating	IP66	
IK Rating	IK10	
Safety	Class II	
Mounting	Ceiling / Wall	
Construction	Anti-UV Polycarbonate	
Operating Temperature	-20°C to +40°C	
Warranty	5 years	

DIMENSIONS (mm)

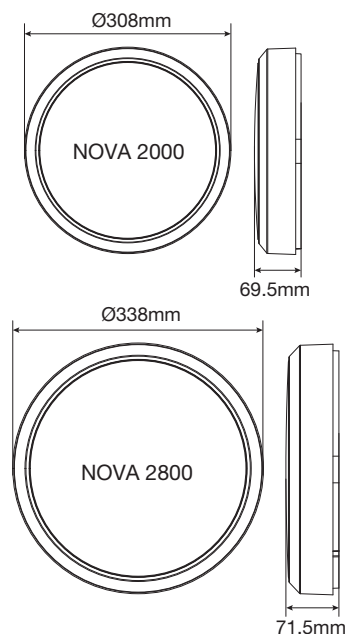

INSTALLATION

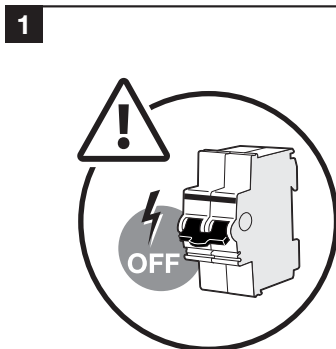

Be sure to switch off the electric supply before any installation.

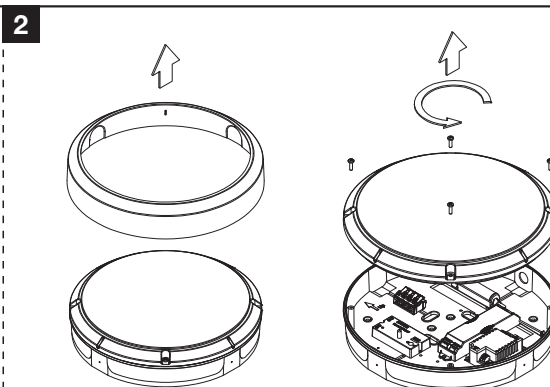

Unclip front trim and unscrew diffuser from the base.

Disconnect cable connector between the driver and LED array for easier installation.

INSTALLATION

3

- Pierce central gland to feed incoming supply cable.
- Alternatively, there are 4 side mount locations for surface cabling. Drill the side wall at the marked locations and gland conduit to maintain IP rating. Maximum 20mm diameter hole.
- Mount base to ceiling or wall securely. Utilise the mounting hole locations only.
- The supplied rubber gaskets must be used to maintain IP rating when installing and use appropriate screws to suit the gaskets and selected mounting holes.
- Terminate the cabling to match the termination box label.
- Reconnect cable connector between the driver and LED array.

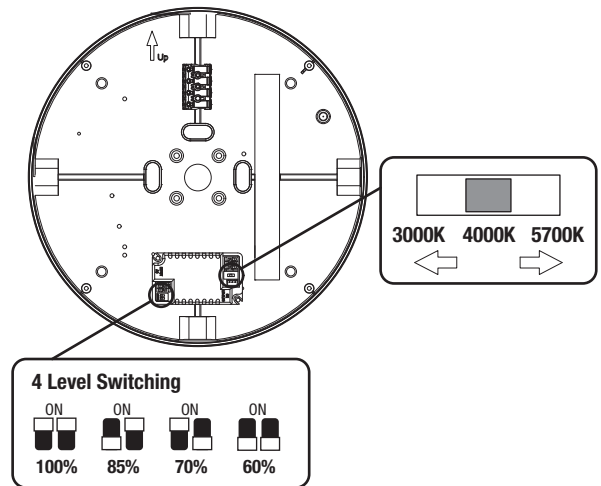
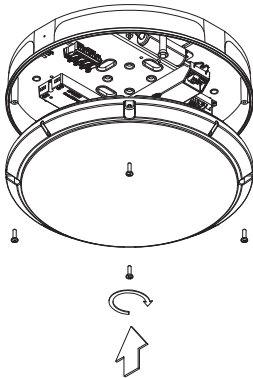

Fig.1 - Colour temperature and lumen output adjustment.

4



-  Do not overtighten. Use the lowest torque setting.

5

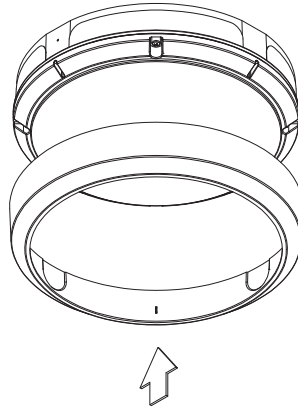

Use of outer trim is optional.

6

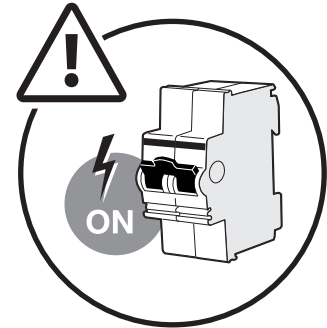

Reconnect power supply to check operation.

MANUFACTURERS EXTENDED WARRANTY

This product is guaranteed by SIMX Ltd and Ventair Pty Ltd for 5 years from the date of purchase against faulty materials or workmanship which affects its designed ability to operate. During this period if the product has a defect of this nature it will be repaired or replaced free of charge by SIMX with the same item, or a similar one of higher specification.

ON CONDITION THAT:

- The buyer returns it to the seller from whom it was bought, freight paid.
- The product has been bought by the user (ie. a receipt/sales invoice is produced as proof of purchase).
- The product has not been misused or handled carelessly, installed in any way contrary to the installation instructions, or installed in any unusually exposed or harsh environmental conditions.

This guarantee excludes liability for discolouration and/or delamination of paint or plastic, or any user serviceable parts. It does not confer any rights other than those expressly set out above and does not cover any claims for consequential loss or damage.

Our Goods come with guarantees that cannot be excluded under either Australian, or New Zealand, Consumer Law.

You are entitled to a replacement or refund for a major failure and for compensation for any other reasonably foreseeable loss or damage. You are also entitled to have the Goods repaired or replaced if the Goods fail to be of acceptable quality and the failure does not amount to a major failure.



Distributed in New Zealand by Simx Ltd

Ph: +64 9 259 1660
 Technical Support Ph: +64 9 259 1662
 e: sales@simx.co.nz | www.simx.co.nz



Distributed in Australia by Ventair Pty Ltd

4 Capital Place, Carrum Downs
 3201 VIC, AUSTRALIA
 Technical Support: 1300 665 926
 e: info@ventair.com.au | www.ventair.com.au