

BGC

Fibre Cement

BGC - DB3
Secure every 2nd stud (at sheet edge) to bottom plate with 130x90x130x25x1.0mm galv mild steel "U" bracket, fixed each end with 6/30x2.5mm galvanised flat head nails.

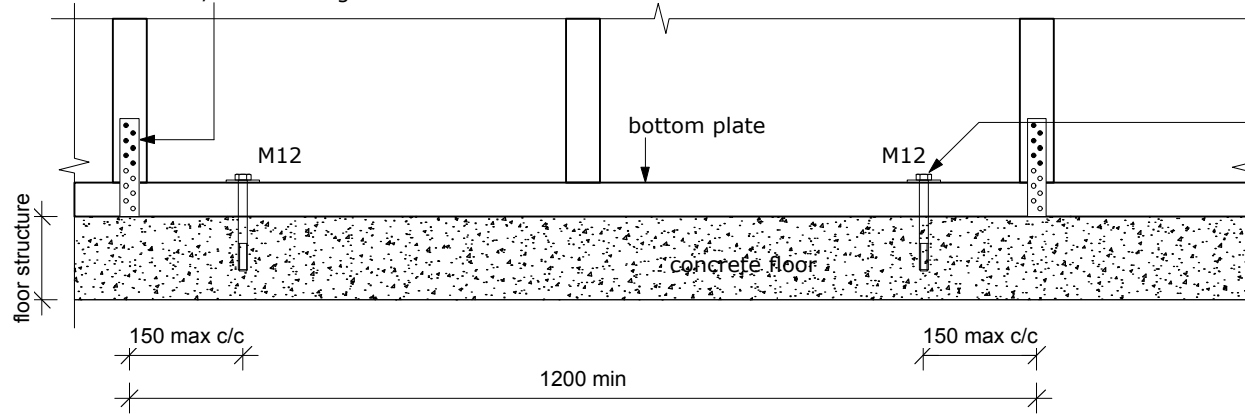

M12 x 150mm HD Galv hold down bolts with 50x50x3.0mm HD Galv sq washer, or proprietary anchors with a minimum characteristic pullout strength of 15kN and embedded at least 75mm into concrete foundation. Hold downs to be fixed max 150mm from panel ends

**Brace Panel Hold Down - Construction Detail
BGC 6.0mm Durabarrier™ - DB3 (1200mm Min)
Concrete Floor**

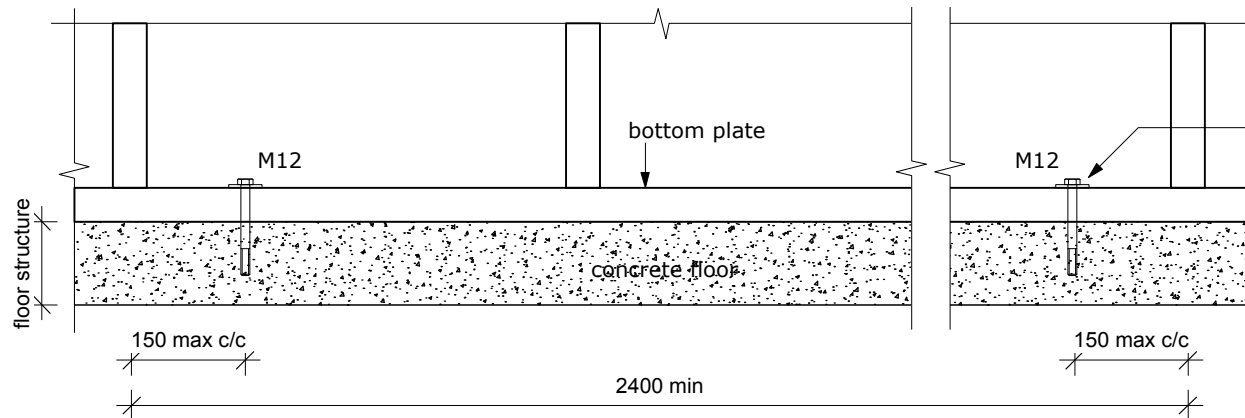

M12 x 150mm HD Galv hold down bolts with 50x50x3.0mm HD Galv sq washer, or proprietary anchors with a minimum characteristic pullout strength of 15kN and embedded at least 75mm into concrete foundation. Hold downs to be fixed max 150mm from panel ends

**Brace Panel Hold Down - Construction Detail
BGC 6.0mm Durabarrier™ - DB4 (2400mm Min)
Concrete Floor**

PROFILE BGC Durabarrier™

DATE May 2011

DETAIL Concrete Floor - Brace Element Hold Down

SCALE 1:10 @ A4

DETAIL NO. DB 10