



**Cover shows ClosetPro Premium 395 Range.  
Also available, the Classic 395 Range  
and the Ultra 550 Range**

 **JURALCO**

**JURALCO CLOSETPRO® MELAMINE  
WARDROBE SYSTEM**

ISSUE 2-23 v2

8.04.26

## Juralco ClosetPro® Melamine Wardrobe System - General

The HomePlus Melamine Wardrobe Storage Systems are designed and manufactured in New Zealand to meet your individual requirements.

The system combines anodised aluminium components and Melamine cabinetry to make a range of storage configurations for your home for requirements. Each unit is available as standard or custom made and installed in your home by trained professionals.

Shelving in White, 16mm Particle Board or Coloured 18mm MDF PVC Edging is standard and a strong metal Soft close mechanism, drawer sides and thick drawer bottoms add up to quality that lasts a lifetime.



**Classic 395  
Wall hung**



**Premium 395  
Free Standing**



**Ultra 550  
Free Standing**

### General Description

- Easily erected, simple and stylish. Complements modern, contemporary homes
- Available as Wall mounted or Floor Standing units
- Multiple uses including wardrobe organizing, Garage Shelving, Laundry Shelving and Linen Storage
- Simple Camlock Cabinet assembly.
- Finish for all units, White or Coloured
- Standard board thickness 16mm White and 18mm Coloured, all with matching 1mm PVC Edging

### For Wall Mounted Classic 395

- Heights. Wardrobes to 1800mm (but mounted off the floor to suit).
- Widths, Drawers. 300, 400, 500 and 600mm wide, with Soft close (Drawer fronts overhang Wardrobe verticals)
- Widths, Shelving. 300, 400, 500 and 600mm, but Width can be Custom made to suit
- Widths. Total Wardrobe systems available as custom-made Width to your dimensions
- Depths. All units 395mm Deep
- Mounting. Adjustable Hanging Track and Wall Suspension system

### For Free Standing Premium 395 and Ultra 550

- Heights. Wardrobes all 2076mm + Toe kick height (70-100mm)
- Widths, Drawers. 400, 500, 600, 700 and 800mm wide, with Soft close (Drawer fronts inside Wardrobe verticals)
- Widths, Shelving. Width can be Custom made to suit.
- Widths. Total Wardrobe systems available as custom-made Width to your dimensions
- Mounting. Adjustable/levelling Feet. Choice of Toe kick heights 70-100mm
- Ends. Ends as Open (ie not finishing at a Wall), Wall (ie finishing at a Wall) and Corner (ie 90deg Corner Junction)

### Colours

- Juralco Standard Colours for 18mm MDF. All from the Prime Melamine range.  
Other colours are available on request for an extra charge.  
Black Forest Oak - Timberland. French Oak - Velvet. Hamptons Elm - Velvet. Hickory Walnut - Timberland  
Smoked Eucalyptus - Timberland. Premium Oak - Woodgrain. Premium Ply - Velvet

All pages © Copyright Juralco Aluminium Building Products Ltd, 2023

## Juralco ClosetPro® Melamine Wardrobe System - General

### Index

Heading	Pages	Description. <a href="#">Use the Bookmarks</a> <a href="#">List to jump to selected pages</a>
Classic 395 Wardrobe	4 - 6	Shows Wall mounted Panels and some Assemblies
	7 - 9	Shows Loose panel sizes, drilling
	10	Order Forms
Premium 395 and Ultra 550 Wardrobes	11 - 15	Shows Free Standing Wardrobes and some Assemblies + Add ons
	16 - 17	Order Forms
	18	Shows Kick Stand components
Classic 395, Premium 395 and Ultra 550 Wardrobes	19 - 20	General Components
	21 - 22	Shows Amedo Components
	23	Shows Gennaro Alpha Components (Ultra 550 only)
	24	General Installation tips
	25 - 26	Wardrobe Assembly, Installation Tips



**Classic 395 - Wall Mounted - All supplied as predrilled loose panels**

All these as White (16mm) or Coloured (18mm) Melamine

Description, Size	Part No	Pack
RH Mitre End Panel, 1800mm x 395mm	H/CO/ENDR/18	2
LH Mitre End Panel, 1800mm x 395mm	H/CO/ENDL/18	2
RH Mitre Panel, 1200mm x 395mm	H/CO/ENDR/12	2
LH Mitre End Panel, 1200mm x 395mm	H/CO/ENDL/12	2
RH Mitre Panel, 600mm x 395mm	H/CO/ENDR/6	2
LH Mitre End Panel, 600mm x 395mm	H/CO/ENDL/6	2
Top Panel, 2400mm x 295mm (Edge banded Ends and Front)	H/CO/TOP/24	4

MITRE  
PANEL  
UNITS

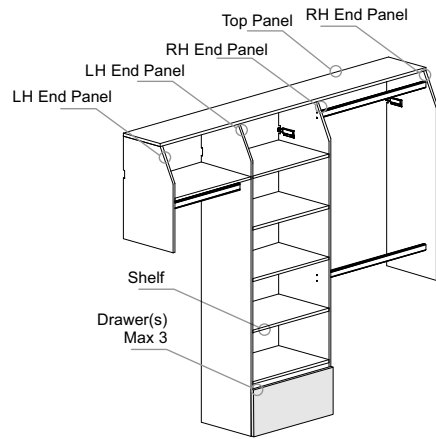

All these as White (16mm) or Coloured (18mm) Melamine

Description, Size	Part No	Pack
RH Square End Panel, 1800mm x 395mm	H/CO/SQENDR/18	2
LH Square End Panel, 1800mm x 395mm	H/CO/SQENDL/18	2
RH Square End Panel, 1200mm x 395mm	H/CO/SQENDR/12	2
LH Square End Panel, 1200mm x 395mm	H/CO/SQENDL/12	2
RH Square End Panel, 600mm x 395mm	H/CO/SQENDR/6	2
LH Square End Panel, 600mm x 395mm	H/CO/SQENDL/6	2
RH Square End Panel, 300mm x 395mm	H/CO/SQENDR/3	2
LH Square End Panel, 300mm x 395mm	H/CO/SQENDL/3	2
Top Panel, 2400mm x 395mm (Edge banded Ends and Front)	H/CO/SHELF/24	3

SQUARE  
PANEL  
UNITS

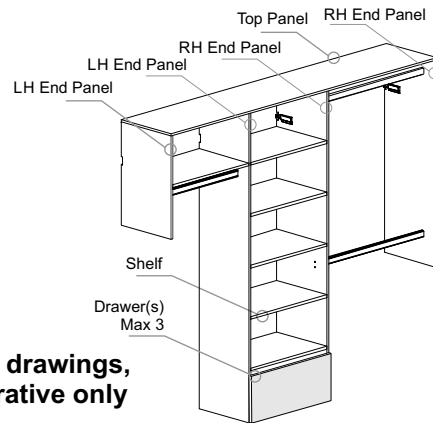

These drawings,  
illustrative only

Description, Size	Part No	Pack
RH Blank Panel, 2400mm x 395mm	H/CO/SQENDR/BLANK	2
LH Blank Panel, 2400mm x 395mm	H/CO/SQENDL/BLANK	2
RH Adjustable Shelf Panel, 1800mm x 395mm	H/CO/SQENDR/18/AD	2
LH Adjustable Shelf Panel, 1800mm x 395mm	H/CO/SQENDL/18/AD	2
Division Panel, 300mm x 295mm	H/CO/DIV300	10

SQUARE  
PANELS  
ONLY

Description, Size	Part No	Pack
Shelf 1200mm wide x 395mm	H/CO/SHELF/12	4
Shelf 1000mm wide x 395mm	H/CO/SHELF/10	4
Shelf 800mm wide x 395mm	H/CO/SHELF/8	4
Shelf 600mm wide x 395mm	H/CO/SHELF/6	10
Shelf 500mm wide x 395mm	H/CO/SHELF/5	10
Shelf 400mm wide x 395mm	H/CO/SHELF/4	10
Shelf 300mm wide x 395mm	H/CO/SHELF/3	10

SHELF

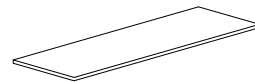

Description, Size	Part No	Pack
Drawer 800mm wide, soft close	H/CO/DRAW/8	1
Drawer 600mm wide, soft close	H/CO/DRAW/6	1
Drawer 500mm wide, soft close	H/CO/DRAW/5	1
Drawer 400mm wide, soft close	H/CO/DRAW/4	1
Drawer 300mm wide, soft close	H/CO/DRAW/3	1

DRAWER

- All Drawers Soft Close as standard.
- Drawer to suit internal cabinet width 300,400,500,600 and 800mm
- Drawer fronts project past the Wardrobe body

Description, Size	Part No	Pack
Wall Mounted Shelf, 2400mm x 395mm	H/CO/SHELF/24	3
Shelf Ends, 100mm x 395mm	H/CO/ENDS/1	10
Back Rail, 1000mm x 2400mm	H/CO/BR/24	10

WALL  
MOUNTED  
SHELF

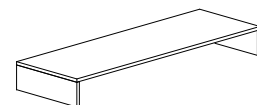

**Classic 395 - Wall Mounted - All supplied as predrilled loose panels**

**Drawer Tower - Wall hung**

- 4 x drawers, 3 x Storage Shelves
- Finish White or Coloured.

- All units supplied as stand alone single unit
- All units 395mm deep, 1800mm high
- Available as 400mm, 500mm 600mm wide (internal width)
- All Drawers with Soft close as standard

**1800mm Ends and 4 x drawers supplied as a pack.  
Top and Shelves to be ordered separately**

3 Shelf, 4 Drawers - Description	Part No	Pack
Mitre Top, 1800 x 400 wide x 395 deep	H/CO/C4DR/4/WH	1
Mitre Top, 1800 x 500 wide x 395 deep	H/CO/C4DR/5/WH	1
Mitre Top, 1800 x 600 wide x 395 deep	H/CO/C4DR/6/WH	1

MITRE  
PANEL  
UNITS

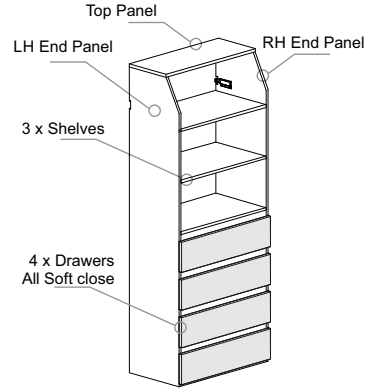

3 Shelf, 4 Drawers - Description	Part No	Pack
Square Top, 1800 x 400 wide x 395 deep	H/CO/C4DRSQ/4/WH	1
Square Top, 1800 x 500 wide x 395 deep	H/CO/C4DRSQ/5/WH	1
Square Top, 1800 x 600 wide x 395 deep	H/CO/C4DRSQ/6/WH	1

SQUARE  
PANEL  
UNITS

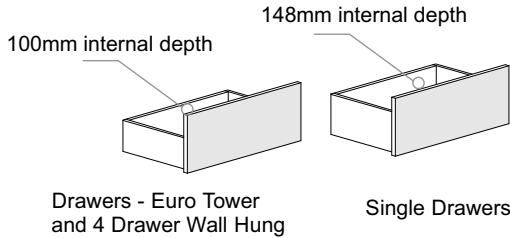
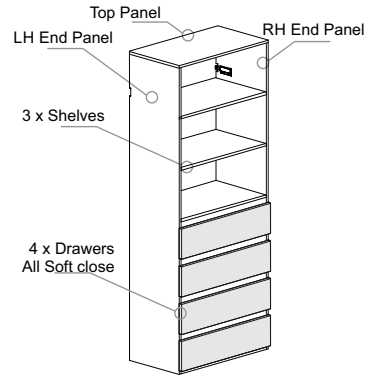

**Classic 395 - Free standing - All supplied as predrilled loose panels**

**Drawer Tower - Freestanding**

H/CO/MT/4DRW/WHT

- 4 x drawers, 4 x Storage Shelves
- Finish White only

All units supplied as stand alone single unit  
 All units 395mm deep, 632mm wide, 2090mm high  
 All Drawers with Soft close as standard  
 Skirting Board notch 12x60mm

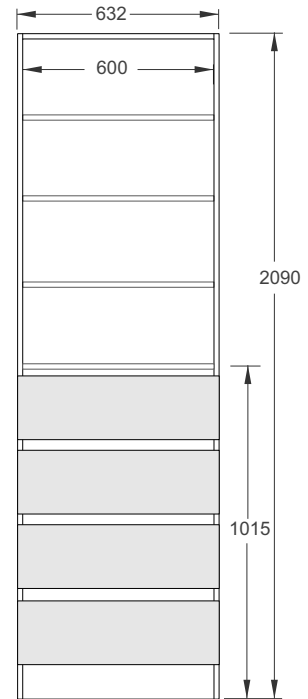
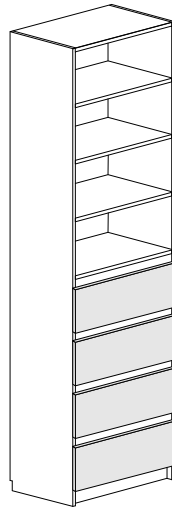

All in White Melamine  
 Depth = 395mm

**Drawer Tower + 6 x Shelf Unit**

H/CO/MT/4DRWSUM/W

- 4 x drawers, 6 x Storage Shelves
- Finish White only

Drawer Tower supplied as stand alone single unit  
 395mm deep x 508mm wide x 2090mm high  
 4 x Drawers with Soft close as standard  
 Skirting Board notch 12x60mm

Shelf Unit supplied loose.  
 395mm deep x 500mm wide x 1800mm high  
 7 x Shelves + 1 x End Panel  
 Note: One end Panel attached to Wall  
 (Hanging Rail and Suspension bracket not supplied)

This End Panel  
 Attached to Hanging Rail  
 as per normal

LH End Panel

4 x Drawer Tower  
 Freestanding

4 x Drawers  
 All Soft close

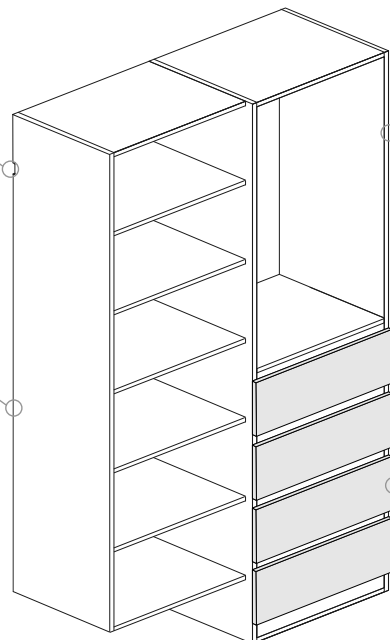

**Classic 395 - Wall Mounted Panels**

**All these as White (16mm) or Coloured (18mm) Melamine**

Drilling Layouts  
Miter End Panel 1800mm x 395mm

Miter End Panel 1200mm x 395mm

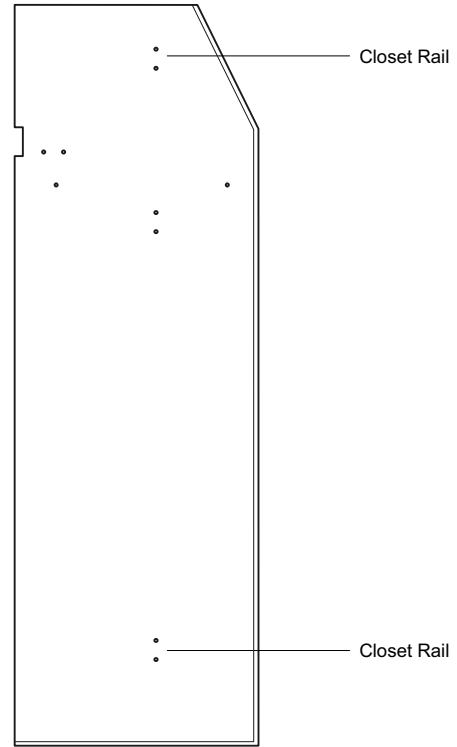
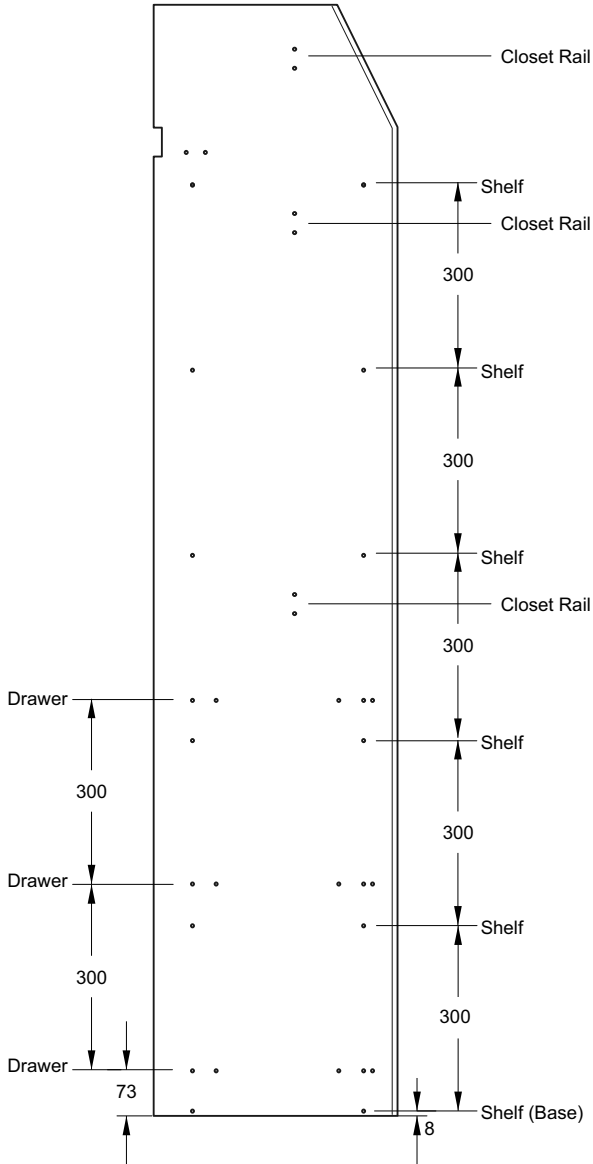

Mitre End Panel 600mm x 395mm

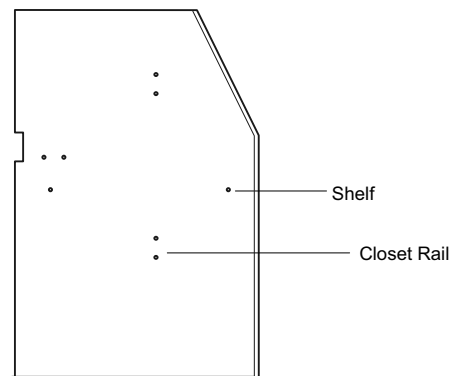

**Classic 395 - Wall Mounted Panels**

**All these as White (16mm) or Coloured (18mm) Melamine**

Drilling Layouts  
Square End Panel 1800mm x 395mm

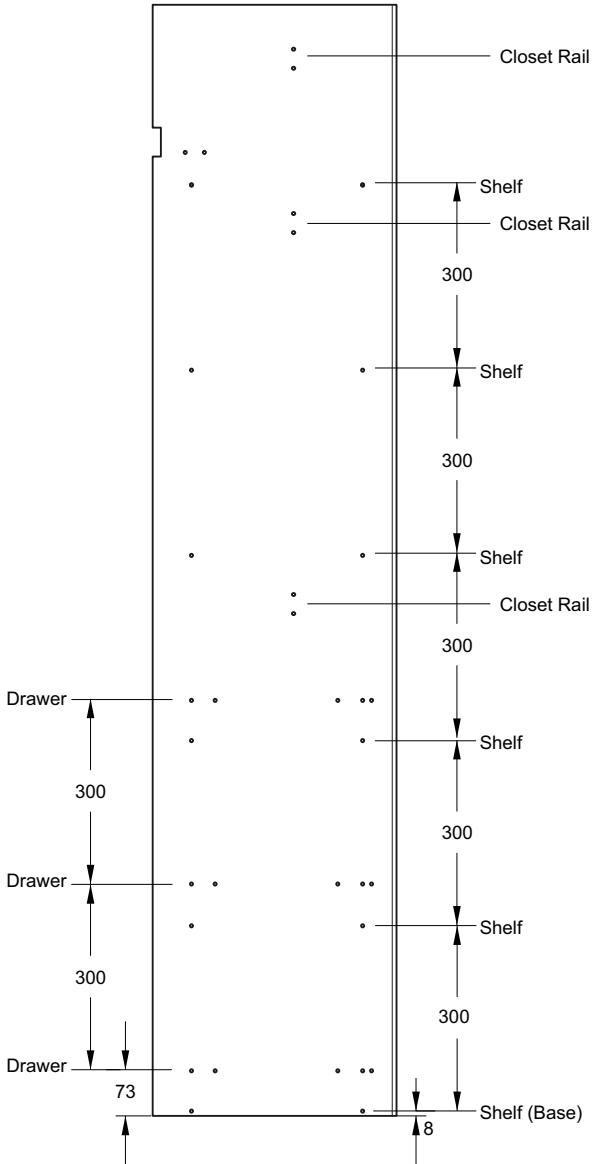

Drilling Layouts  
Square End Panel 1200mm x 395mm

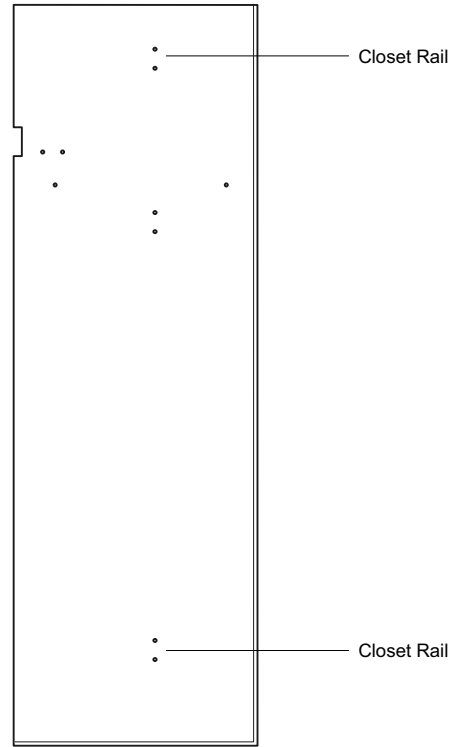

Drilling Layouts  
Square End Panel 600mm x 395mm

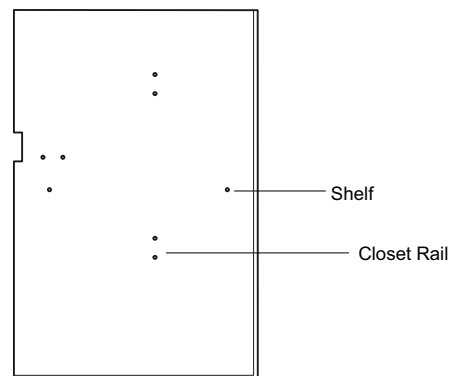

**Juralco ClosetPro® Melamine Wardrobe System - Classic 395 Range  
Square End Panel Drilling Layouts**

**Classic 395 - Wall Mounted Panels**

**All these as White (16mm) or Coloured (18mm) Melamine**

Drilling Layouts  
Division Panel 300mm x 295mm

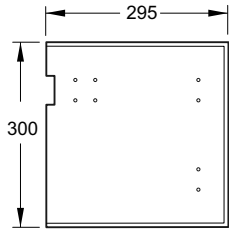

H/CO/DIV300/WHT

Drilling Layouts  
Square End Panel 300mm x 395mm

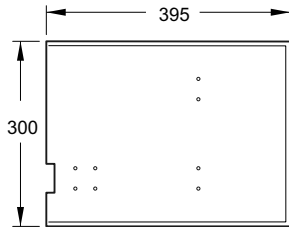
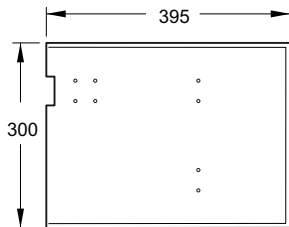

H/CO/SQENDL/3/WH  
H/CO/SQENDR/3/WH

Drilling Layouts  
Adjustable Shelf Panel 1800mm x 395mm



Part No H/CO/SQENDL/18/AD  
and Part No H/CO/SQENDR/18/AD

Drilling Layouts  
Blank Panel 2400mm x 395mm

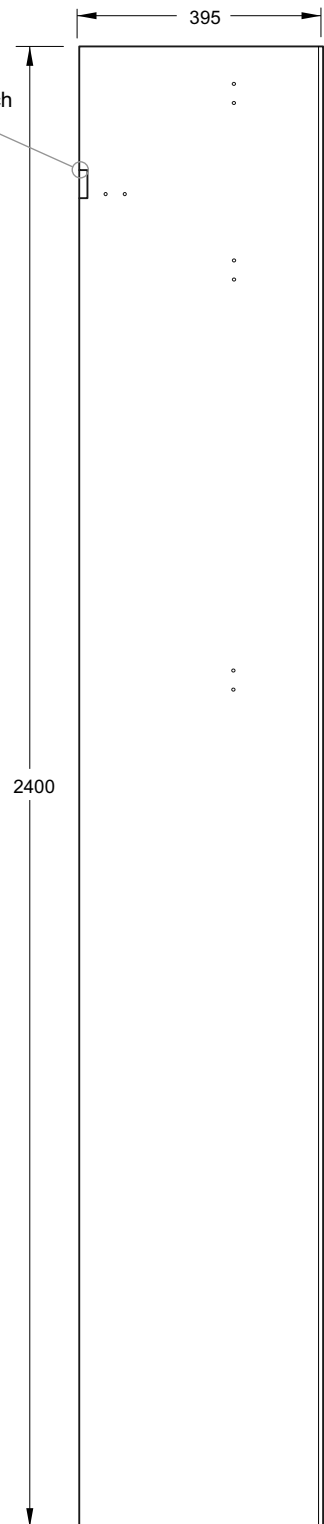

Part No H/CO/SQENDL/BLNK  
and Part No H/CO/SQENDR/BLNK

**Juralco ClosetPro® Melamine Wardrobe System - Classic 395 - ORDER FORM**

Customer	Date
<b>Classic 395 Wall Mounted Wardrobes</b>	Order No
	Enter Customer details above. Enter details into boxes below. Enter No required. Then Scan and email to <a href="mailto:chchsales@juralco.co.nz">chchsales@juralco.co.nz</a>

<b>1</b>	<b>Materials.</b> -Tick to select. - Enter Colour	Material <input type="checkbox"/> Check	Material - If Coloured, specify <input type="checkbox"/> Check
		<table border="1" style="width:100%; border-collapse: collapse;"> <tr> <td style="width:50%; padding: 2px;">16mm White</td> <td style="width:50%; padding: 2px;">18mm Coloured</td> </tr> </table>	16mm White
16mm White	18mm Coloured		

**2 Components - Panels, Shelves, Drawers**  
- Enter No required. No Entry = 0

Mitre End Panels <input type="checkbox"/> Check	Part No	Pack	Select
RH End Panel, 1800 x 395	H/CO/ENDR/18	2	
LH End Panel, 1800 x 395	H/CO/ENDL/18	2	
RH Panel, 1200 x 395	H/CO/ENDR/12	2	
LH End Panel, 1200 x 395	H/CO/ENDL/12	2	
RH Panel, 600 x 395	H/CO/ENDR/6	2	
LH End Panel, 600 x 395	H/CO/ENDL/6	2	
Top Panel, 2400 x 295 (Edge banded Ends and Front)	H/CO/TOP/24	4	

Square End Panels <input type="checkbox"/> Check	Part No	Pack	Select
RH End Panel, 1800 x 395	H/CO/SQENDR/18	2	
LH End Panel, 1800 x 395	H/CO/SQENDL/18	2	
RH End Panel, 1200 x 395	H/CO/SQENDR/12	2	
LH End Panel, 1200 x 395	H/CO/SQENDL/12	2	
RH End Panel, 600 x 395	H/CO/SQENDR/6	2	
LH End Panel, 600 x 395	H/CO/SQENDL/6	2	
RH End Panel, 300 x 395	H/CO/SQENDR/3	2	
LH End Panel, 300 x 395	H/CO/SQENDL/3	2	
Top Panel, 2400 x 395 (Edge banded Ends and Front)	H/CO/SHELF/24	3	

Misc Panels <input type="checkbox"/> Check	Part No	Pack	Select
RH Blank Panel, 2400 x 395	H/CO/SQENDR/BLANK	2	
LH Blank Panel, 2400 x 395	H/CO/SQENDL/BLANK	2	
RH Adjustable Shelf Panel, 1800mm x 395mm	H/CO/SQENDR/18/AD	2	
LH Adjustable Shelf Panel, 1800mm x 395mm	H/CO/SQENDL/18/AD	2	
Division Panel, 300 x 295	H/CO/DIV300	10	
Wall Mounted Shelf, 2400mm x 395mm	H/CO/SHELF/24	3	
Wall Shelf Ends, 100x 395	H/CO/ENDS/1	10	
Back Rail, 1000 x 2400	H/CO/BR/24	10	

Shelves <input type="checkbox"/> Check	Part No	Pack	Select
Shelf 1200 wide x 395	H/CO/SHELF/12	4	
Shelf 1000 wide x 395	H/CO/SHELF/10	4	
Shelf 800 wide x 395	H/CO/SHELF/8	4	
Shelf 600 wide x 395	H/CO/SHELF/6	10	
Shelf 500 wide x 395	H/CO/SHELF/5	10	
Shelf 400 wide x 395	H/CO/SHELF/4	10	
Shelf 300 wide x 395	H/CO/SHELF/3	10	

Drawers <input type="checkbox"/> Check	Part No	Pack	Select
Drawer 800 wide, soft close	H/CO/DRAW/8	1	
Drawer 600 wide, soft close	H/CO/DRAW/6	1	
Drawer 500 wide, soft close	H/CO/DRAW/5	1	
Drawer 400 wide, soft close	H/CO/DRAW/4	1	
Drawer 300 wide, soft close	H/CO/DRAW/3	1	

**3 Drawer Tower - Wall hung, Single units** - 4 x drawers, 3 x Storage Shelves as standard- Top Panel and Shelves to be ordered separately  
- Enter No required. No Entry = 0

Mitre End Panels <input type="checkbox"/> Check	Part No	Pack	Select
Tower, 1800 x 400 wide x 395	H/CO/C4DR/4/WH	1	
Tower, 1800 x 500 wide x 395	H/CO/C4DR/5/WH	1	
Tower, 1800 x 600 wide x 395	H/CO/C4DR/6/WH	1	

Square End Panels <input type="checkbox"/> Check	Part No	Pack	Select
Tower, 1800 x 400 wide x 395	H/CO/C4DRSQ/4/WH	1	
Tower, 1800 x 500 wide x 395	H/CO/C4DRSQ/5/WH	1	
Tower, 1800 x 600 wide x 395	H/CO/C4DRSQ/6/WH	1	

**4 Components - Brackets, Connectors, Misc**  
- Enter No required. No Entry = 0

Hanger Rail + Bracket <input type="checkbox"/> Check	Part No	Pack	Select
Hanger Rail x 4.8m	H/8386/4.8	1	
Suspension Bracket, Black (pairs)	H/CO8386SB/BLK	100	
Suspension Bracket White (Pairs)	H/CO8386SB/WH	100	

Closet Rails + Brackets <input type="checkbox"/> Check	Part No	Pack	Select
Standard Closet Rail x 3m	H/8384/3	1	
Heavy Duty Closet Rail x 3m	H/8384HD/3	1	
Closet J Rail x 4.8m	H/8385/4.8	1	
Closet Rail Socket (Chrome)	H/CO8384RS/CP	100	
Closet Rail Centre Support	H/CO8384RS/CP	1	

Screws + Connectors <input type="checkbox"/> Check	Part No	Pack	Select
Drawer Runner Screw	H/CO8398	100	
Suspension Bracket Screw	H/CO8387	100	
Connector Bolt (with Thread)	H/CO8382	100	
Connector Bolt (no Thread)	H/CO8384CS/CP	100	
Connector Housing (internal tighten)	H/CO8381	100	
Connector Housing (push fit)	H/CO8383	100	

Misc Components <input type="checkbox"/> Check	Part No	Pack	Select
Corner Connector (incl clip on cover)	H/CO8390	20	
Angle Brkt	H/CO8394	20	
End Panel Bracket	H/CO8400	20	
Cover Cap 13mm dia (push in)	H/CO8388	??	
Cover Cap 13mm dia (adhesive)	H/CO8401	100	
Cover Cap 13mm dia (adhesive)	H/CO8401	1000	
Drawer Bump	H/CO8389	20	
Connector Trim Cap	H/CO8381/TC	100	
Banding Tape (Iron on) 21 x 25m roll	H/CO/IOT25?WH	1	

Sliding Racks, Hooks <input type="checkbox"/> Check	Part No	Pack	Select
Sliding Belt Rack - SN	CP/A/BR40/SN	1	
Sliding Belt Rack - SCC	CP/A/BR40	1	
Sliding Tie Rack - SN	CP/A/TIR40/SN	1	
Sliding Tie Rack - SCC	CP/A/TIR40	1	
Sliding Valet Rod - SN	CP/A/VR40/SN	1	
Sliding Valet Rod - SCC	CP/A/VR40	1	
Sliding Scarf Rack - SN	CP/A/SRF40/SN	1	
Sliding Scarf Rack - SCC	CP/A/SRF40	1	
Hat and Robe Hook - SN	CP/A/H3/SN	1	
Hat and Robe Hook - SCC	CP/A/H3	1	
Trousers Rack - SN	CP/A/TR40/564/SN	1	
Trousers Rack - SCC	CP/A/TR40/564	1	

**Premium 395 or Ultra 550**  
**Freestanding - All supplied as predrilled loose panels**  
**to your specifications**

**Important Notes**

- 1- Shelving Unit available in Fixed or Adjustable Shelving  
 If adjustable evenly spaced holes will be drilled between Shelves 1 and 6
- 2 - All units 395mm Deep (Premium 395) or 550mm Deep (Ultra 550)  
 and 2076mm High + Toe kick (70 to 100mm). All custom Widths, apart from Drawer unit

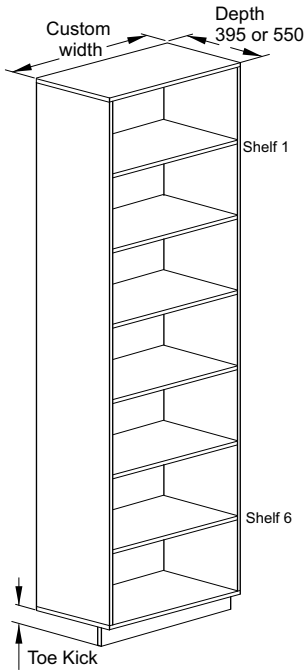

**Shelving Unit**  
**Wall End shown**  
 (either LH or RH)

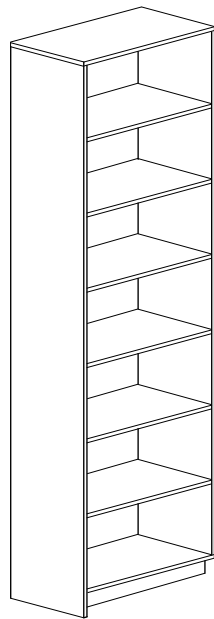

**Shelving Unit**  
**LH Open End shown.**  
 (or RH End)

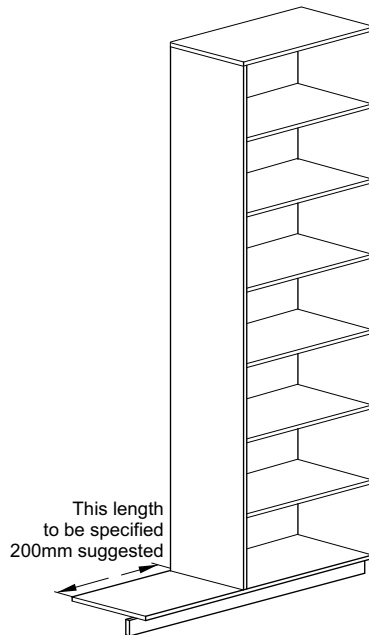

**Shelving Unit**  
**LH Corner End shown.**  
 (or RH End)

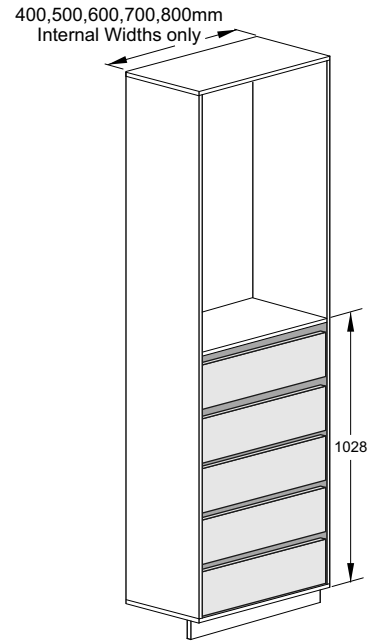

**5 x Drawer Unit**  
 (Wall Ends shown  
 but any Ends)

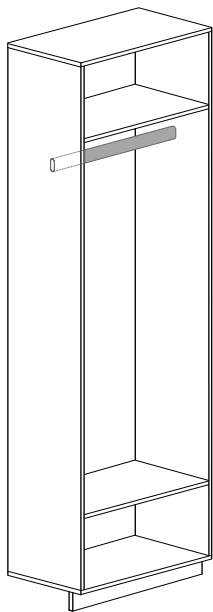

**Midi Hang Unit**  
 (Wall Ends shown,  
 but any Ends)

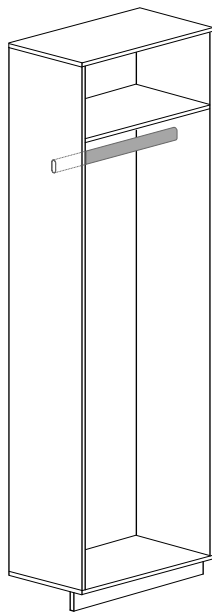

**Long Hang Unit**  
 (Wall Ends shown,  
 but any Ends)

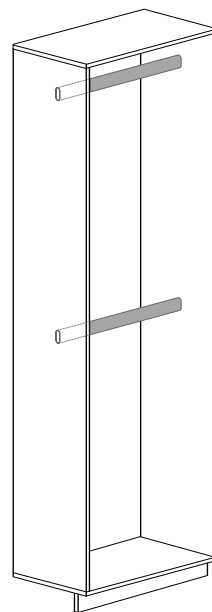

**Double Hang Unit**  
 (Wall Ends shown,  
 but any Ends)

Juralco ClosetPro® Melamine Wardrobe System

**Premium 395 or Ultra 550**  
**Drawer Units**

400,500,600,  
700 or 800mm  
(internal Widths)

Depth  
395 or 550

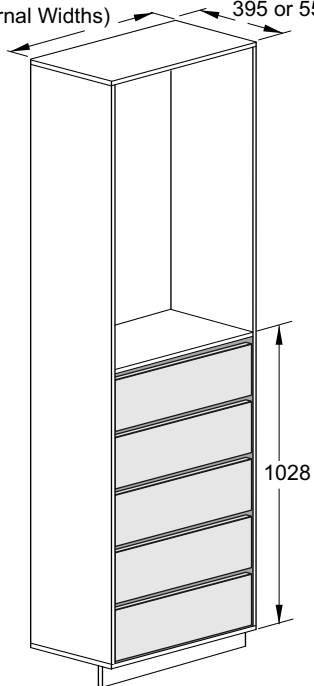

5 x Drawer Unit shown  
(Wall Ends shown  
but any Ends

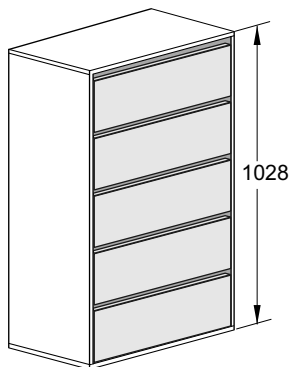

Note: 5 x Drawer Unit  
Slot Handles

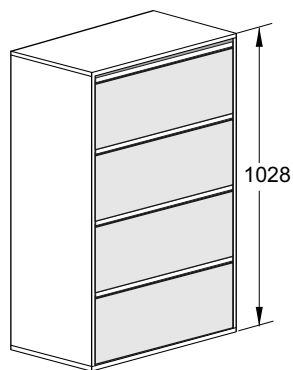

Note: 4 x Drawer Unit  
Aluminium Strip Handles



Hidden Jewellery Drawer shown.  
(only available on 4 x Drawer with Strip Handles)  
Also showing Aluminium Strip Handle

**Only for Ultra 550**

- Hidden storage
- Single size
- Soft Close

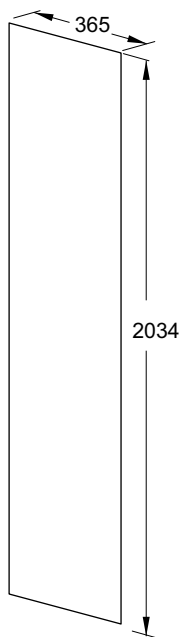

Front Panel  
2034 x 365



**Make-up Desk / Work Station**

- Single size
- Soft Close Drawer
- Mount through Back Panel preferably into 2 x studs

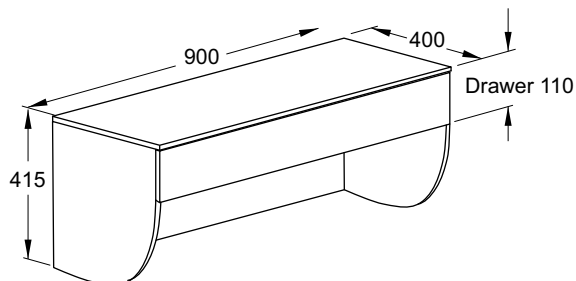

**Juralco ClosetPro® Melamine Wardrobe System - Components**  
**For all Classic 395, Premium 395 and Ultra 550 Wardrobes**  
**Push to Open Shelf**

**Suitable for Easy access to any items**

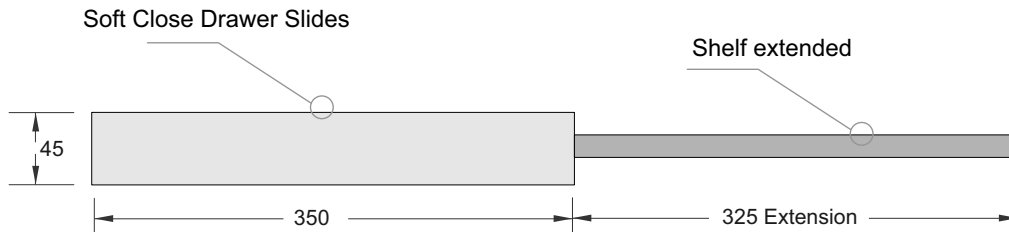
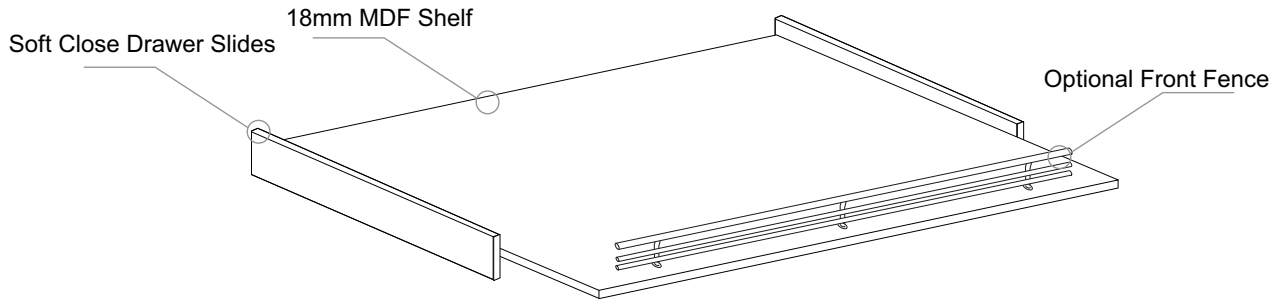

**Premium 395 or Ultra 550**  
**Freestanding - All supplied as predrilled loose panels**  
**to your specifications**

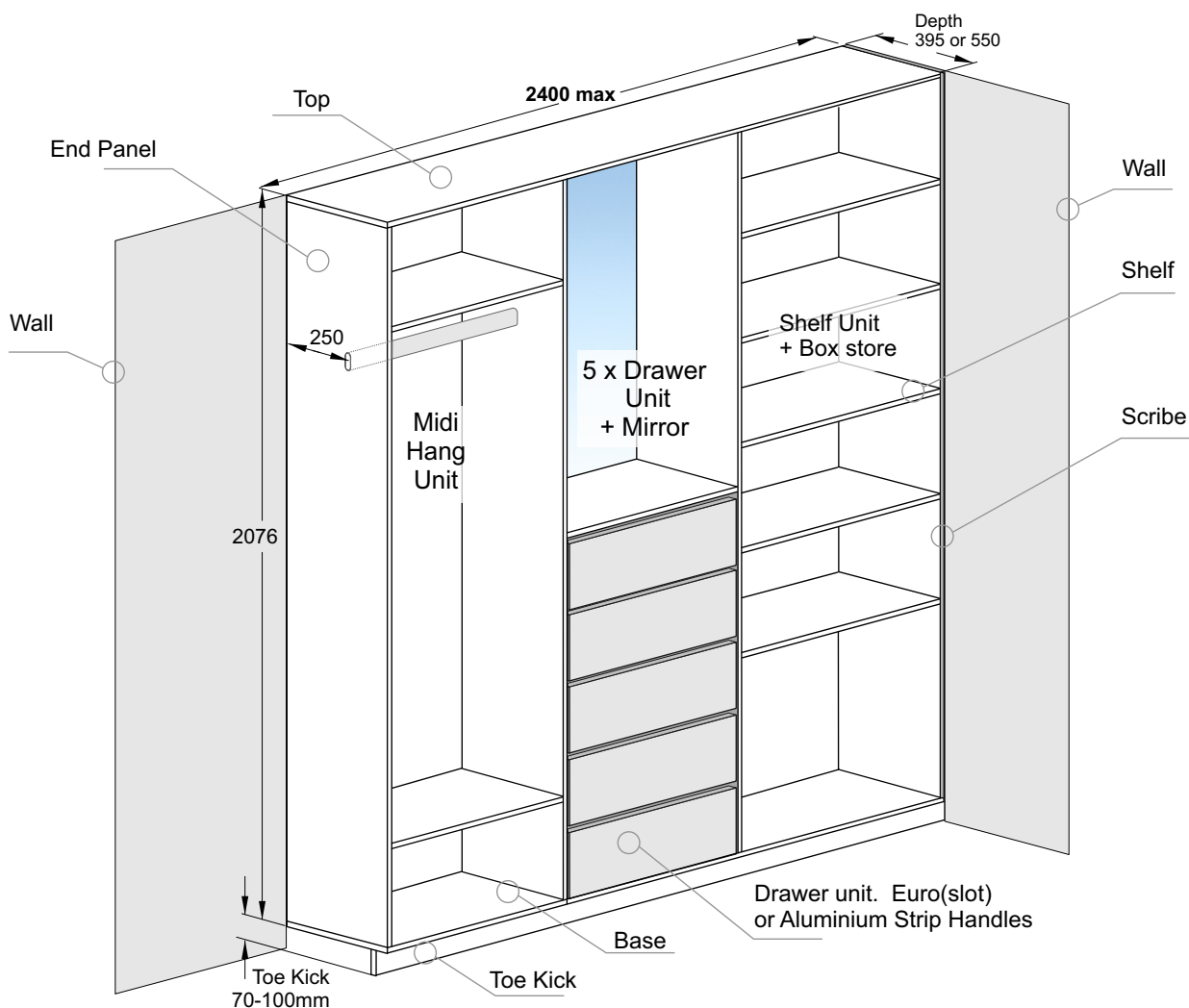

**Panel Codes and Part Nos**

Code	Part No
H/CO/TOP12	FS Top Shelf (0-1200mm)
H/CO/TOP24	FS Top Shelf (1201-2400mm)
H/CO/TOEKICK12	FS Toe Kick (0-1200mm)
H/CO/TOEKICK24	FS Toe Kick (1201-2400mm)
H/CO/SCRIBE12	FS Scribe 12mm (2400mm)
H/CO/SCRIBE18	FS Scribe 18mm (2400mm)
H/CO/BASE12	FS Base (0-1200mm)
H/CO/BASE18	FS Base (1201-1800mm)
H/CO/BASE24	FS Base (1801-2400mm)
H/CO/ENDPANEL	FS End Panel
H/CO/DRWSET/400	FS 400mm Drawer Set
H/CO/DRWSET/500	FS 500mm Drawer Set
H/CO/DRWSET/600	FS 600mm Drawer Set
H/CO/DRWSET/700	FS 700mm Drawer Set
H/CO/DRWSET/800	FS 800mm Drawer Set



Customer	Date
<b>Premium 395 and Ultra 550 Freestanding Wardrobes</b>	Order No
	Enter Customer details above. Enter details into boxes below. Enter No required. Then Scan and email to <a href="mailto:chchsales@juralco.co.nz">chchsales@juralco.co.nz</a>

<b>1 Select System</b>	<table style="width:100%; border-collapse: collapse;"> <tr> <td style="width:50%; border-bottom: 1px solid black;">System <input type="checkbox"/> Check</td> <td style="width:50%; border-bottom: 1px solid black;"></td> </tr> <tr> <td style="border-bottom: 1px solid black;">Premium 395</td> <td style="border-bottom: 1px solid black;">Ultra 550</td> </tr> </table>	System <input type="checkbox"/> Check		Premium 395	Ultra 550	<b>2 Material.</b> - 18mm MDF - Enter Colour	Material - Coloured, specify <input type="checkbox"/> Check
System <input type="checkbox"/> Check							
Premium 395	Ultra 550						

**3 Configure.- Enter Dimensions then Tick to select.**

Overall Width  Check  Max 2400mm

If Corners elected below add overhang Length

**Enter individual Bay Dimensions. NA = No Bay**

	<input style="width: 80%;" type="text"/>		<input style="width: 80%;" type="text"/>		<input style="width: 80%;" type="text"/>		<input style="width: 80%;" type="text"/>	
	← Bay 1 Width →		← Bay 2 Width →		← Bay 3 Width →		← Bay 4 Width →	

<b>Left End</b> <input type="checkbox"/> Check	<b>Select One</b>
Open	
Wall	
Corner	

<b>BAY 1</b>	<b>BAY 2</b>	<b>BAY 3</b>	<b>BAY 4</b>
--------------	--------------	--------------	--------------

<b>Right End</b> <input type="checkbox"/> Check	<b>Select One</b>
Open	
Wall	
Corner	

	<b>BAY 1</b> <input type="checkbox"/> Check	<b>Select One</b>		<b>BAY 2</b> <input type="checkbox"/> Check	<b>Select One</b>		<b>BAY 3</b> <input type="checkbox"/> Check	<b>Select One</b>		<b>BAY 4</b> <input type="checkbox"/> Check	<b>Select One</b>
Long Hang											
Midi Hang											
Double Hang											
Shelves (fixed)											
Shelves (adjustable)											
Drawers x 5											
Drawers x 4											
Slot Handle											
Strip Handle											
Jewellery											

Note: Hidden Jewellery unit only available on 4 x Drawer units with Strip Handles

**4 Drawing (if required)**

**5 See next page for Components**

**5** Order Components. Enter No required. No entry = 0 (SN = Satin Nickel)

<b>Sliding Racks, Hooks</b> <input type="checkbox"/> Check	<b>Part No</b>	<b>Pack</b>	<b>Select</b>
Sliding Belt Rack - SN	CP/A/BR40/SN	1	
Sliding Belt Rack - SCC	CP/A/BR40	1	
Sliding Tie Rack - SN	CP/A/TIR40/SN	1	
Sliding Tie Rack - SCC	CP/A/TIR40	1	
Sliding Valet Rod - SN	CP/A/VR40/SN	1	
Sliding Valet Rod - SCC	CP/A/VR40	1	
Sliding Scarf Rack - SN	CP/A/SRF40/SN	1	
Sliding Scarf Rack - SCC	CP/A/SRF40	1	
Hat and Robe Hook - SN	CP/A/H3/SN	1	
Hat and Robe Hook - SCC	CP/A/H3	1	
Trouser Rack - SN	CP/A/TR40/564/SN	1	
Trouser Rack - SCC	CP/A/TR40/564	1	

<b>Toe Kick Adj Foot</b> <input type="checkbox"/> Check	<b>Part No</b>	<b>Pack</b>	<b>Select</b>
Mount Plate	H/CO/CPMOUNTPLT	1	
Base Foot + Adjuster	H/CO/CPFOOT/80	1	
Plinth Clip	H/CO/CPPLINTH	1	

<b>Shelf Fences</b> <input type="checkbox"/> Check	<b>Part No</b>	<b>Pack</b>	<b>Select</b>
300 Shelf Fence - SN	CP/A/F279/SN	1	
300 Shelf Fence - SCC	CP/A/F279	1	
400 Shelf Fence - SN	CP/A/F380/SN	1	
400 Shelf Fence - SCC	CP/A/F380	1	
450 Shelf Fence - SN	CP/A/F432/SN	1	
450 Shelf Fence - SCC	CP/A/F432	1	
564 Shelf Fence - SN	CP/A/F520/SN	1	
564 Shelf Fence - SCC	CP/A/F520	1	
600 Shelf Fence - SN	CP/A/F584/SN	1	
600 Shelf Fence - SCC	CP/A/F584	1	
800 Shelf Fence - SN	CP/A/F737/SN	1	
800 Shelf Fence - SCC	CP/A/F737	1	

<b>Closet Rails + Brackets</b> <input type="checkbox"/> Check	<b>Part No</b>	<b>Pack</b>	<b>Select</b>
Standard Closet Rail x 3m	H/8384/3	1	
Heavy Duty Closet Rail x 3m	H/8384HD/3	1	
Closet J Rail x 4.8m	H/8385/4.8	1	
Closet Rail Socket (Chrome)	H/CO8384RS/CP	100	
Closet Rail Centre Support	H/CO8384RS/CP	1	

<b>Screws + Connectors</b> <input type="checkbox"/> Check	<b>Part No</b>	<b>Pack</b>	<b>Select</b>
Drawer Runner Screw	H/CO/8398	100	
Suspension Bracket Screw	H/CO/8387	100	
Connector Bolt (with Thread)	H/CO/8382	100	
Connector Bolt (no Thread)	H/CO/8384CS/CP	100	
Connector Housing (internal tighten)	H/CO8381	100	
Connector Housing (push fit)	H/CO8383	100	

<b>Misc Components</b> <input type="checkbox"/> Check	<b>Part No</b>	<b>Pack</b>	<b>Select</b>
Corner Connector (incl clip on cover)	H/CO8390	20	
Angle Brkt	H/CO8394	20	
End Panel Bracket	H/CO8400	20	
Cover Cap 13mm dia (push in)	H/CO8388	??	
Cover Cap 13mm dia (adhesive)	H/CO8401	100	
Drawer Bump	H/CO8389	20	
Connector Trim Cap	H/CO8381/TC	100	
Banding Tape (Iron on)21 x 25m roll	H/CO/IOT25?WH	1	
Jewellery Box	CP/A/JD140/BLK		

**Juralco ClosetPro® Melamine Wardrobe System - Extrusions and Components**  
**For Premium 395 and Ultra 550 Wardrobes only**

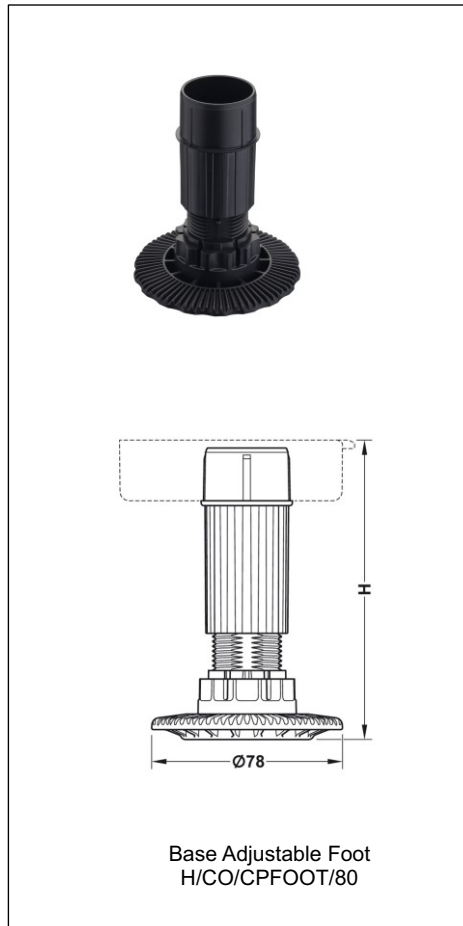
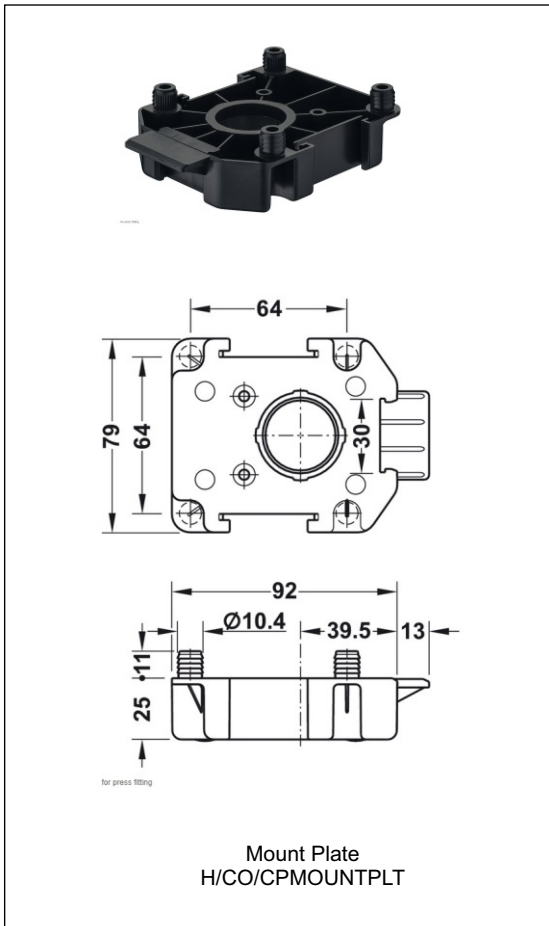
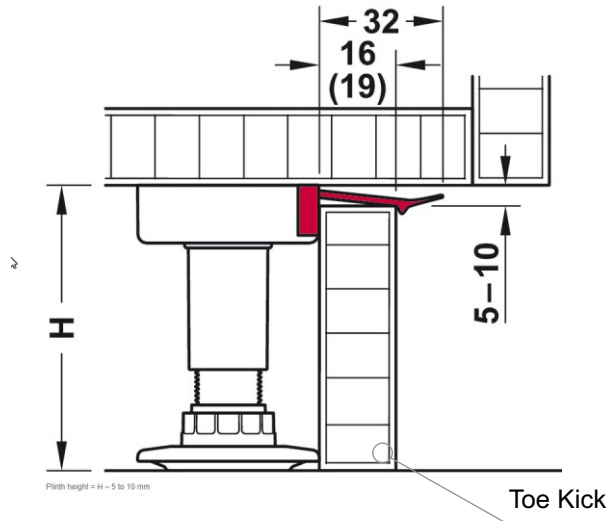

**Juralco ClosetPro® Melamine Wardrobe System - Extrusions and Components**  
**For all Classic 395, Premium 395 and Ultra 550 Wardrobes**

**Juralco Melamine Wardrobe Storage Systems - Extrusions**

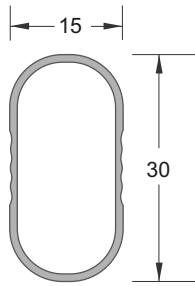

**STANDARD CLOSET RAIL**  
H/8384/3

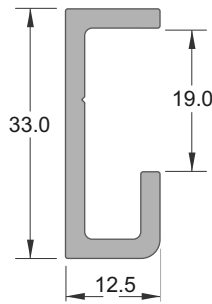

**CLOSET HANGING TRACK**  
H/8386/4.8

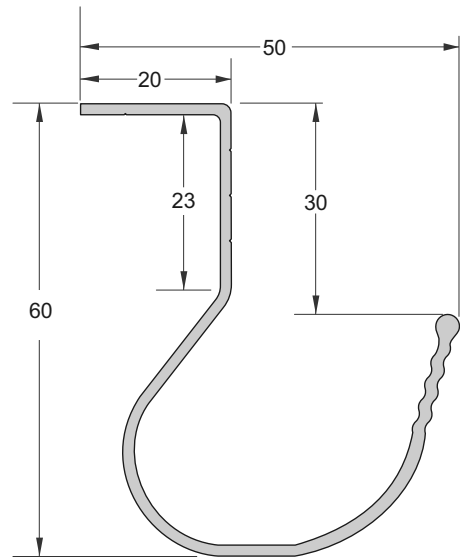

**J RAIL CLOSET HANGING TRACK**  
H/8385/4.8

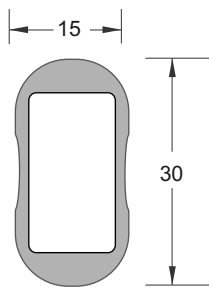

**HEAVY DUTY CLOSET RAIL**  
H/8384HD/3

**Juralco Melamine Wardrobe Storage Systems - Components**

**Closet Rail Socket**  
H/CO8384RS/CP

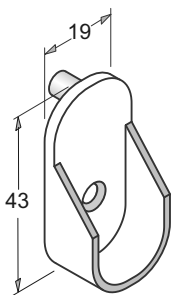

Chrome Plated

**Suspension Bracket (Chrome) and Clip on Cover (White or Black)**  
H/CO8386/SB

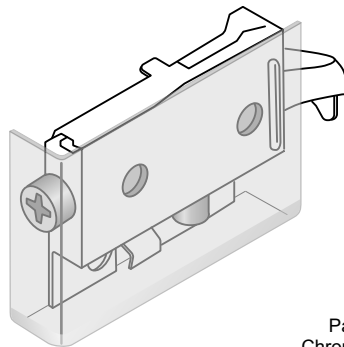

Pair LH/RH  
Chrome Plated  
(Left Hand shown)

**Specifications**

Suspension Bracket

- General purpose hook for use with the Closet Hanging Track above
- Load capacity 65kg ea (=130 kg/pr)
- Adjustment range  
Height ± 7mm, Depth 15mm

Closet Hanging Track

- Length 4800mm
- Max Loading 130kg
- Mount securely into wall studs only, at every 400-600mm
- Screw 8g x 50mm
- Finishes - White, - Natural Anodised (to order) - SCC

**Corner Connector**  
H/CO8390

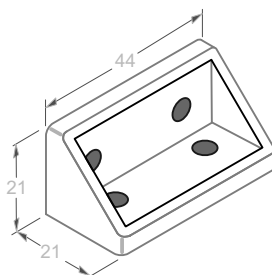

White  
(includes clip on cover)

**Connector Housing**  
H/CO8381

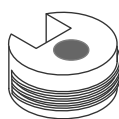

Connector Housing  
Side and Top,  
- with internal tightening.  
For 20mm dia hole

White

**Connector Housing**  
H/CO8383

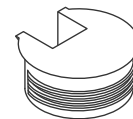

Connector Housing  
Side and Top,  
- push fit tightening.  
For 20mm dia hole

White/Black/Brown

**Juralco ClosetPro® Melamine Wardrobe System - Components**  
**For all Classic 395, Premium 395 and Ultra 550 Wardrobes**

**Closet Rail Centre Support**  
H/CO8384CS/CP

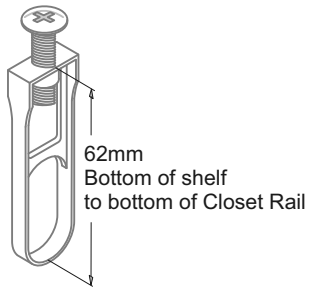

Chrome Plated  
(For use with large span Closet Rail)

**Angle Bracket**  
H/CO8394

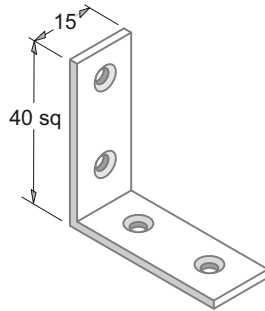

Zinc Plated Steel

**End Panel Bracket**  
H/CO8400

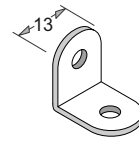

**Drawer Runner Screw**  
H/CO8398



Euro Screw  
10.5mm long  
5mm dia hole

**Suspension Bracket Screw**  
H/CO8387



Attach Screw  
10g x 12mm  
Self tapping

**Connector Bolts**  
H/CO8382



Connector Bolt  
7.5mm long thread  
5mm dia hole

**Connector Bolts**  
H/CO8385

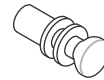

Connector Bolt  
7.5mm long (no thread)  
5mm dia hole

**Cover Cap. 13mmdia**  
H/CO8388



White  
(for miscellaneous 5mm dia construction holes)

**Cover Cap. 13mmdia**  
H/CO8401



White  
(self adhesive)

**Drawer Bump**  
H/CO8389



Clear  
(for 5mm dia hole)

**Connector Trim Cap**  
H/CO8381/TC

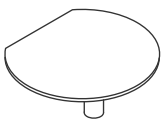

White

**Iron on Banding Tape**  
H/CO/IOT25/WHT

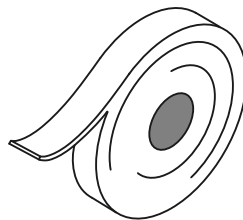

Iron on Banding Tape  
21mm wide x 25mt Roll, White

# Juralco ClosetPro® Melamine Wardrobe System - Components

For all Classic 395, Premium 395 and Ultra 550 Wardrobes

## AMEDO™ Components

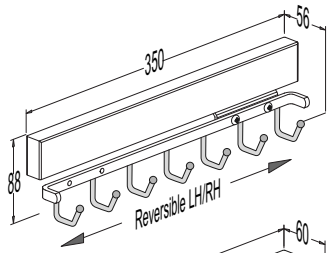

CP/A/BR40/SN  
CP/A/BR40

SLIDING BELT RACK - SATIN NICKEL  
SLIDING BELT RACK - SCC

7 HOOKS  
7 HOOKS

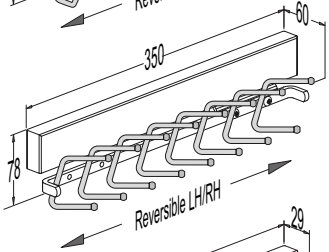

CP/A/TIR40/SN  
CP/A/TIR40

SLIDING TIE RACK - SATIN NICKEL  
SLIDING TIE RACK - SCC

8 HOOKS  
8 HOOKS

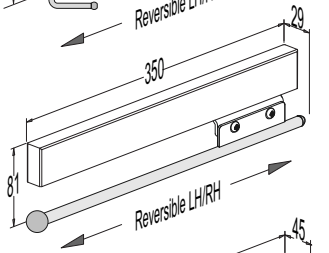

CP/A/VR40/SN  
CP/A/VR40

SLIDING VALET ROD - SATIN NICKEL  
SLIDING VALET ROD - SCC

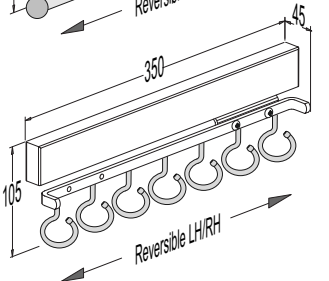

CP/A/SFR40/SN  
CP/A/SFR40

SLIDING SCARF RACK - SATIN NICKEL  
SLIDING SCARF RACK - SCC

7 HOOKS  
7 HOOKS

Hook Size  
WxDxH  
71x61x98  
(Hidden fixing)

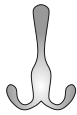

CP/A/H3/SN  
CP/A/H3

HAT & ROBE HOOK - SATIN NICKEL  
HAT & ROBE HOOK - SCC

3 HOOKS  
3 HOOKS

CP/A/TR40/564/SN  
H/CP/A/TR40/564

TROUSER RACK SC - SATIN NICKEL  
TROUSER RACK SC - SCC

11 RODS  
11 RODS

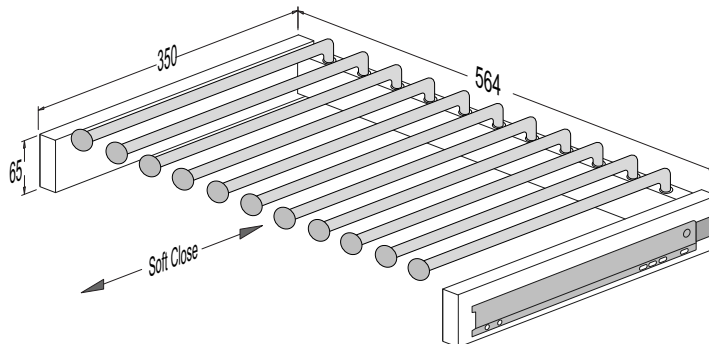

Note: If these Racks to be installed into Shelving units, the shelf must be ordered at 564mm wide



**JURALCO**

www.juralco.co.nz ph (09) 478 8018

**Juralco ClosetPro® Melamine Wardrobe System**

Issue 2-23 v2  
Page 21

**Juralco ClosetPro® Melamine Wardrobe System - Components**  
**For all Classic 395, Premium 395 and Ultra 550 Wardrobes**

**AMEDO™ Components**

	<p>CP/A/F279/SN CP/A/F279</p>	<p>300 SHELF FENCE - SATIN NICKEL 300 SHELF FENCE - SCC</p>
	<p>CP/A/F380/SN CP/A/F380</p>	<p>400 SHELF FENCE - SATIN NICKEL 400 SHELF FENCE - SCC</p>
	<p>CP/A/F432/SN CP/A/F432</p>	<p>450 SHELF FENCE - SATIN NICKEL 450 SHELF FENCE - SCC</p>
	<p>CP/A/F520/SN CP/A/F520</p>	<p>564 SHELF FENCE - SATIN NICKEL 564 SHELF FENCE - SCC</p>
	<p>CP/A/F584/SN CP/A/F584</p>	<p>600 SHELF FENCE - SATIN NICKEL 600 SHELF FENCE - SCC</p>
	<p>CP/A/F737/SN CP/A/F737</p>	<p>800 SHELF FENCE - SATIN NICKEL 800 SHELF FENCE - SCC</p>
	<p>CP/A/JDI40/BLK</p>	<p>JEWELLERY DRAWER INSERT - BLACK</p>

# Juralco ClosetPro® Melamine Wardrobe System - Components

## Gennaro Alpha Components

For all Classic 395, Premium 395 and Ultra 550 Wardrobes



CP/GA/RM40/1200/PG	PEARL GREY	CLOSETPRO ROTATE MIRROR - PEARL GREY 325MM (D) X 61MM (W) X 1200MM (H)	EA
--------------------	------------	---	----

These only for Ultra 550 Wardrobes



CP/GA/SR45/564/PG	PEARL GREY	CLOSETPRO SHOE RACK - PEARL GREY 420MM (D) X 564MM (W) X 160MM (H)	EA
-------------------	------------	---	----



CP/GA/SR45/764/PG	PEARL GREY	CLOSETPRO SHOE RACK - PEARL GREY 420MM (D) X 764MM (W) X 160MM (H)	EA
-------------------	------------	---	----



CP/GA/JD45/564/PG	PEARL GREY	CLOSETPRO JEWELLERY DR - PEARL GREY 420MM (D) X 564MM (W) X 160MM (H)	EA
-------------------	------------	--	----



CP/GA/JD45/764/PG	PEARL GREY	CLOSETPRO JEWELLERY DR - PEARL GREY 420MM (D) X 764MM (W) X 160MM (H)	EA
-------------------	------------	--	----



CP/GA/TR45/564/PG	PEARL GREY	CLOSETPRO TROUSER RACK - PEARL GREY 420MM (D) X 564MM (W) X 160MM (H)	EA
-------------------	------------	--	----



CP/GA/TR45/764/PG	PEARL GREY	CLOSETPRO TROUSER RACK - PEARL GREY 420MM (D) X 764MM (W) X 160MM (H)	EA
-------------------	------------	--	----



CP/GA/MB45/564/PG	PEARL GREY	CLOSETPRO MESH BASKET - PEARL GREY 420MM (D) X 564MM (W) X 140MM (H)	EA
-------------------	------------	---	----



CP/GA/MB45/764/PG	PEARL GREY	CLOSETPRO MESH BASKET - PEARL GREY 420MM (D) X 764MM (W) X 140MM (H)	EA
-------------------	------------	---	----



# Juralco ClosetPro® Melamine Wardrobe System - Installation Tips

For all Classic 395, Premium 395 and Ultra 550 Wardrobes

## 1 - Closet Rail Maximum Recommended Spans



Standard Aluminium Closet Rail H/8384/3  
Maximum unsupported spans...  
- Long Hanger (Coats etc) 900mm  
- Double Hanger (Shirts etc) 1100mm



Heavy Duty Aluminium Closet Rail H/8384HD/3  
Maximum unsupported spans...  
- Any hanger 1800mm



Use the Closet Rail Centre Support H/CO 8384CS/CP for longer spans

## 2 - Connector Insertion

### Connector Housings

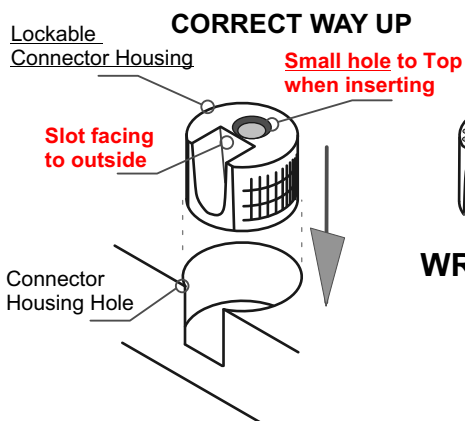

**CORRECT WAY UP**

Lockable Connector Housing

Slot facing to outside

Connector Housing Hole

**WRONG WAY**

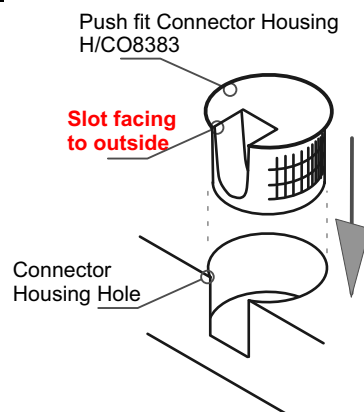

Push fit Connector Housing H/CO8383

Slot facing to outside

Connector Housing Hole

**Lockable Connector Housing** must be used on bottom shelves or in critical strengthening areas. Tap fit in place. After attaching shelf to the Connector Bolts the locking screws must be tightened (from below)

**Push Fit Connector Housing** can be used in non critical areas, such as middle shelves

## Connector Hole Drilling

If needed extra Connector holes can be drilled with a Bosch Wood Forstner Drill Bit, 20mm Obtainable from General Hardware stores.

- 1 - Mark out hole centres carefully.
- 2 - Set correct depth.



# Juralco ClosetPro® Melamine Wardrobe System Wardrobe Assembly Instructions

For all Classic 395, Premium 395 and Ultra 550 Wardrobes

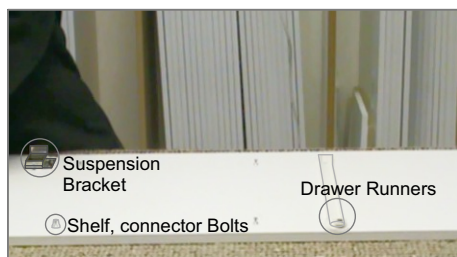

1

Vertical Panel, Fittings. Attach all fittings to vertical panels, to your plan See Panel predrilled layouts pages 5-6.

After doing one side, turn over and do other (if necessary).

Suspension Bracket - 2 x 10g x 12 self tappers.  
Shelf Bolts - Special connector bolts.  
Drawer runners - Euro screw.



Attach Closet Rail Sockets if needed (tap in, no screws required)



After doing one side, turn over and do other (if necessary)  
Or cover up all seen holes with stick on dots.

Vertical panels now finished.



2

Shelves. Tap Connector Housings in place, 4 per shelf.

**When inserting...**

- 1 - Open slot to top (**ie not upside down**)
- 2 - Slot facing outwards.

Shelf now finished.

## Connector Housings

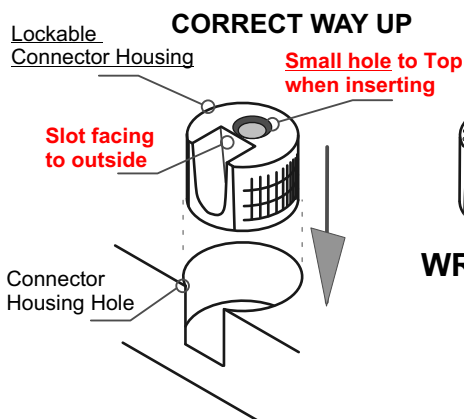

WRONG WAY

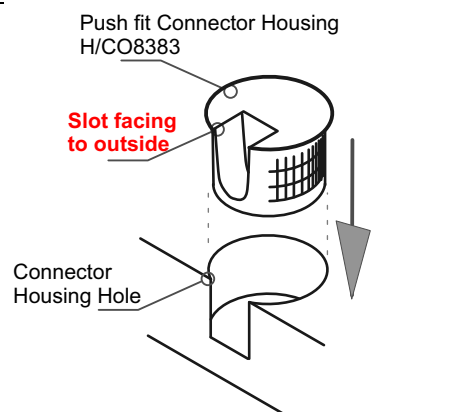

**Lockable Connector Housing** must be used on bottom shelves or in critical strenghtening areas. Tap fit in place. After attaching shelf to the Connector Bolts the locking screws must be tightened (from below)

**Push Fit Connector Housing** can be used in non critical areas, such as middle shelves

**Juralco ClosetPro® Melamine Wardrobe System  
Wardrobe Assembly Instructions**  
For all Classic 395, Premium 395 and Ultra 550 Wardrobes



**3**

Installation. Use level to attach full length Closet Hanging Track.  
Ensure Track, screw attached firmly into studs.

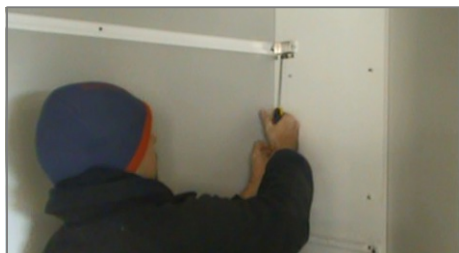

Attach first Vertical panel.  
Tighten vertical then horizontal screws on Suspension bracket.

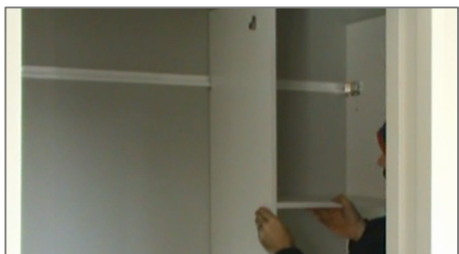

Working from one end...  
Clip on second vertical panel.  
Then insert Shelves or Rail between these two panels.  
Square up second panel, then secure suspension bracket in place.  
Then lock shelves (if any) between the first two panels.

Repeat, working along until last panel installed and secured.

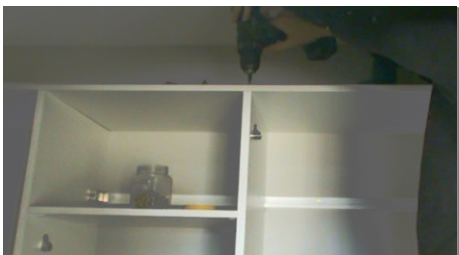

Cut Top panel to length.  
Edge band ends if edge is visible to the customer.

Place Top panel in correct position,(on top of all vertical panels)  
Starting at one end, use Countersink+drill to drill down into Vertical panels.  
Screw attach at every panel, screw head flush.

Finally install all shelves, Closet Rails and Drawers.  
Final clean up, clean all surfaces.

Job finished.