



MASONS
Designed Smart, Built Tough.

MASONS TYPICAL DETAIL
ENVIRO - 75 MM AAC FLOOR PANEL - TIMBER
TYPICAL PANEL LAYOUT -TIMBER

Scale
1 : 25 @A3

Date

Drawing No.
1

Version
JULY 2024 - v2

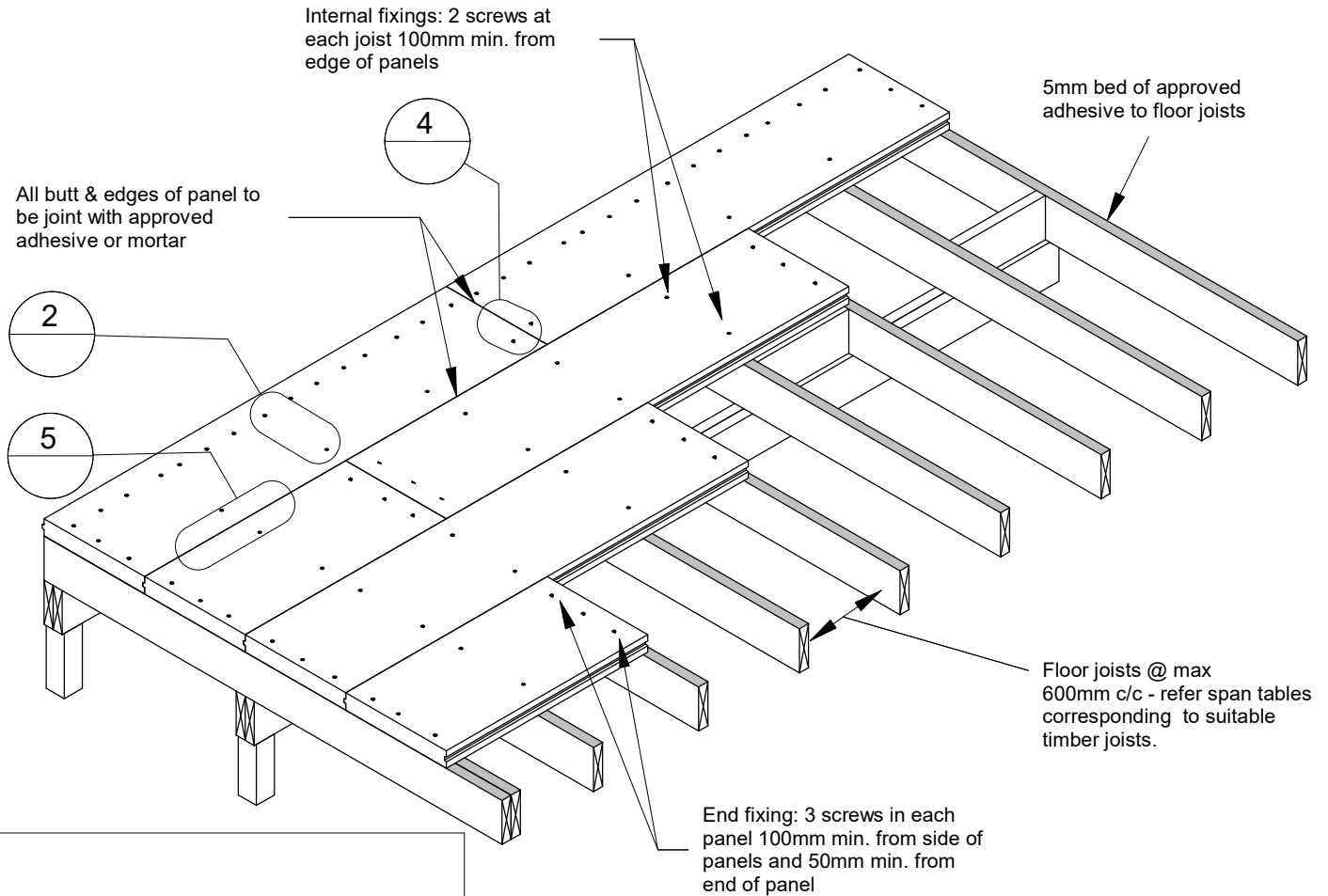

NOTE:

Panel orientation

1. Set out joists to suit 2200mm lengths of Enviro Panel – see span tables in the appendix. Place panels at right angles to the floor joists
2. Lay sheets in a staggered – brick bond pattern
3. Panels must be supported by at least two joists
4. Panels must be butt jointed on joists or blocking

Adhesives

5. Panels must be bonded or jointed edge to edge using one of three adhesives to be selected by the designer.
 - Enviro Glue Mortar
 - Soudal Gorilla Grip 2 HR PU construction adhesive (or similar)
 - Soudal Sudabond adhesive foam
6. The panels are glued to the timber floor framing using either
 - Soudal Gorilla Grip 2 HR PU construction adhesive (or similar)
 - Soudal Sudabond adhesive foam

Sealants and Foam Filler

7. Use a premium MS sealant such as Soudal MS sealant, and Gorilla Pro range of expanding PU foams. **These PU foams are for gap filling only.**

Fixing Screws

8. Use 14g 10 x 100 Bugle Head (Class 3) Screws- 2 per joist (all locations other than note 9 & 10)
9. Use 14g 10 x 120 Bugle Head (Class 3) screws - 3 per joist at short ends and 150 crs around openings.
10. Use 14g 10 x 150 Bugle Head (Class 3) screws @ 150 crs at floor perimeter, brace walls, and internal walls- fixing through the bottom plates

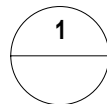

TYPICAL PANEL LAYOUT (TIMBER)

1 : 25



MASONS
Designed Smart, Built Tough.

MASONS TYPICAL DETAIL
ENVIRO - 75 MM AAC FLOOR PANEL - TIMBER
TYPICAL PANEL TO JOIST FIXING

Scale
1 : 10 @A3

Date

Drawing No.
2

Version
JULY 2024 - v2

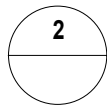
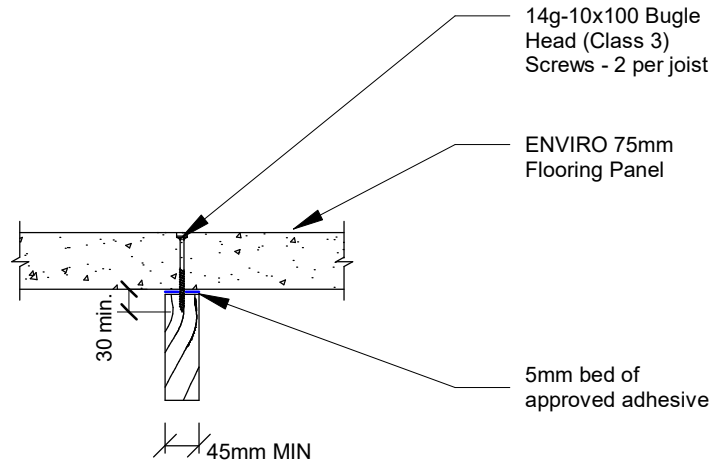

TYPICAL PANEL TO JOIST FIXING

1 : 10



MASONS
Designed Smart, Built Tough.

MASONS TYPICAL DETAIL
ENVIRO - 75 MM AAC FLOOR PANEL - TIMBER
TYPICAL PANEL TO WALL FIXING

Scale
1 : 10 @A3

Date

Drawing No.

3

Version

JULY 2024 - v2

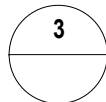
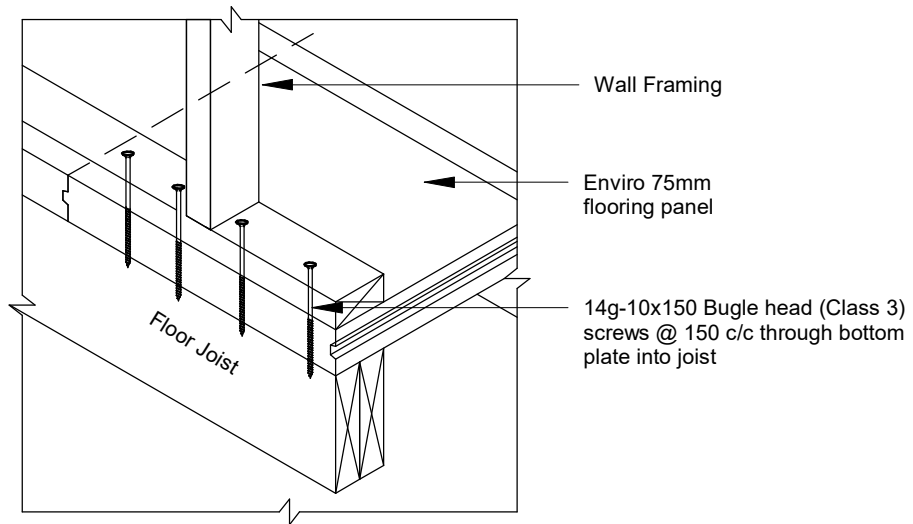

TYPICAL PANEL TO WALL FIXING

1 : 10



MASONS
Designed Smart, Built Tough.

MASONS TYPICAL DETAIL
ENVIRO - 75 MM AAC FLOOR PANEL - TIMBER
TYPICAL PANEL JOINTS

Scale
1 : 10 @A3

Date

Drawing No.

4

Version

JULY 2024 - v2

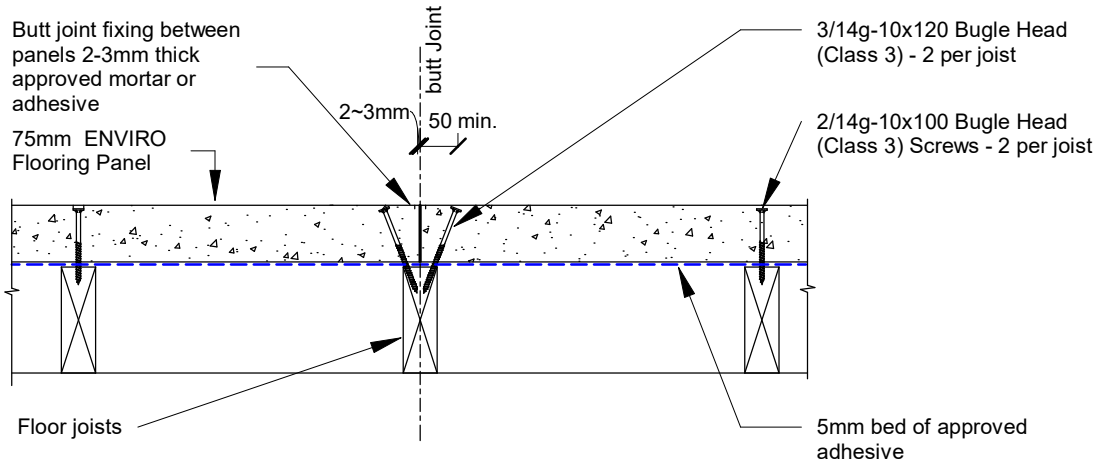

NB: ENVIRO Panel to be supported on a minimum of 2 joists

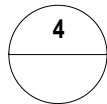

TYPICAL PANEL JOINT AT SHORT EDGE

1 : 10



MASONS
Designed Smart, Built Tough.

MASONS TYPICAL DETAIL
ENVIRO - 75 MM AAC FLOOR PANEL - TIMBER
TYPICAL PANEL JOINTS

Scale
1 : 10 @A3

Date

Drawing No.

5

Version

JULY 2024 - v2

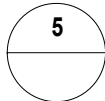
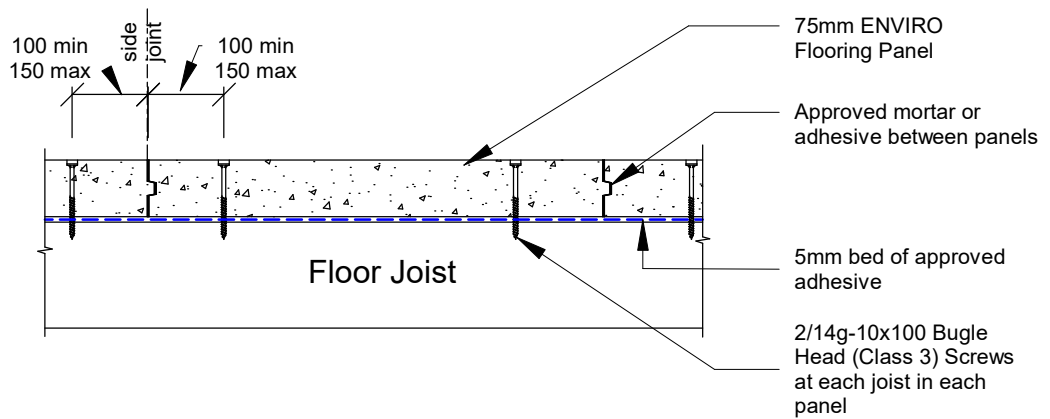

TYPICAL PANEL JOINT AT LONG EDGE

1 : 10

Also refer detail 13 for control joints.



MASONS TYPICAL DETAIL
ENVIRO - 75 MM AAC FLOOR PANEL - TIMBER
TYPICAL PENETRATION DETAILS

Scale
1 : 10 @A3

Date

Drawing No.
6

Version
JULY 2024 - v2

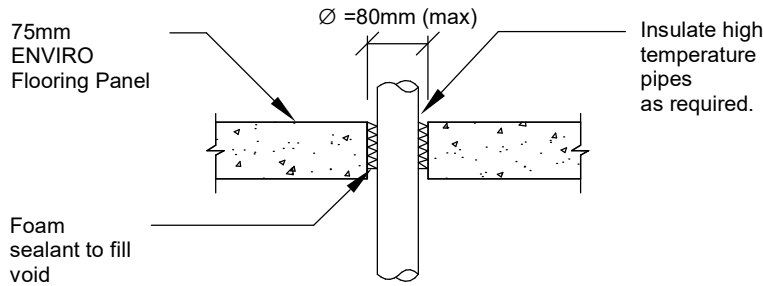

CASE 1 : PIPE Ø 80MM MAX.

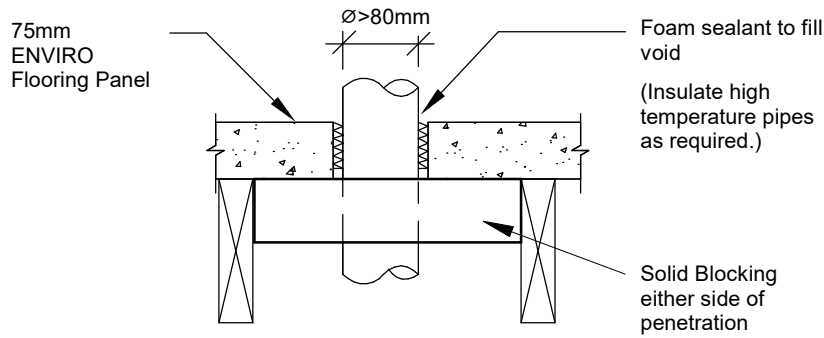

CASE 2 : PIPE Ø > 80MM

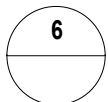

TYPICAL PENETRATION

1 : 10



MASONS TYPICAL DETAIL
ENVIRO - 75 MM AAC FLOOR PANEL - TIMBER
TYPICAL BRACE WALL FIXING

Scale
1 : 10 @A3

Date

Drawing No.
7

Version
JULY 2024 - v2

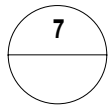
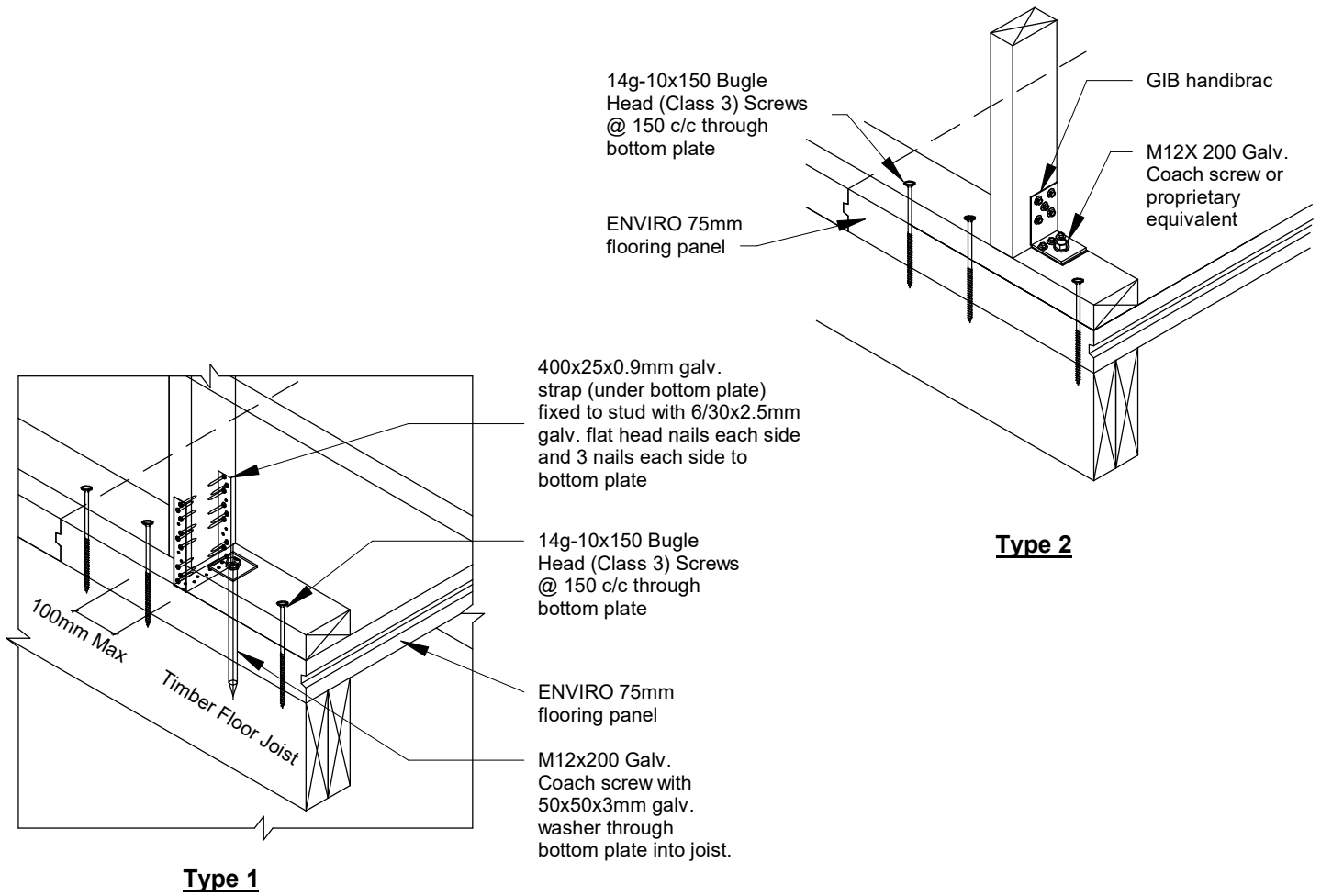

TYPICAL EXTERNAL (BRACE) WALL

1 : 10



MASONS
Designed Smart, Built Tough.

MASONS TYPICAL DETAIL
ENVIRO - 75 MM AAC FLOOR PANEL - TIMBER
TYPICAL BRACE WALL FIXING

Scale
1 : 10 @A3

Date

Drawing No.

Version

8

JULY 2024 - v2

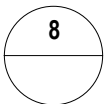
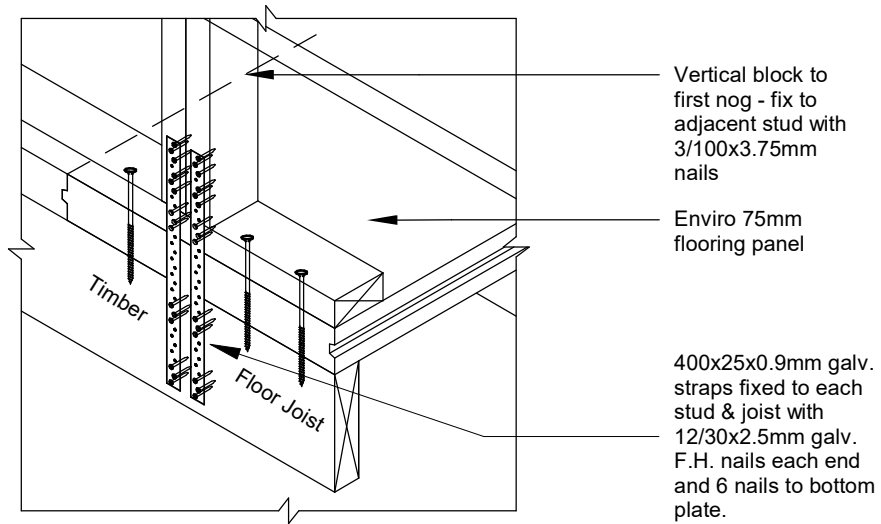

TYPICAL EXTERNAL (BRACE) WALL 12kN - ALTERNATIVE

1 : 10



MASONS
Designed Smart, Built Tough.

MASONS TYPICAL DETAIL
ENVIRO - 75 MM AAC FLOOR PANEL - TIMBER
TYPICAL INTERNAL WALLS

Scale
1 : 10 @A3

Date

Drawing No.

9

Version

JULY 2024 - v2

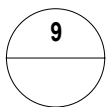
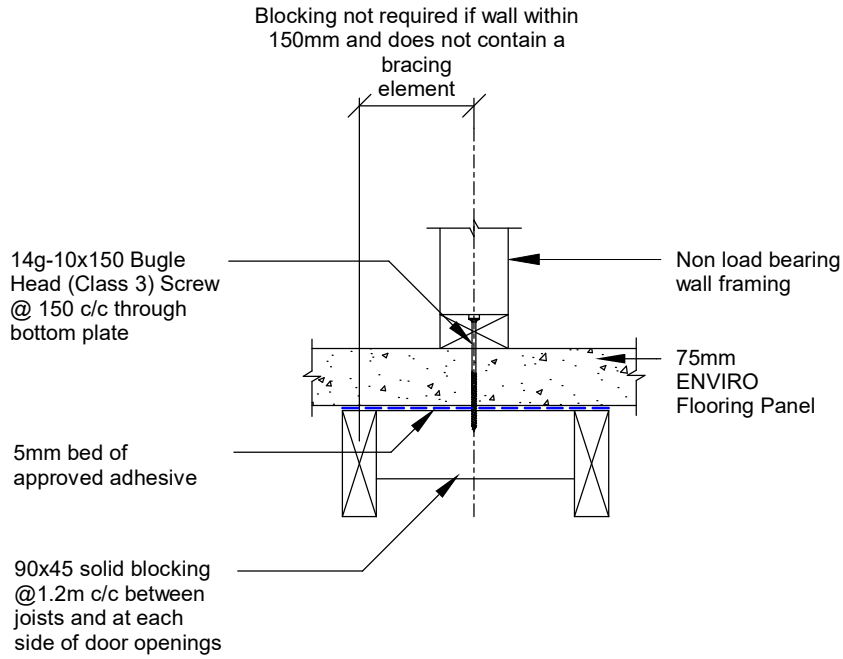

TYPICAL INTERNAL WALL (NON LOAD BEARING)

1 : 10



MASONS
Designed Smart, Built Tough.

MASONS TYPICAL DETAIL
ENVIRO - 75 MM AAC FLOOR PANEL - TIMBER
TYPICAL INTERNAL WALLS

Scale
1 : 10 @A3

Date

Drawing No.

10

Version

JULY 2024 - v2

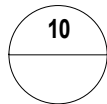
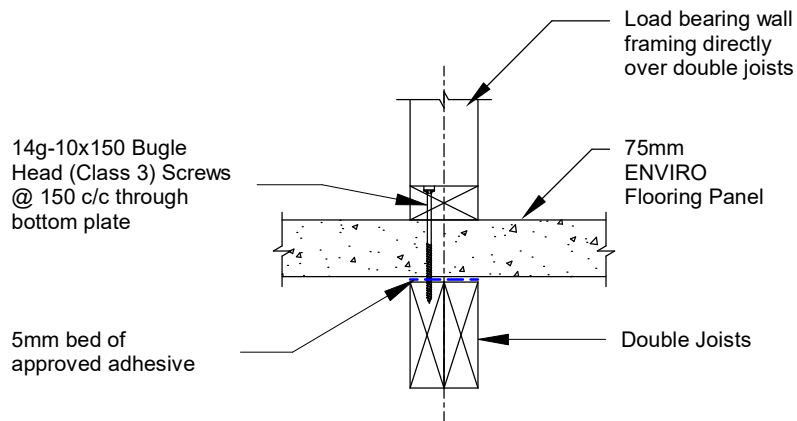

TYPICAL INTERNAL WALL (LOAD BEARING)

1 : 10



MASONS
Designed Smart, Built Tough.

MASONS TYPICAL DETAIL
ENVIRO - 75 MM AAC FLOOR PANEL - TIMBER
TYPICAL CONTROL JOINTS

Scale
1 : 10 @A3

Date

Drawing No.

11

Version

JULY 2024 - v2

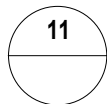
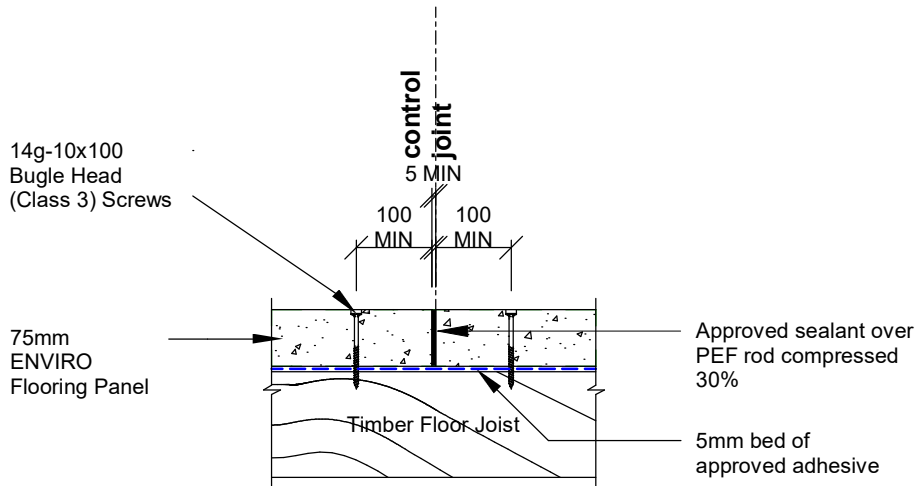

TYPICAL CONTROL JOINT

1 : 10

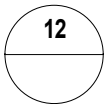
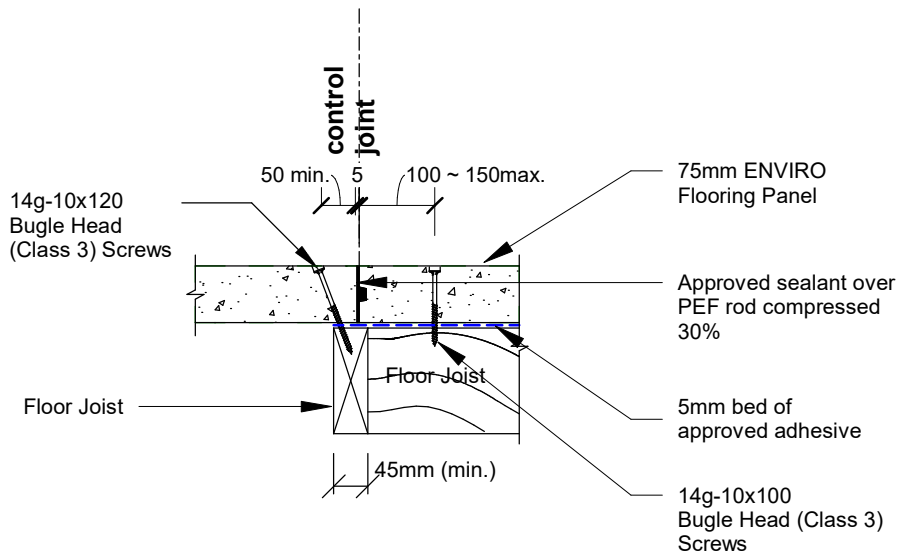

TYPICAL CONTROL JOINT - AT LONG/SHORT EDGE JUNCTION

1 : 10