

BRANZ Appraised
Appraisal No.510 [2013]

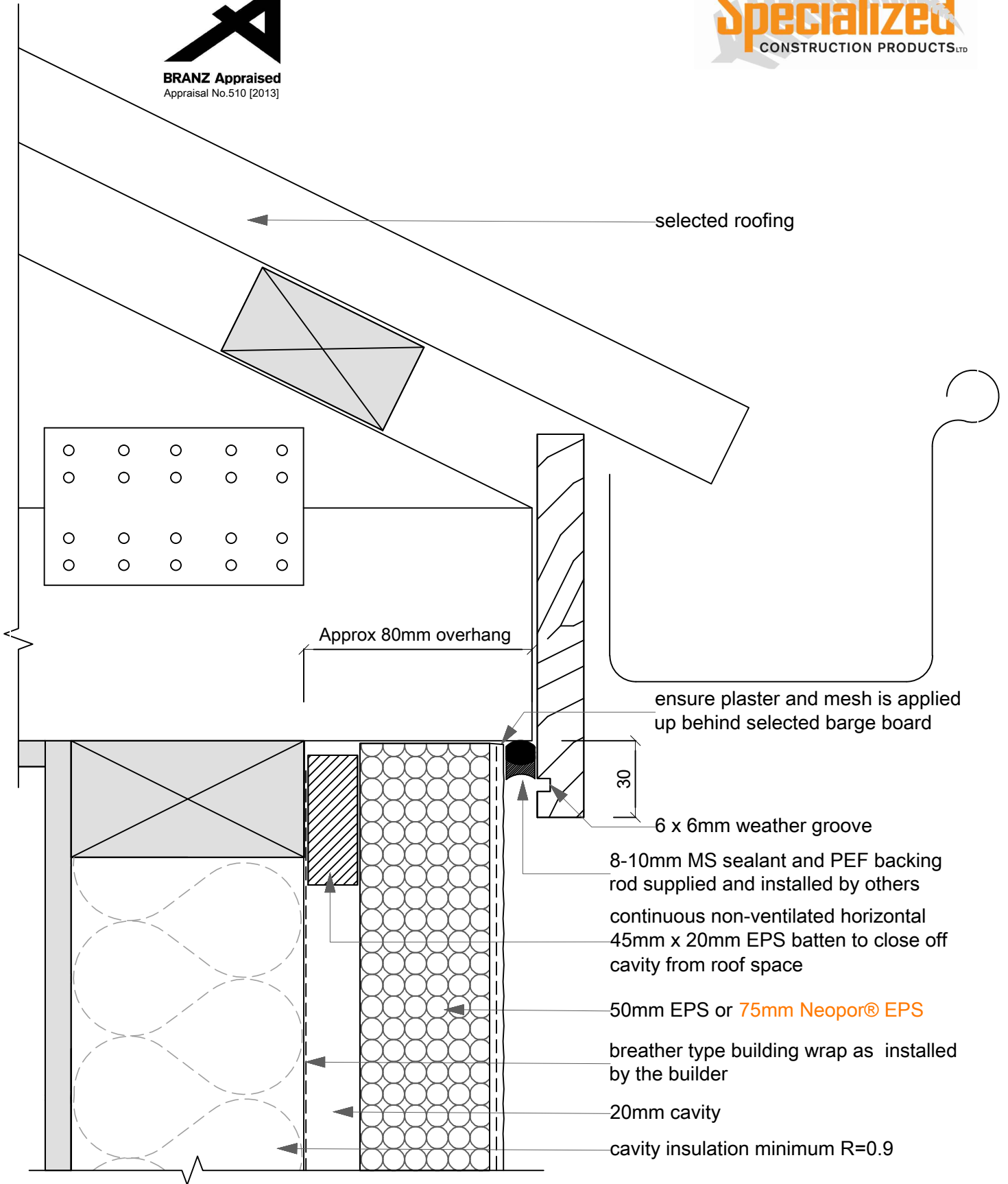

selected roofing

Approx 80mm overhang

ensure plaster and mesh is applied up behind selected barge board

6 x 6mm weather groove

8-10mm MS sealant and PEF backing rod supplied and installed by others

continuous non-ventilated horizontal 45mm x 20mm EPS batten to close off cavity from roof space

50mm EPS or 75mm Neopor® EPS

breather type building wrap as installed by the builder

20mm cavity

cavity insulation minimum R=0.9

14A

Wall / Roof: Flush Eaves

SCALE: 1:2

CAVITECLAD