

# INSTALLATION

We strongly recommend this light fitting is installed by a registered electrician. This guide can be used to install both models listed in this manual.

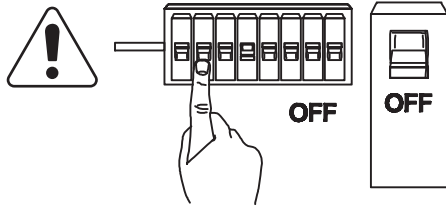

**1** Switch off the power supply before commencing any electrical work.

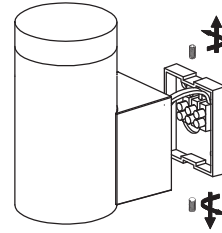

**2** Unscrew the fixing cover screws with the allen key supplied and remove the rear mounting base.

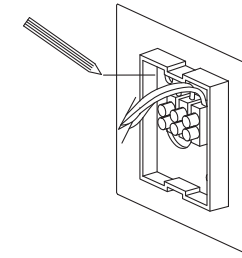

**3** Use the rear base to mark the position of screw holes onto the mounting surface. Use a spirit level to ensure correct orientation.

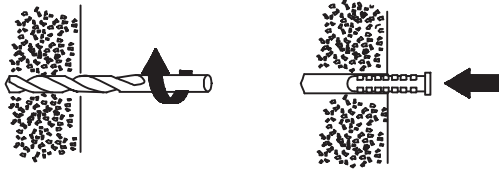

**4** Drill the wall to depth of about 40mm and fit the wall plugs (supplied). Care should be taken to avoid drilling or screwing into concealed electrical wiring/plumbing.

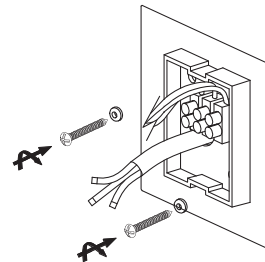

**5** Push the power supply through the cable gland. Affix the rear base to the mounting surface with mounting wall screws supplied. To maintain the IP rating, a round 3 core 0.75mm<sup>2</sup> (min) cable should be used.

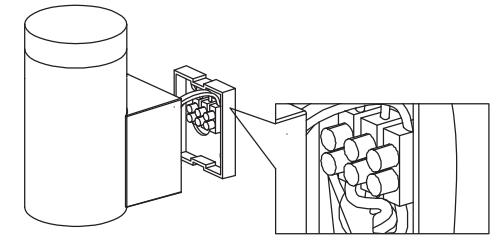

**6** Connect the power cables to the terminal block securely using the wiring diagram in Step 7.

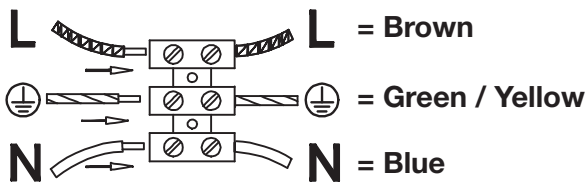

**7** Terminate the power supply cable.

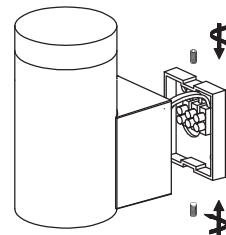

**8** Reattach and screw securely the cover to the base. Ensure cables are not pinched when closing the unit.

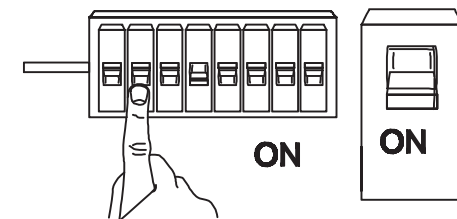

**9** Reconnect mains power and test circuit.