

# MultiLayer

Our Multilayer range is designed to allow multiple linings of plasterboard and achieve greater wall strength and acoustic ratings. This system is the preferred option when you need a thicker wall, or want a different look for your next fitout. With profile widths ranging from 116mm to 158mm, there is an option for almost any lining selection.

- Suited to both 64mm and 92mm stud walls
- Integrates with both 64 Series and 92 Series
- Multiple linings to suit any application
- Built in screw ports and staking bracket locators

**Standard Suite Profiles** - Suitable for: 64 & 92mm Steel Stud, Multiple Layers 13mm Plasterboard

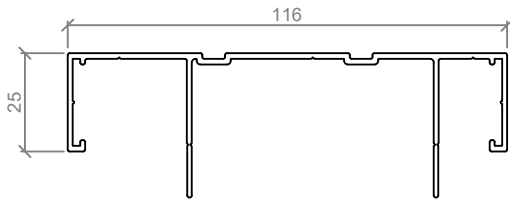

ASL 408  
116mm REBATED HEADSECTION

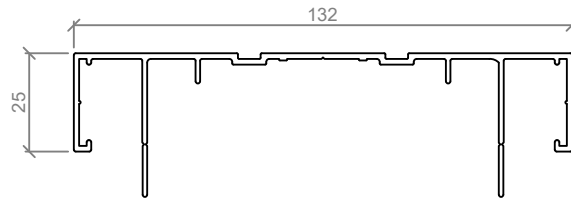

ASL 420  
132mm GROOVED HEADSECTION

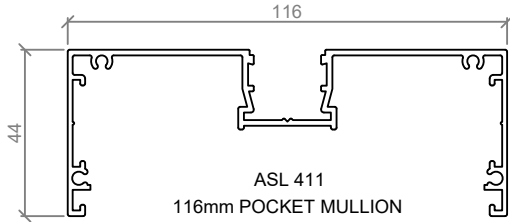

ASL 411  
116mm POCKET MULLION

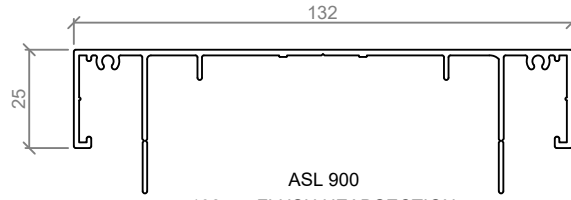

ASL 900  
132mm FLUSH HEADSECTION

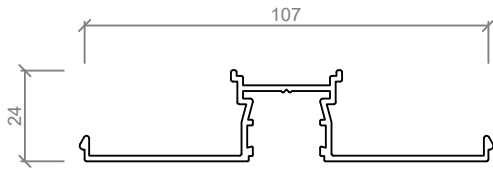

ASL 412  
POCKET STARTER CAP

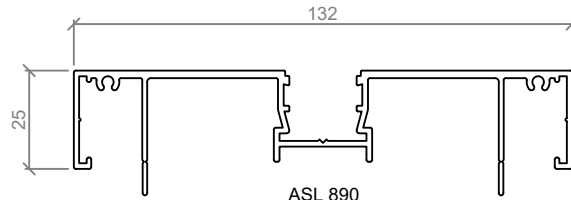

ASL 890  
132mm POCKET HEADSECTION

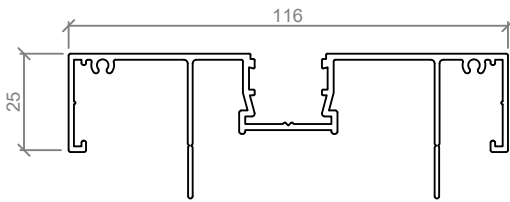

ASL 413  
116mm POCKET HEADSECTION

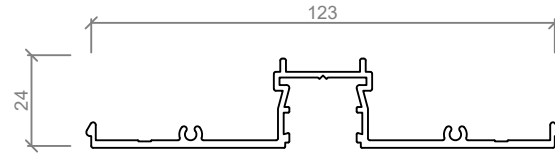

ASL 892  
POCKET STARTER CAP

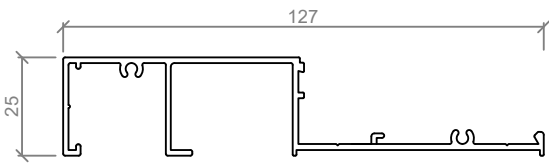

ASL 931  
145mm GLAZING BAR

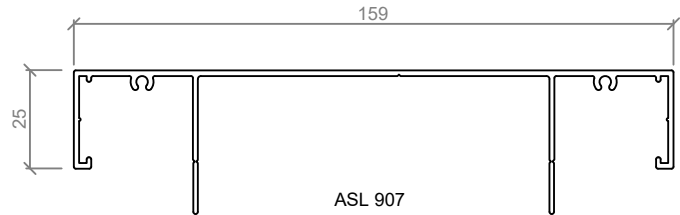

ASL 907  
159mm FLUSH HEADSECTION

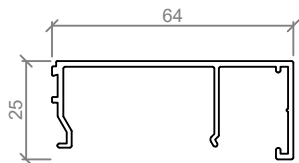

ASL 932  
145mm GLAZING BEAD

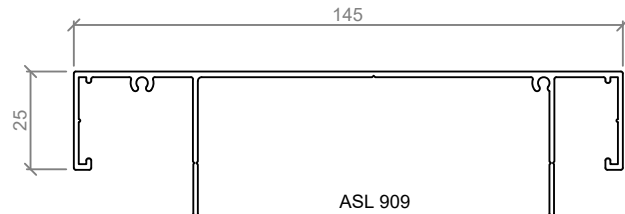

ASL 909  
145mm FLUSH HEADSECTION

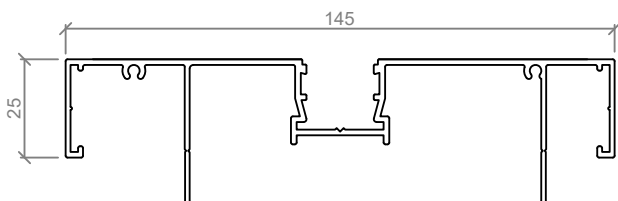

ASL 930  
145mm POCKET HEADSECTION

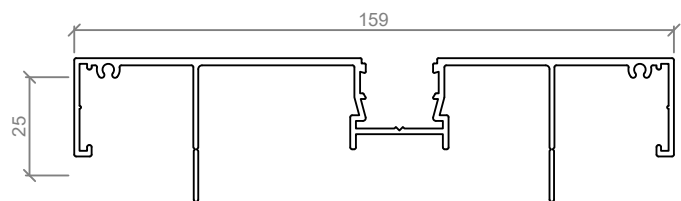

ASL 940  
159mm OFFSET POCKET HEADSECTION

**Standard Suite & Negative Detail Profiles** - Suitable for: 64 & 92mm Steel Stud, Multiple Layers  
13mm Plasterboard

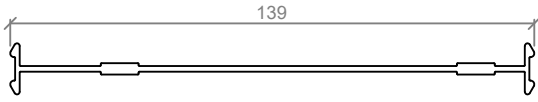

ASL 933  
MULTILAYER JOINER PLATE

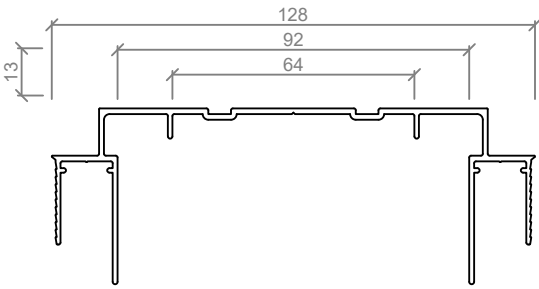

ASL 741  
REBATED HEADSECTION (13mm NEG. DETAIL)

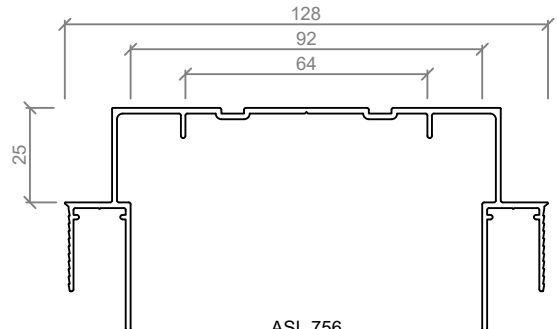

ASL 756  
REBATED HEADSECTION (25mm NEG. DETAIL)

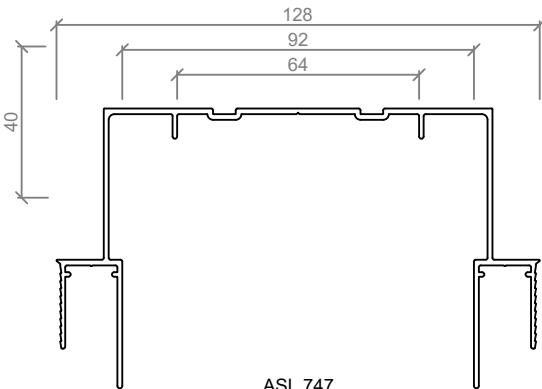

ASL 747  
REBATED HEADSECTION (40mm NEG. DETAIL)

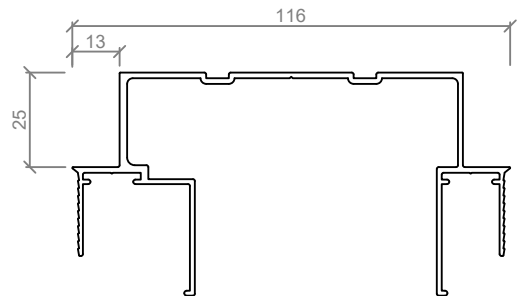

ASL 758  
REBATED HEADSECTION (25mm NEG. DETAIL)

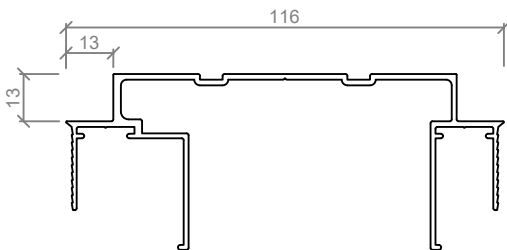

ASL 757  
REBATED HEADSECTION (13mm NEG. DETAIL)

## Standard Elevation

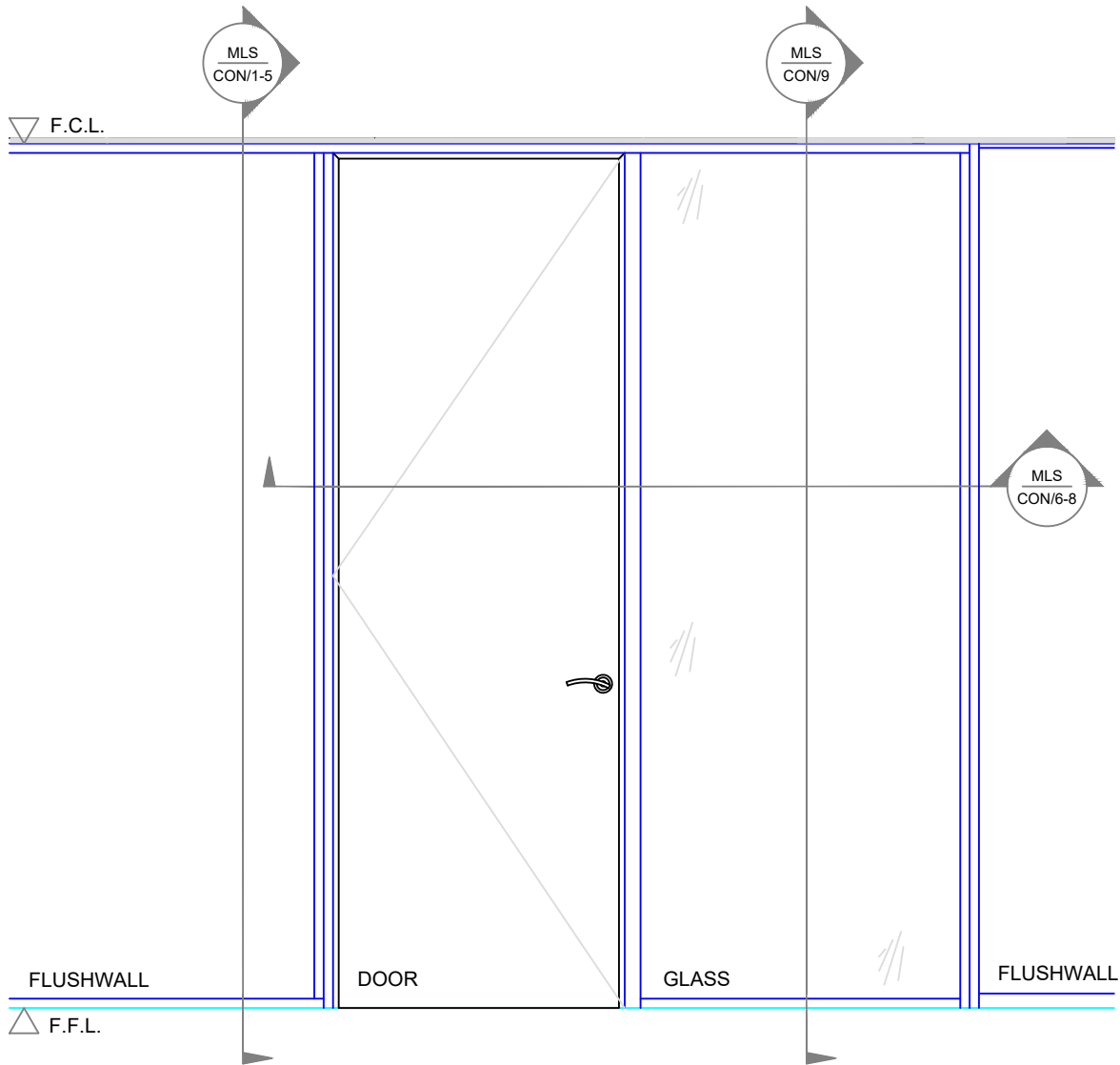

**Standard Details** - Suitable for: 64mm Steel Stud, Three Layers 13mm Plasterboard

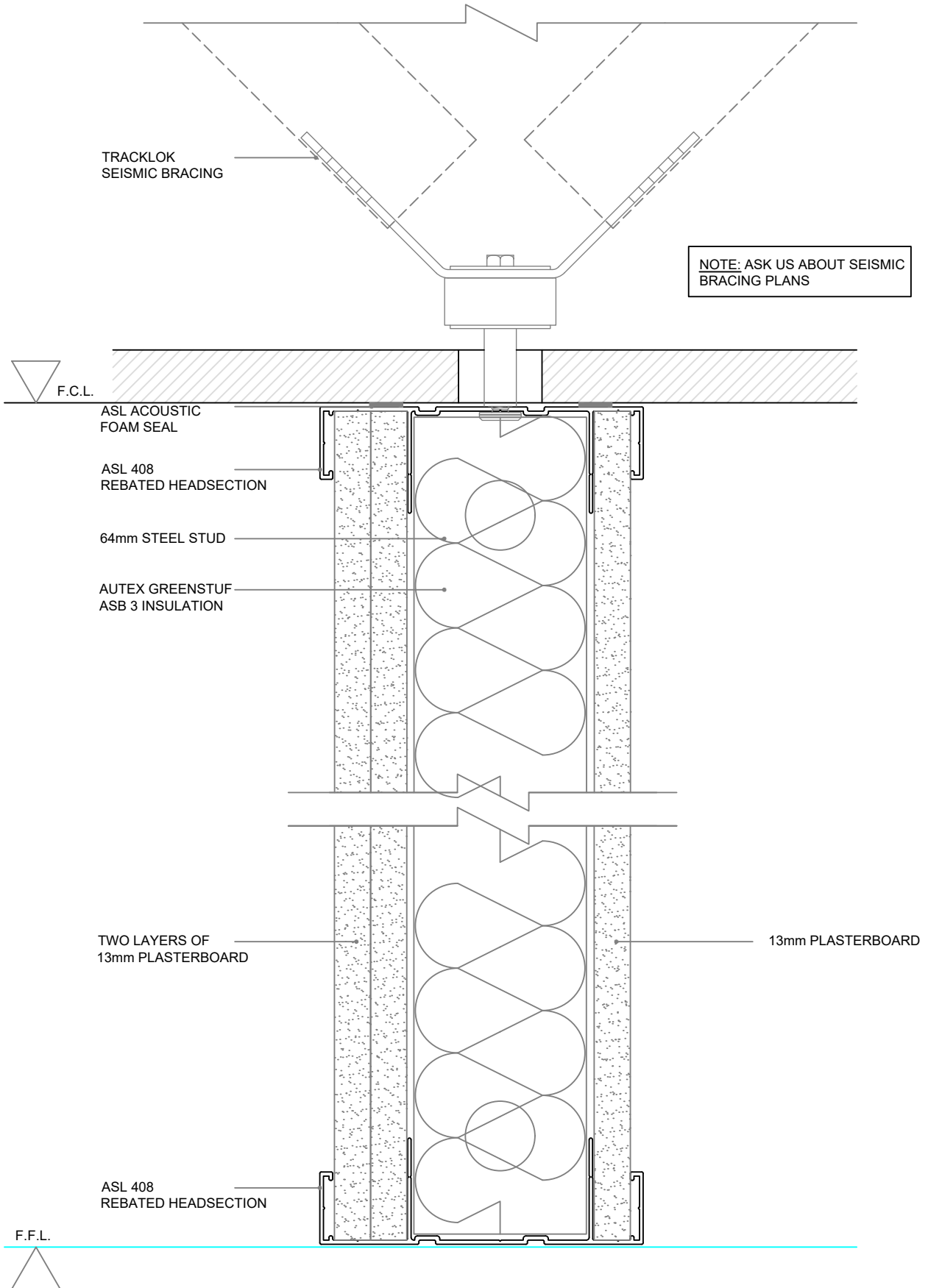

**Negative Detail** - Suitable for: 64mm Steel Stud, Three Layers 13mm Plasterboard

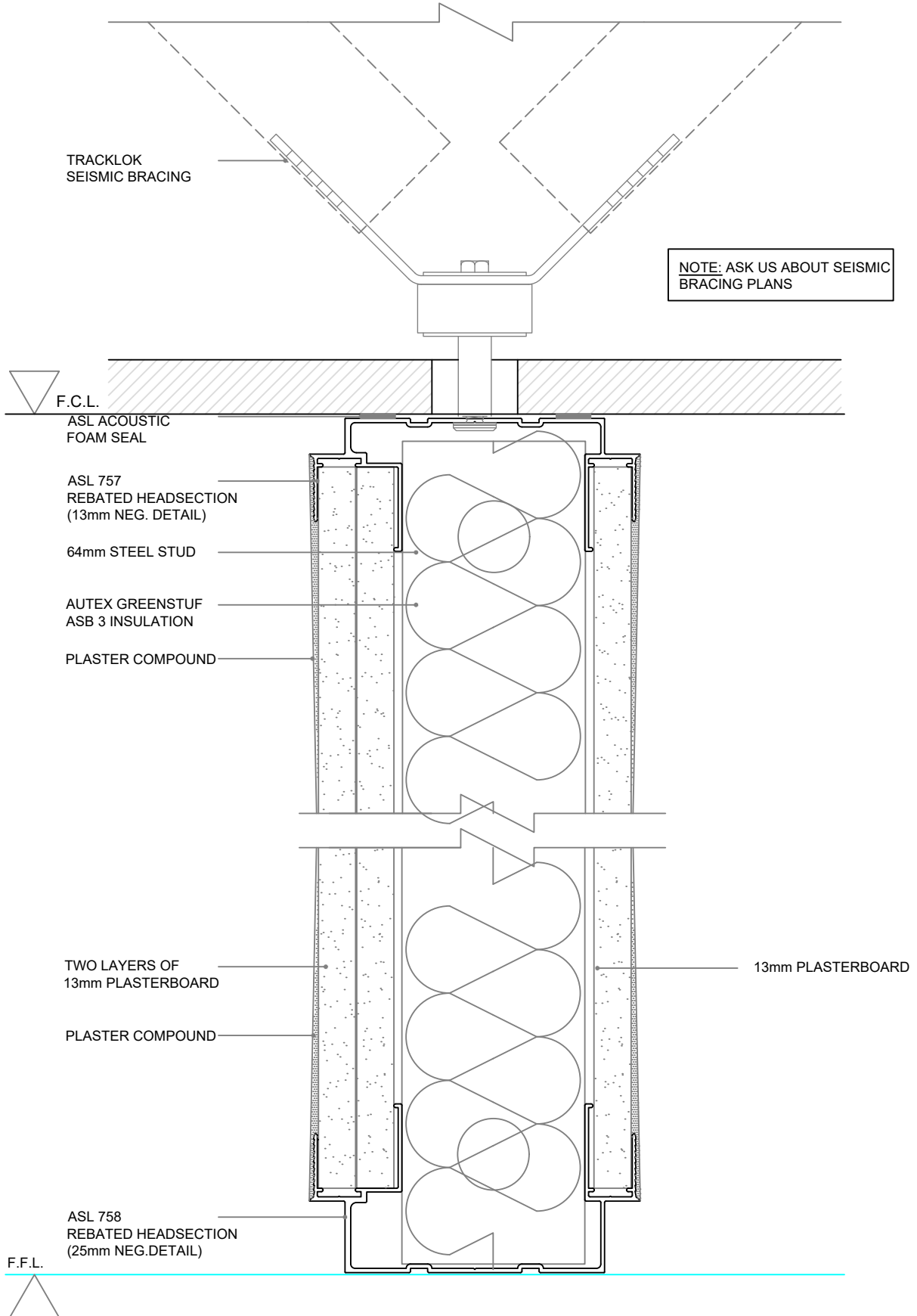

**Standard Details - 92mm Steel Stud, Four Layers 13mm Plasterboard**

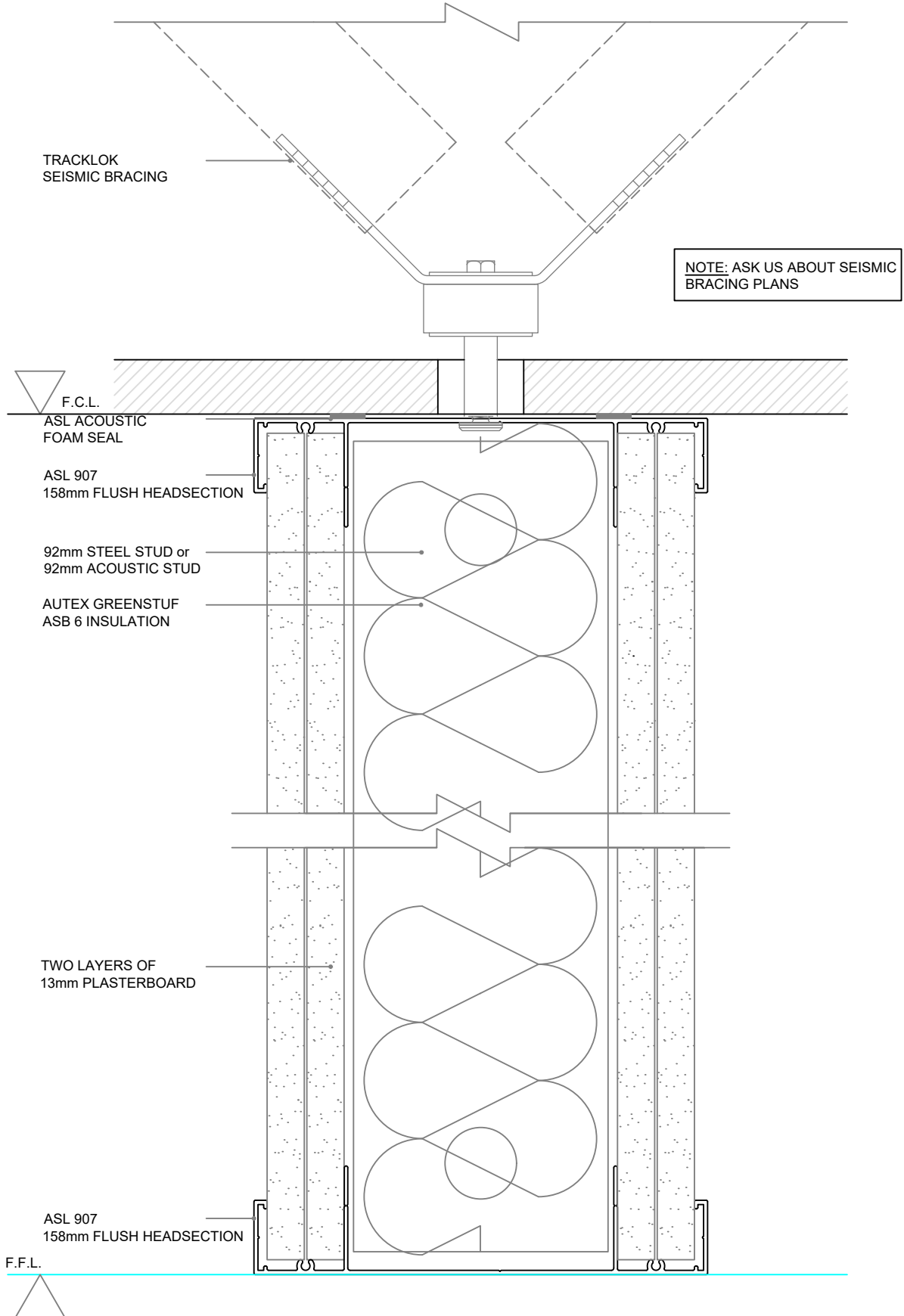

**Standard Details - 64mm Steel Stud, Four Layers 13mm Plasterboard**

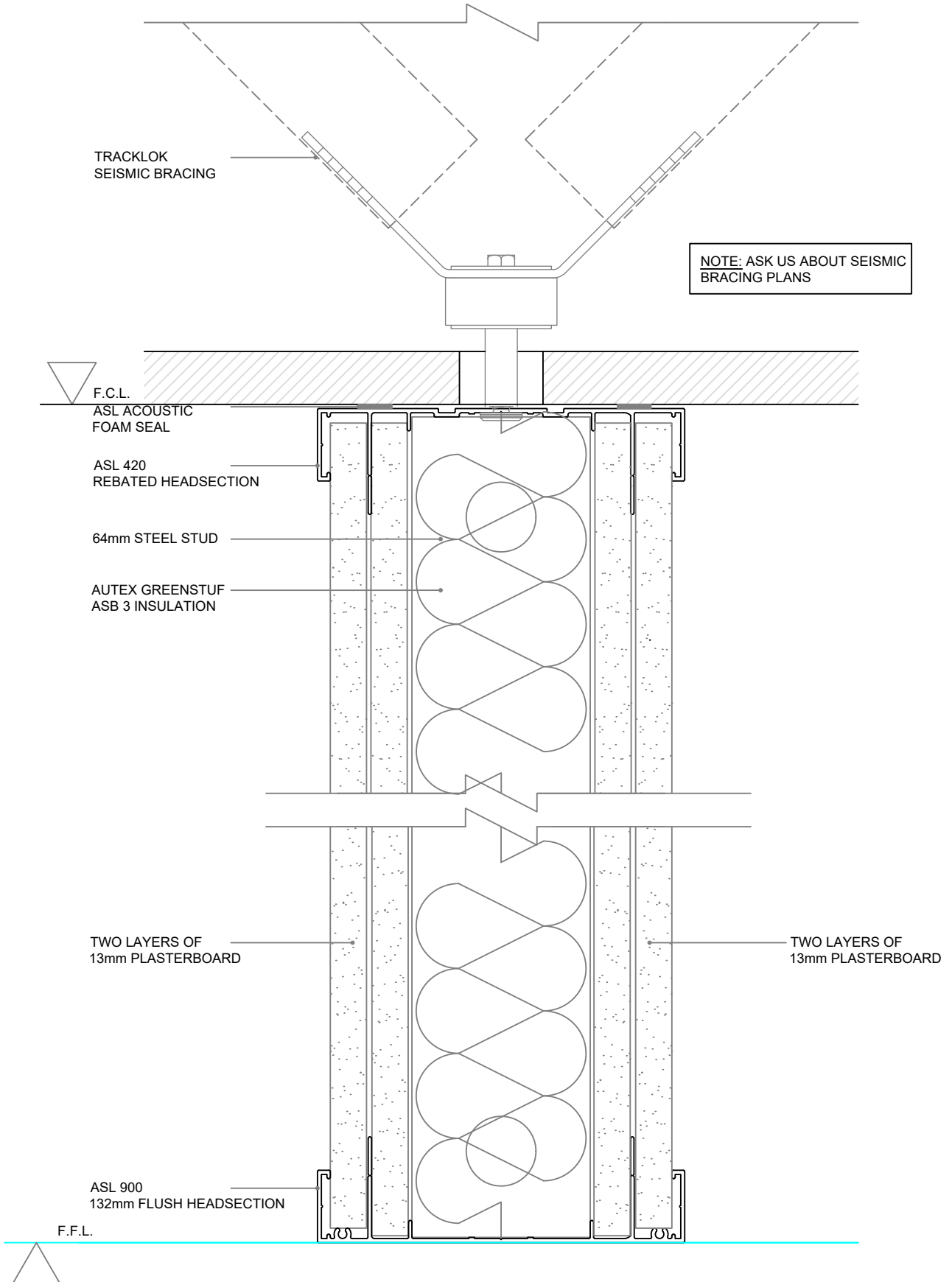



**Standard Details - 92mm Steel Stud, Three Layers 13mm Plasterboard**

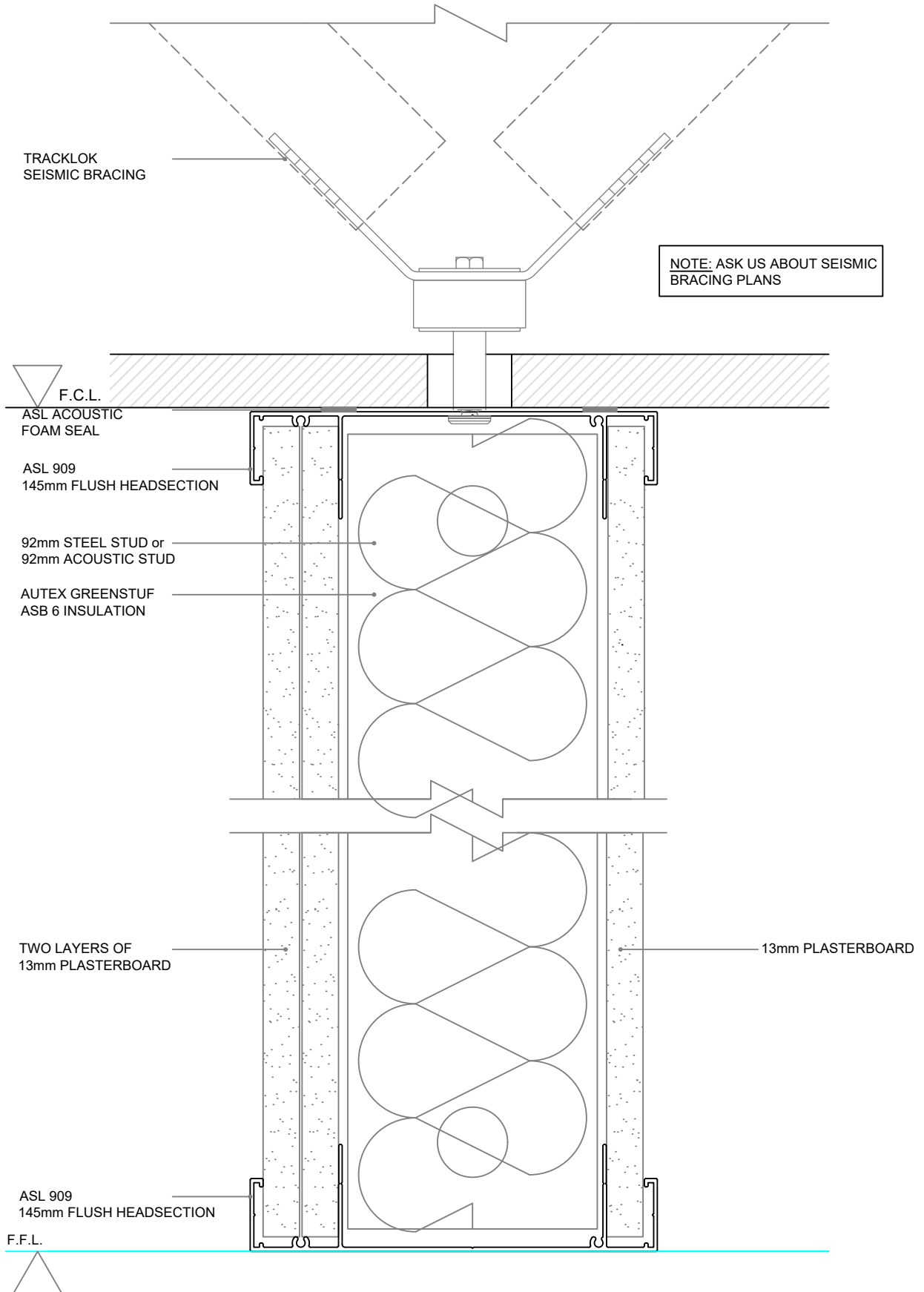

**Standard Details - 64mm Steel Stud, Three Layers 13mm Plasterboard, Glazed Panel**

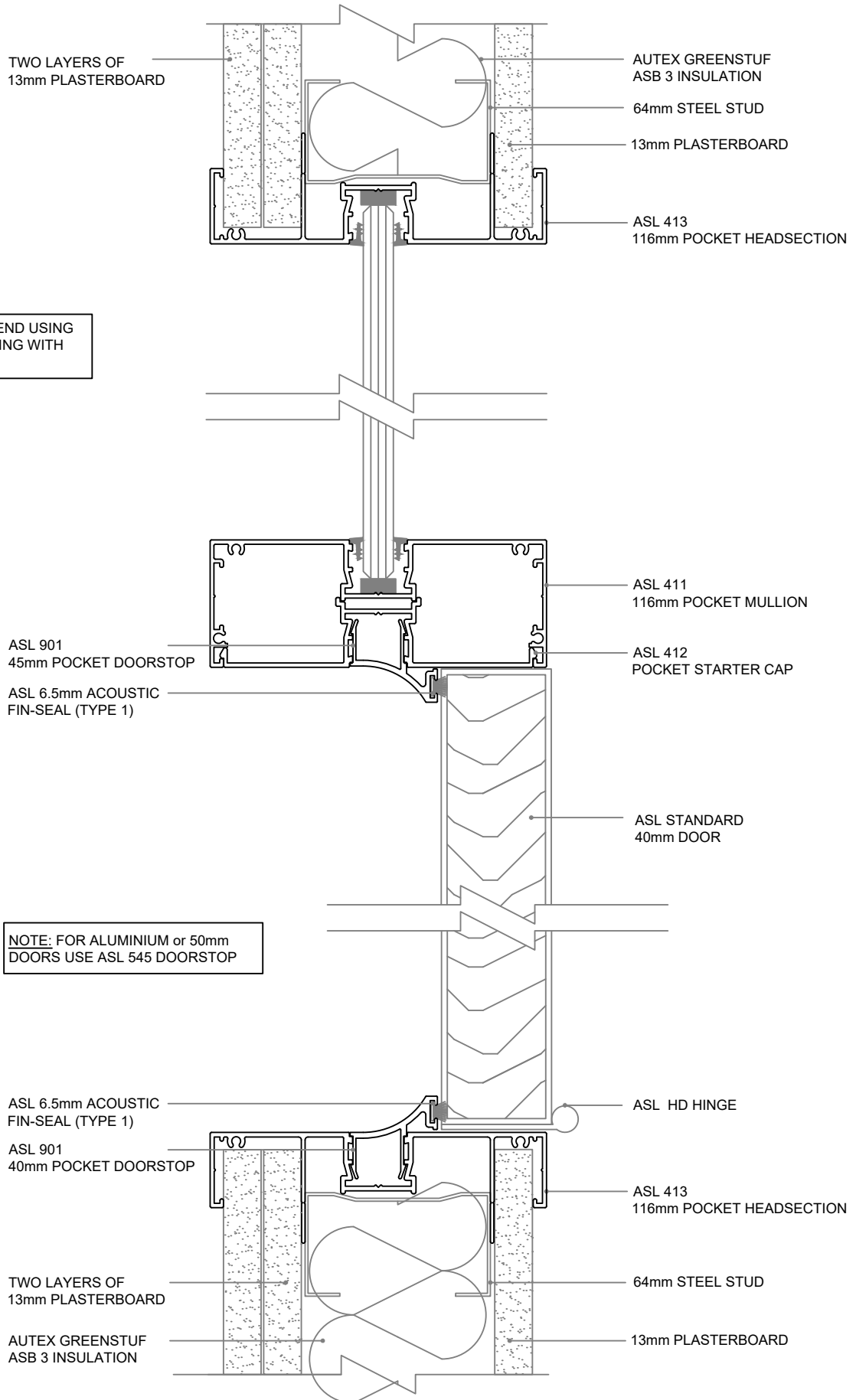

**Standard Details - 64mm Steel Stud, Three Layers 13mm Plasterboard, Glazed Panel**

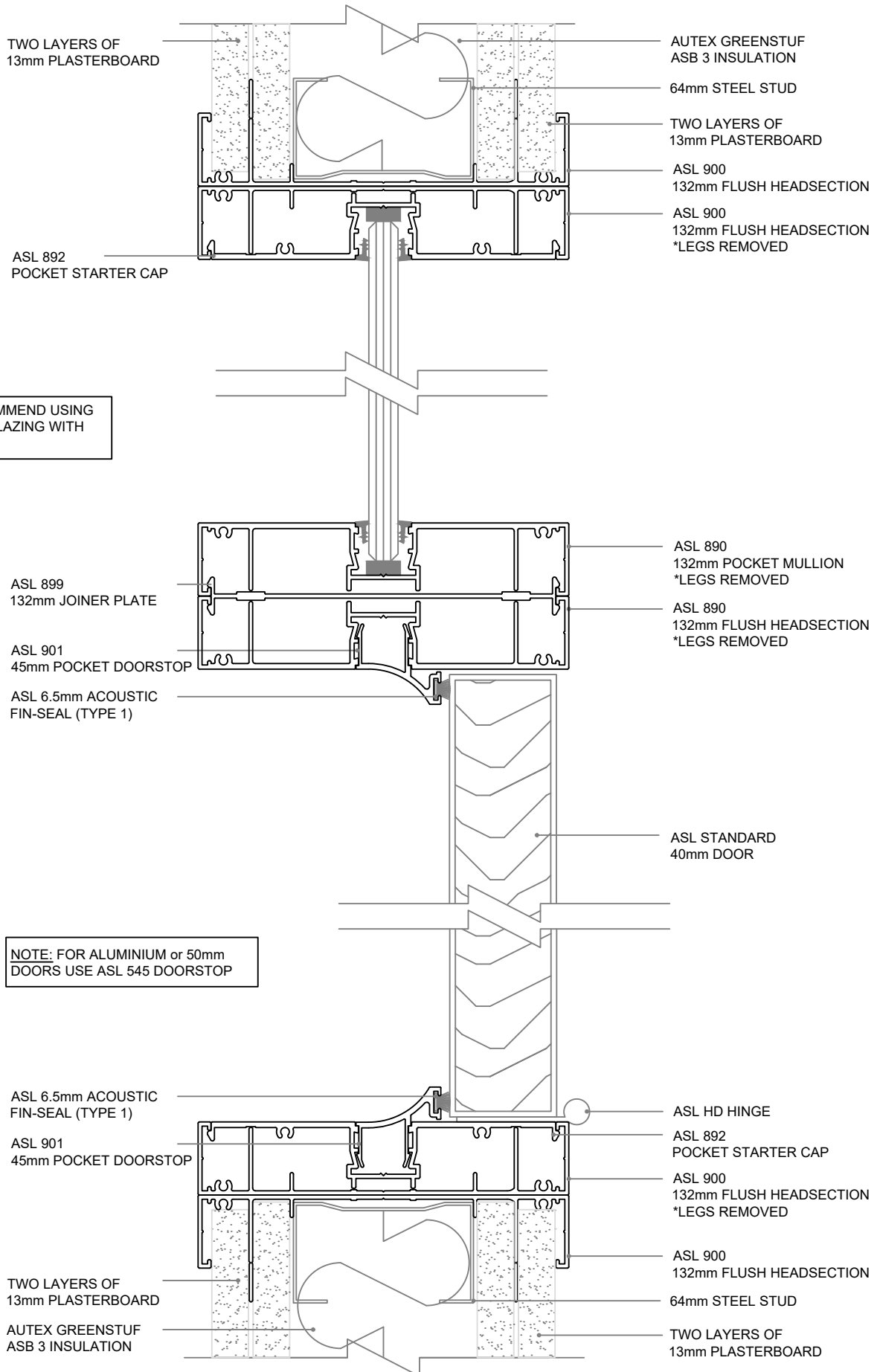

NOTE: RECOMMEND USING ACOUSTIC GLAZING WITH MULTILAYER

NOTE: FOR ALUMINIUM or 50mm DOORS USE ASL 545 DOORSTOP

**Standard Details - 92mm Steel Stud, Three Layers 13mm Plasterboard, Glazed Panel**

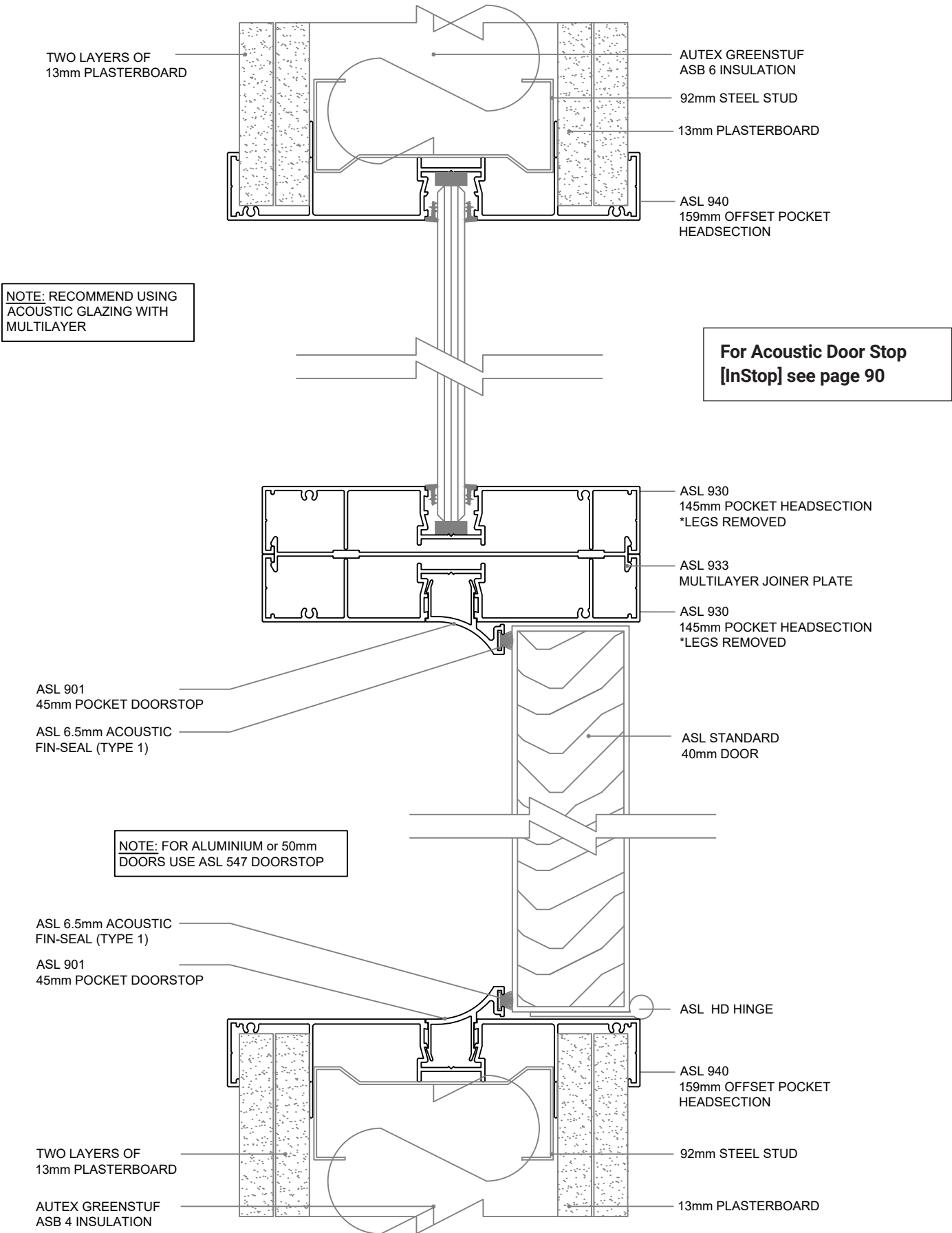

Standard Details - Glazing

