

PROFIX PXF CLADDING SYSTEM

Profix PXF screw fixed flat panel façade system is a 35mm timber cavity batten system specifically designed for use with Trespa® Meteon® panels.

Profix PXF is a tested, compliant cladding solution that offers a fast and cost-effective installation method for Trespa® Meteon® panels. Fixed with colour matched screws with a vertical set out, **Profix PXF** provides a traditional value for money solution that allows for the creation of visual and aesthetic effects when combined with Trespa® Meteon®. The use of structural timber battens fixed to horizontal framing also provides an economical solution for straightening existing structures.

Profix PXF is ideally suited for multi-level applications up to 10m high. The Trespa panels are configured vertically with a 10mm expressed vertical joint.

The full range of Trespa colours and finishes are available allowing for creative use of panel width and colours to enhance even the simplest design.

Profix PXF and Trespa® Meteon® panel make it easy to create stunning, low maintenance facades while ensuring simple installations in a timely manner.

Scope: Where to use Profix PXF

- Suitable for use as a residential or commercial cladding façade up to 3 levels of 10m or less and within the scope of NZBC E2/AS1: 2011 and NZS 3604: 2011 or later current versions.
- Fixed over a Rigid Air Barrier compliant with E2/AS1: 1 August 2011
- Approved for use in wind zones up to 2.5 kPa ULS wind pressure or 64.5 m/s with reference to AS/NZS 4284
- For wind zones exceeding 2.5kPa wind pressure the system and fixings must be specified as site specific by the system suppliers
- Suitable for use in all environments including sea spray and geothermal zones
- Suitable for use as a single level cavity system up to a maximum of 4.6m high with a horizontal cavity break at each mid floor level
- Suitable for use with 8.0mm or 10mm Trespa® Meteon® panels screw fixed vertically with maximum panel sizes of 3.0m x 1.5m or 2.5m x 1.8m
- The use of 6.0mm Trespa and or panel sizes exceeding those above must be specified as site specific and approved by the system suppliers

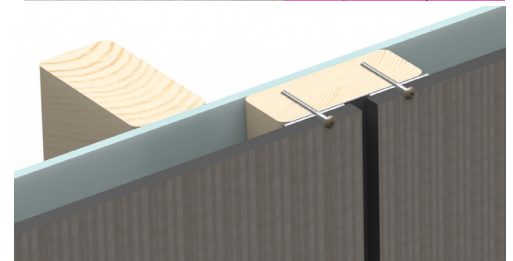

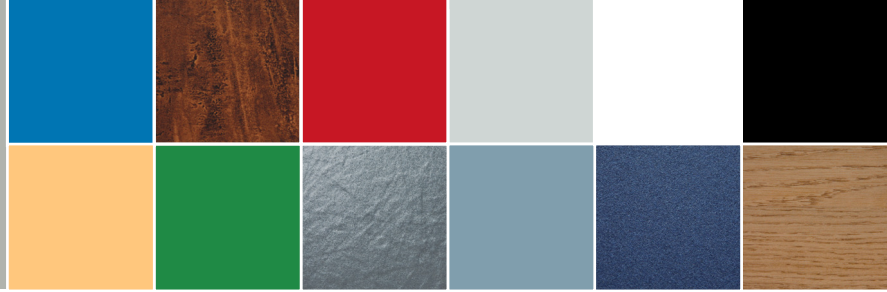

Benefits: Why use Profix PXF

- Warranted system that is tested and compliant with the requirements of NZBC sections B1 Structure, B2 Durability and E2 External Moisture
- Trespa is an High Pressure Laminate (HPL) panel with proven in use durability and colour fastness and offers an extensive colour range
- Trespa is a prefinished panel that is graffiti resistant and offers exceptional impact resistance
- The **Profix PXF** system is durable, lightweight and can span between fixings allowing the batten to be packed straight and true
- Uses durable materials requiring minimal maintenance that offer reduced through life costs
- Exposed SS Wafer Head screw fixings are colour matched to the Trespa panel
- Exposed and visual flashings are powder coated for added durability and aesthetic value
- Suitable for use as a cladding solution on new builds or cladding upgrades
- An easily installed system requiring only a clean down on completion of install
- Visible (exposed) fixing with screws offer different execution possibilities with larger panel options and variable panel widths

Compliance: Within the New Zealand Market Place

- Tested and compliant with AS/NZS 4284:2008 Fletcher Aluminium Laboratory Test Report No. T487
- Tested and compliant with NZBC E2/VM1: 2011 Fletcher Aluminium Laboratory Test Report No. T488
- Les Boulton Durability Appraisal Report No. 141102
- Chris W Howell & Associates - PS1 Design - Producer Statement 14438
- Trespa Grey Scale Rating (Florida cycle) of 4-5
- Trespa® Meteon® Product Guarantee