

multiplast[®]

Specification

Monotek Jointing and Coating System

Refer to **BRANZ Appraisal Number 530** (2006)

System Guarantee Period

15 years from date of practical completion of jointing
7 years from date of practical completion of coating

Workmanship Guarantee Period

5 years from date of practical completion

System Construction

- Monotek
- 150gsm alkali resistant fibreglass mesh tape embedded in Multiplast Jointing Plaster
- 150gsm alkali resistant fibreglass mesh embedded in Multiplast meshing plaster
- 1st coat levelling coat (optional)
- 2nd coat selected texture coat
- 1st coat Insulcote 100% acrylic paint system (in specified colour)
- 2nd coat Insulcote 100% acrylic paint system (in specified colour)

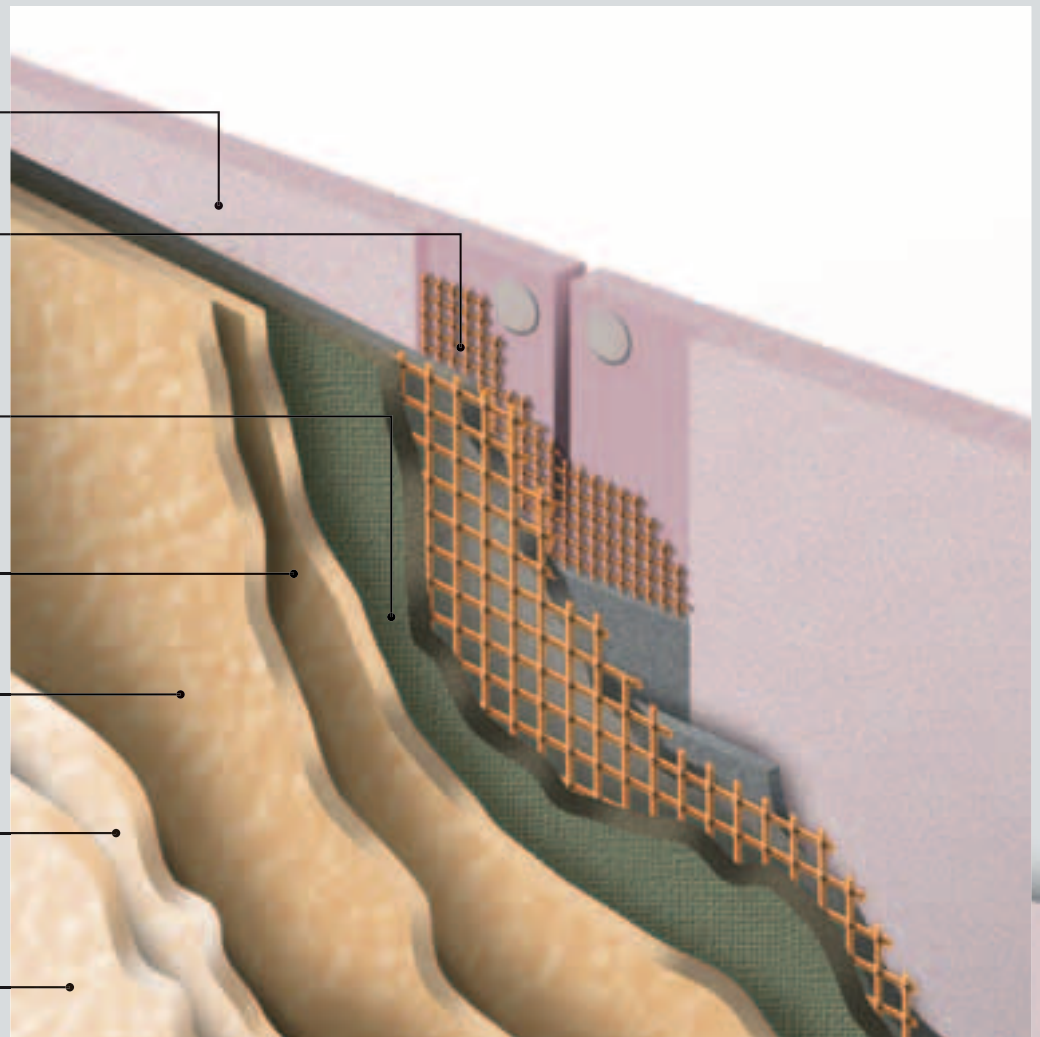

What is Multiplast?

Multiplast is a fibre cement sheet jointing and coating system specifically designed for Monotek cladding. It provides a very strong double meshed joint and thick flat plastered walls with an attractive durable textured finish.

Advantages

- Straight clean lines are formed which give a monolithic appearance.
- Easy to keep clean and weatherproof using insulcote paint.
- A wide range of textures can be achieved.
- Reduced incidence of cracking when using doubled Mesh reinforcement on joints (exception being extreme movement of the substrate).

Application

Substrate

Monotek must be installed in conformance with James Hardie New Zealand Limited current specification. Sheets must be clean and dry.

Preparation

All substrates must be clean dry and free from dust laitance moss or mould.

A coat of Multiplast resin diluted 1 : 1 with water must be rolled on over all sheet surfaces to reduce suction when plastering.

Jointing

150gsm Quickmesh alkali resistant fiberglass jointing tape is embedded in the joints using Multiplast Jointing Plaster, mixed using 1 litre of Multiplast resin per bag of plaster and approximately 6 litres of water. Joints which are not rebated should be ground out then resealed using Multiplast resin diluted. Corners should be plastered using premeshed corner mouldings.

Meshing

The Mesh coat is applied to the entire wall after the jointing has cured. The wall is covered with an approximately 2mm thick layer of Multiplast Meshing Plaster and the 150gsm Quickmesh embedded into it. The mesh drops are butt joined as long as the joints are no closer than 200mm from a sheet joint running in the same direction. It is permissible for a mesh joint to cross a sheet joint at a 90 degree angle. If closer than 200mm to a sheet joint running parallel then the mesh joint should be overlapped by 40mm minimum.

Texturing

The desired texture from the Plaster Systems Ltd range can now be applied. The available options are Ezytex or Adobeplast which are painted over with two coats of Insulcote paint.

Painting

Paint in accordance with the chosen texture specification. Insulcote paint is recommended.

Accessories

PVC corner beads, plain or premeshed, should be used to form straight corners by pushing them into the wet plaster with a straight edge.

Hardcote pretextured mouldings can be used to provide sills, bands or other decorative features to the building.

Special Notes

It is the responsibility of the specifier, designer or builder to provide and install adequate details in line with the James Hardie New Zealand Limited's specifications. The Plaster Systems Specification and Warranty is limited to the jointing and coating system only.

Movement control joints must not be plastered over as they will crack. The sealant line should be brought out flush with the finished texture level.