

1 SPOT FOOTING ATTACHED TO DWELLING
SCALE 1:20

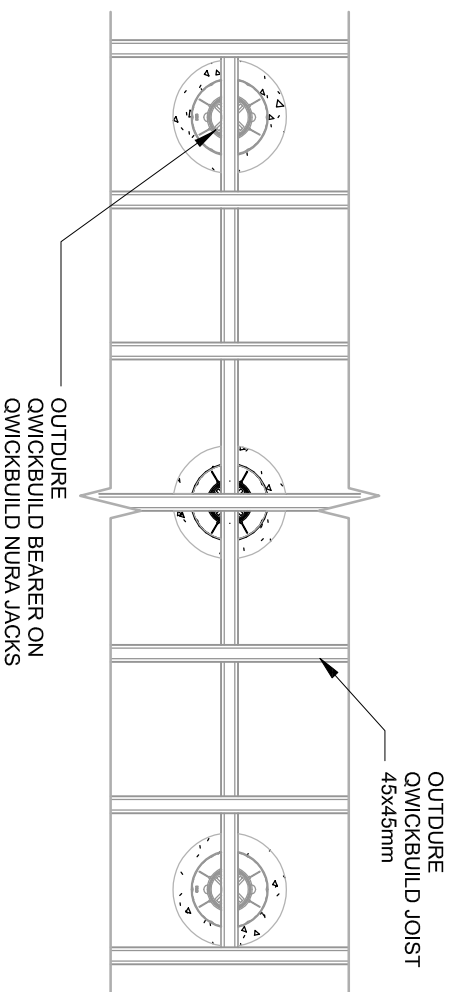

2 SPOT FOOTING MID SPAN
SCALE 1:20

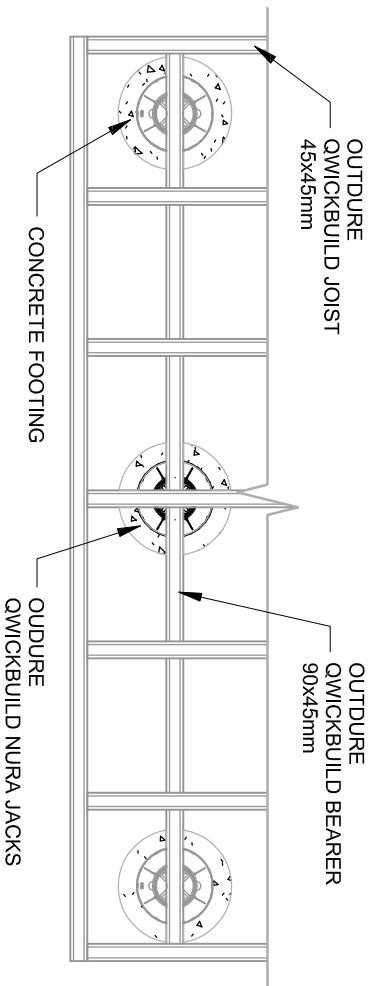

3 SPOT FOOTING ALONG EDGE OF DECK
SCALE 1:20

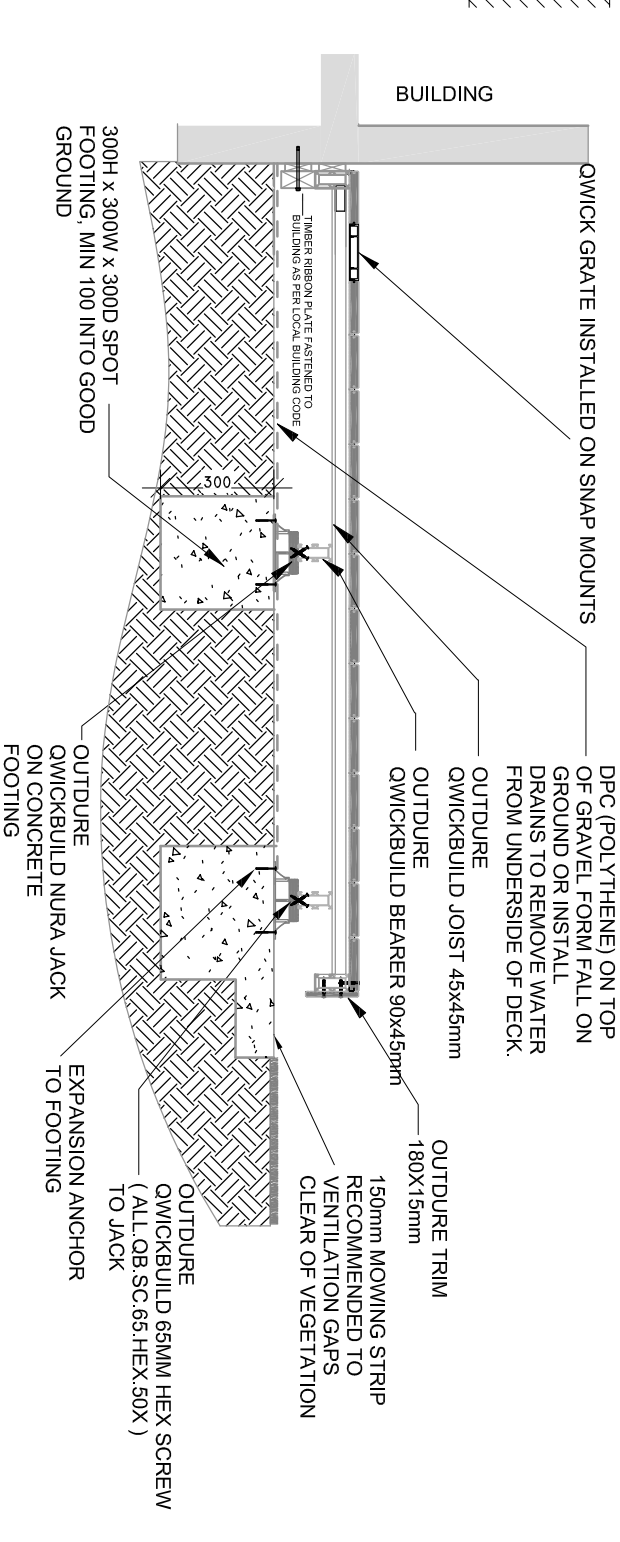

4 RIBBON PLATE ATTACHED TO DWELLING ELEVATION
SCALE 1:20

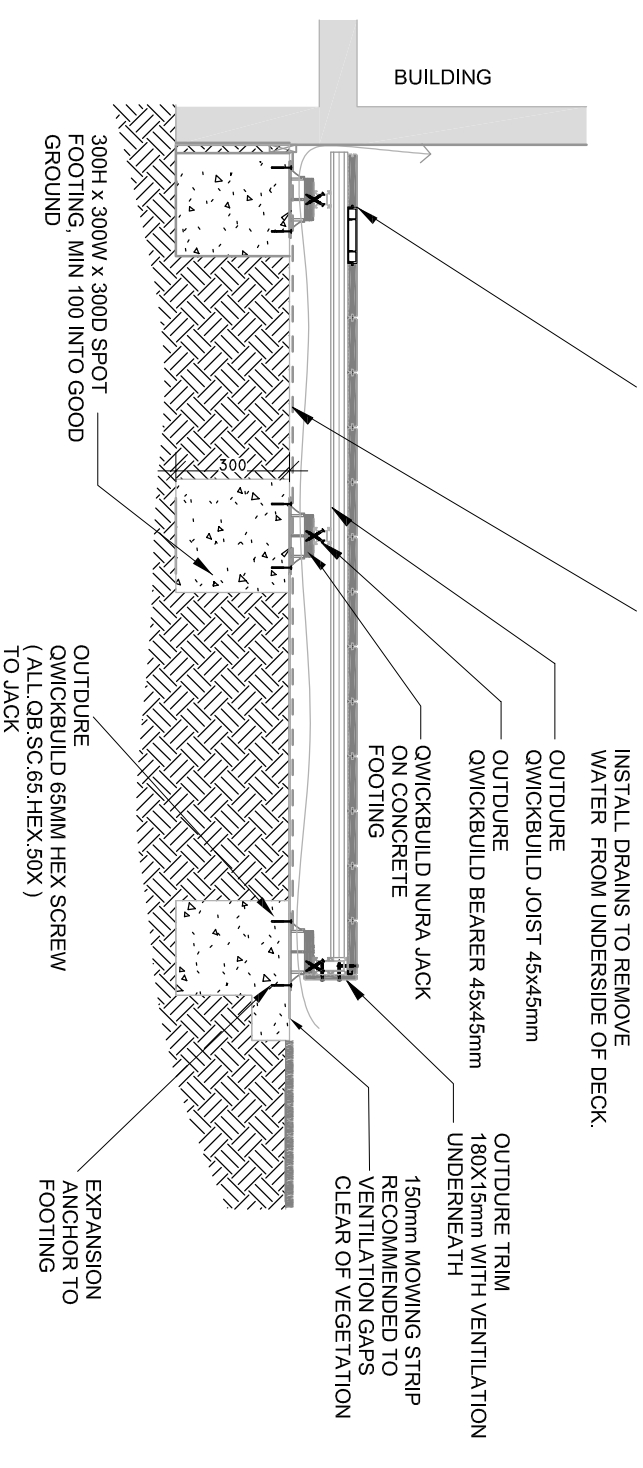

5 MID SPAN FOOTING ELEVATION
SCALE 1:20

IMPORTANT NOTE: ENSURE ADEQUATE VENTILATION GAPS TO PERIMETER AND TOP OF DECK (GRATES, VENTS, GAPS IN TRIM)

OUTDURE DECKING ON SPOT FOOTING
SURFACES: OUTDURE DECKING DECK FRAME: QWICKBUILD

SCALE: 1:20
DATE: 31/05/2018
DWG #: QB-SF-01

NEW ZEALAND: 0800 77 88 77
AUSTRALIA: 1800 722 465
www.outdure.com

The use of this document is subject to the following terms and conditions: All Outdure (hereinafter "designer") designs are based upon the project scope that has been provided by the Purchaser. User or the user's contractor. Please ensure that you are referring to the most recent version of the design drawings. Dimensions should not be varied on site prior to construction. Any discrepancies found in this drawing or any other related documents are to be reported to the designer prior to construction. Users of this document shall rely solely on the professional judgment and skill of installers in determining the appropriateness of using or referring to this document and to satisfy themselves as the accuracy of the data it contains. All construction must be in accordance with or Outdure's installation guidelines, or local building code, national standards, statutory regulations, local authority requirements which take precedence over any details in this document. Note that when creating any structure over any waterproof membrane system, it is the sole responsibility of the installer to ensure the membrane manufacturer's warranty remains valid. This drawing is the sole property of Outdure and must not be copied, reproduced, retained or disclosed to any unauthorized party, wholly or in part without permission of Outdure. Users acknowledge that Outdure is not liable in any respect of any particular use or application of the material provided. If in doubt about any details, please contact Outdure for further clarification www.outdure.com/contact

