

BGC

Fibre Cement

Note 1:
BGC Duragroove™ panel vertical joint must be formed on timber batten fixed over the stud.

Note 2:
If timber studs are placed @ 400 c/c, no intermediate battens are required,

Horizontal Cavity packers, 20x45x150mm long H3.1, one central nail set to 5° fall. Keep packers 50mm clear of vertical battens.

BGC Horizontal 'H' mould.

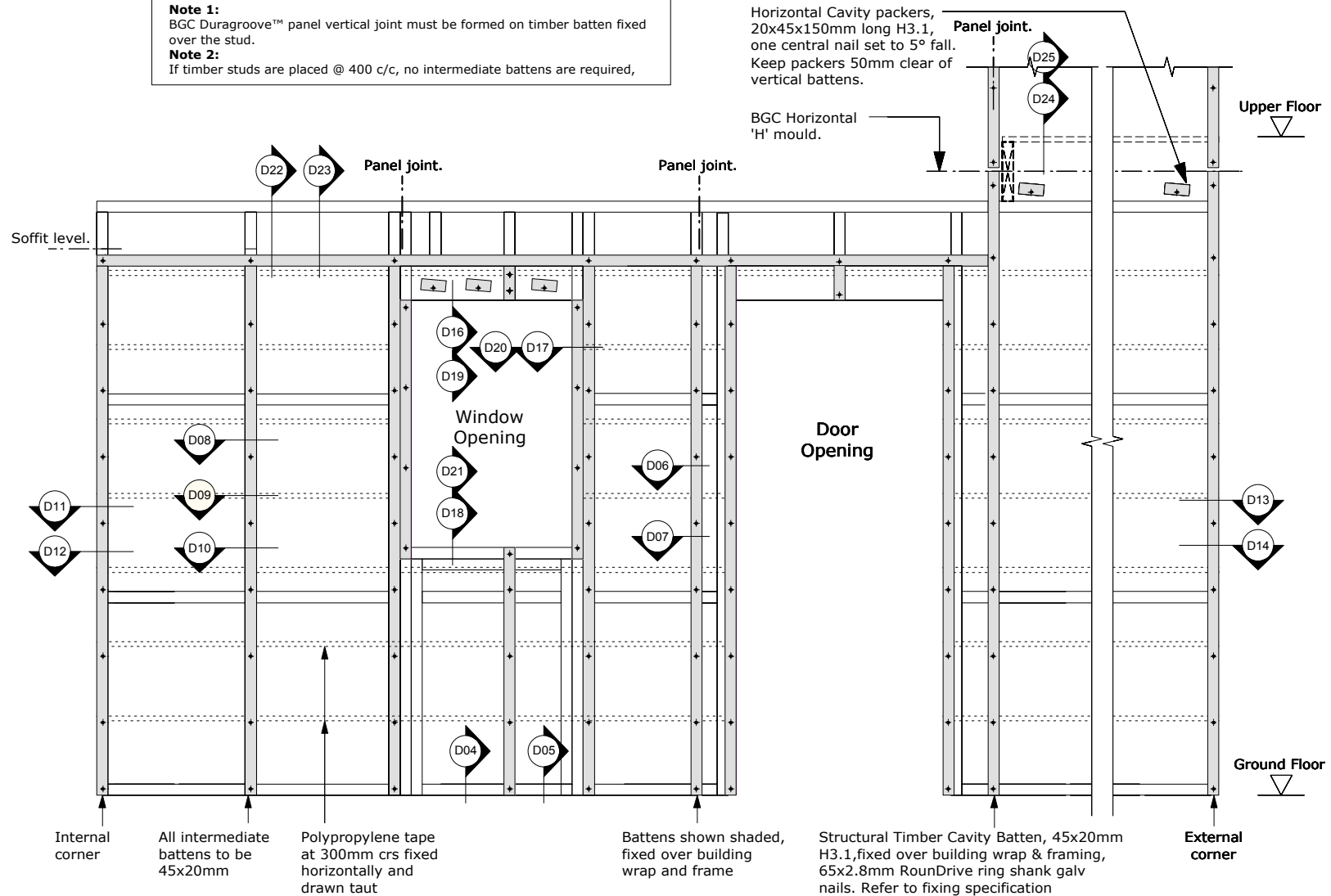

PROFILE BGC Duragroove™

DETAIL Framing Setout

DATE Nov 2011
SCALE 1:25 @ A4

DETAIL NO. D00